

LOCUS PLAN
1" = 2,000 FT. +/-

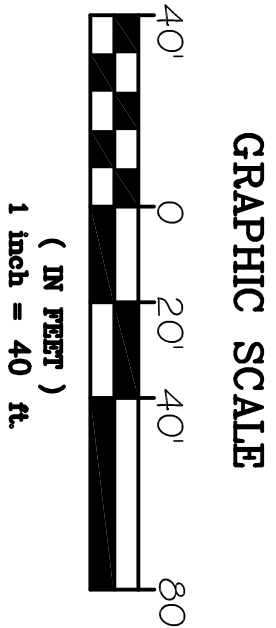

- EXISTING CONTOURS:
PROPOSED CONTOURS:
LIMIT OF BUFFER ZONE:
LIMIT OF FEMA FLOOD ZONES:
MEAN HIGH WATER:
MEAN LOW WATER:

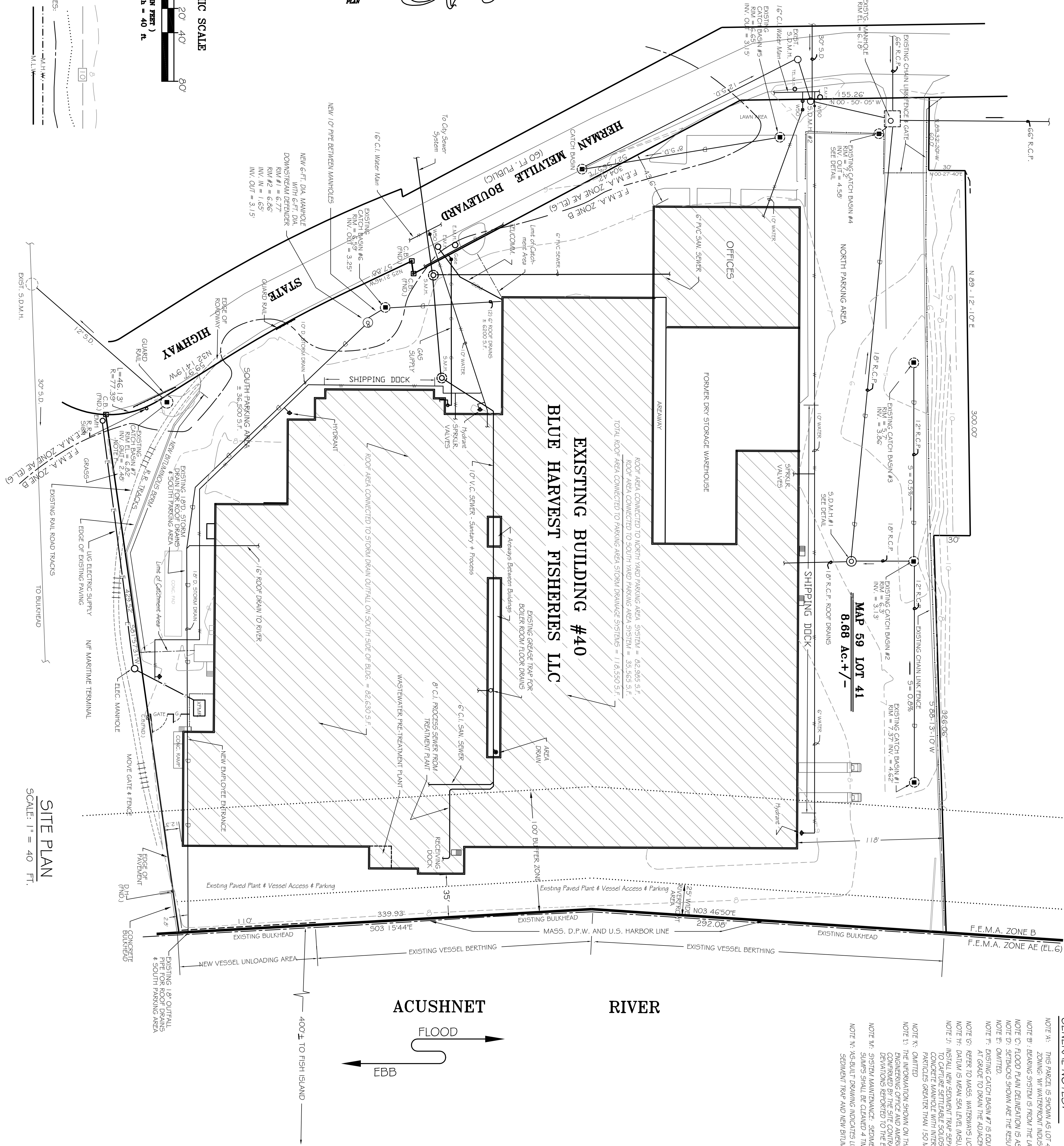

GENERAL NOTES:

- NOTE A: THIS PARCEL IS SHOWN AS LOT 41 OF ASSESSORS MAP 59.
ZONING: W1 WATERFRONT INDUSTRIAL.
NOTE B: BEARING SYSTEM IS FROM THE LAYOUT PLANS OF HERMAN MELVILLE BLVD.
NOTE C: FLOOD PLAIN DELINEATION IS AS SHOWN ON F.E.M.A. COMMUNITY PANEL 25005C03936, DATED JULY 16, 2014.
NOTE D: SETBACKS SHOWN ARE THE RESULT OF TAPED AND INSTRUMENT-ASSIGNED MEASUREMENTS IN THE FIELD.
NOTE E: OMITTED.
NOTE F: EXISTING CATCH BASIN #7 IS EQUIPPED WITH HINGED HOODED OUTLET FOR CONTAINMENT OF GAS & OIL, AND OPEN GRATE AT GRADE TO DRAIN THE ADJACENT GRASSY AREA.
NOTE G: REFER TO MASS. WATERWAYS LICENSE PLANS NO. 2203 & 2295 FOR SEAWALL & BULKHEAD LINE PERMITTING.
NOTE H: DATUM IS MEAN SEA LEVEL (MSL).
NOTE I: INSTALL SEDIMENT TRAP TO BE 72" PLASTER DOWNSTREAM DEFENDER UNIT MANUFACTURED BY HED LTD. CONCRETE MANHOLE WITH INTERNAL COMPONENTS TO PROVIDE VORTEX SEPARATION. DESIGN CRITERIA IS 90% REMOVAL OF PARTICLES GREATER THAN 150 MICRONS WITH SPECIFIC GRAVITY OF 2.65 AT DESIGN CAPACITY OF 3,590 GPM.
NOTE J: THE INFORMATION SHOWN ON THIS PLAN IS THE RESULT OF FIELD OBSERVATIONS AND DATA COMPARED FROM THE A.B. D.P.W. ENGINEERING OFFICE AND AMERICAN SEAFOODS INTERNATIONAL LLC AND PREDECESSOR OWNERS. ALL DATA SHALL BE CONFIRMED BY THE SITE CONTRACTOR PRIOR TO INSTALLATION OF NEW STORM DRAINAGE IMPROVEMENTS AND ANY DEVIATIONS REPORTED TO THE ENGINEER.
NOTE K: SYSTEM MAINTENANCE: SEDIMENT TRAP SHALL BE CLEARED 2 TIMES PER YEAR USING A GUTTY SLICKER TO REMOVE CAPTURED FLOATABLES & SOLIDS. SLUDGES SHALL BE CLEARED 4 TIMES PER YEAR IN CATCH BASIN #1 THRU #7.
NOTE L: AS-BUILT DRAWING INDICATES LIMITS OF PAVED PARKING AREA AND INSTALLED LOCATIONS OF NEW DOWNSTREAM DEFENDER SEDIMENT TRAP AND NEW BUTYLUMOUS BEEM FOR SOUTH PARKING AREA.

	D.E.P. FILE NO. SE 49-311
CAI Clifton Associates, Inc. Consulting Engineers 323 Neck Road - Rochester, MA 02770 Tel: 508-763-8362 Fax: 508-763-9582	SCALE: AS NOTED DATE: JULY 26, 2017 REV. 1: OCT. 25, 2018 - NOTE 'N'
DWG. NO. L-1	