



Massachusetts Department of Environmental Protection
Bureau of Resource Protection - Wetlands

Provided by MassDEP:

WPA Form 3 – Notice of Intent

Massachusetts Wetlands Protection Act M.G.L. c. 131, §40

MassDEP File Number

Document Transaction Number

New Bedford

City/Town

Important:
When filling out forms on the computer, use only the tab key to move your cursor - do not use the return key.



Note:
Before completing this form consult your local Conservation Commission regarding any municipal bylaw or ordinance.

A. General Information

1. Project Location (**Note:** electronic filers will click on button to locate project site):

<u>Rosa Drive</u>	<u>New Bedford</u>	<u>02745</u>
a. Street Address	b. City/Town	c. Zip Code
<u>Latitude and Longitude:</u>	<u>41-43-46</u>	<u>71-56-31</u>
<u>136</u>	d. Latitude	e. Longitude
f. Assessors Map/Plat Number	<u>534</u>	
	g. Parcel /Lot Number	

2. Applicant:

<u>a. First Name</u>	<u>b. Last Name</u>	
<u>D.P.M. Development, Inc.</u>		
<u>c. Organization</u>		
<u>70 Lambeth Street</u>		
<u>d. Street Address</u>		
<u>New Bedford</u>	<u>MA</u>	<u>02745</u>
e. City/Town	f. State	g. Zip Code
<u>508-993-0381</u>	<u>508-995-4342</u>	
h. Phone Number	i. Fax Number	j. Email Address

3. Property owner (required if different from applicant): ☐ Check if more than one owner

<u>a. First Name</u>	<u>b. Last Name</u>	
<u>c. Organization</u>		
<u>d. Street Address</u>		
<u>e. City/Town</u>	<u>f. State</u>	<u>g. Zip Code</u>
<u>h. Phone Number</u>	<u>i. Fax Number</u>	<u>j. Email address</u>

4. Representative (if any):

<u>Jeffrey</u>	<u>Tallman</u>	
a. First Name	b. Last Name	
<u>SITEC, Inc.</u>		
c. Company		
<u>449 Faunce Corner Road</u>		
d. Street Address		
<u>Dartmouth</u>	<u>MA</u>	<u>02747</u>
e. City/Town	f. State	g. Zip Code
<u>508-998-2125</u>	<u>508-998-7554</u>	<u>jtallman@sitec-engineering.com</u>
h. Phone Number	i. Fax Number	j. Email address

5. Total WPA Fee Paid (from NOI Wetland Fee Transmittal Form):

<u>\$500.00</u>	<u>\$237.50</u>	<u>\$267.50</u>
a. Total Fee Paid	b. State Fee Paid	c. City/Town Fee Paid



WPA Form 3 – Notice of Intent

Massachusetts Wetlands Protection Act M.G.L. c. 131, §40

MassDEP File Number

Document Transaction Number

New Bedford

City/Town

A. General Information (continued)

6. General Project Description:

The applicant is proposing to construct a single family dwelling, along with the associated driveway, utilities, and site grading. The majority of the proposed work is in the 100-ft. buffer zone of a bordering vegetated wetland. Erosion control barriers are proposed downgradient of all work.

7a. Project Type Checklist:

- | | |
|---|---|
| 1. <input checked="" type="checkbox"/> Single Family Home | 2. <input type="checkbox"/> Residential Subdivision |
| 3. <input type="checkbox"/> Limited Project Driveway Crossing | 4. <input type="checkbox"/> Commercial/Industrial |
| 5. <input type="checkbox"/> Dock/Pier | 6. <input type="checkbox"/> Utilities |
| 7. <input type="checkbox"/> Coastal Engineering Structure | 8. <input type="checkbox"/> Agriculture (e.g., cranberries, forestry) |
| 9. <input type="checkbox"/> Transportation | 10. <input type="checkbox"/> Other |

7b. Is any portion of the proposed activity eligible to be treated as a limited project subject to 310 CMR 10.24 (coastal) or 310 CMR 10.53 (inland)?

1. ☐ Yes ☒ No If yes, describe which limited project applies to this project:

2. Limited Project

8. Property recorded at the Registry of Deeds for:

Bristol (South)

a. County

10964

c. Book

b. Certificate # (if registered land)

243

d. Page Number

B. Buffer Zone & Resource Area Impacts (temporary & permanent)

1. ☒ Buffer Zone Only – Check if the project is located only in the Buffer Zone of a Bordering Vegetated Wetland, Inland Bank, or Coastal Resource Area.
2. ☐ Inland Resource Areas (see 310 CMR 10.54-10.58; if not applicable, go to Section B.3, Coastal Resource Areas).

Check all that apply below. Attach narrative and any supporting documentation describing how the project will meet all performance standards for each of the resource areas altered, including standards requiring consideration of alternative project design or location.

For all projects affecting other Resource Areas, please attach a narrative explaining how the resource area was delineated.

Resource Area

Size of Proposed Alteration

Proposed Replacement (if any)

a. ☐ Bank

1. linear feet

2. linear feet

b. ☐ Bordering Vegetated Wetland

1. square feet

2. square feet

c. ☐ Land Under Waterbodies and Waterways

1. square feet

2. square feet

3. cubic yards dredged



Massachusetts Department of Environmental Protection
Bureau of Resource Protection - Wetlands

WPA Form 3 – Notice of Intent

Massachusetts Wetlands Protection Act M.G.L. c. 131, §40

Provided by MassDEP:

MassDEP File Number

Document Transaction Number

New Bedford

City/Town

B. Buffer Zone & Resource Area Impacts (temporary & permanent) (cont'd)

Resource Area	Size of Proposed Alteration	Proposed Replacement (if any)
d. <input type="checkbox"/> Bordering Land Subject to Flooding	1. square feet	2. square feet
	3. cubic feet of flood storage lost	4. cubic feet replaced
e. <input type="checkbox"/> Isolated Land Subject to Flooding	1. square feet	
	2. cubic feet of flood storage lost	3. cubic feet replaced
f. <input type="checkbox"/> Riverfront Area	1. Name of Waterway (if available)	

2. Width of Riverfront Area (check one):

☐ 25 ft. - Designated Densely Developed Areas only

☐ 100 ft. - New agricultural projects only

☐ 200 ft. - All other projects

3. Total area of Riverfront Area on the site of the proposed project:

square feet

4. Proposed alteration of the Riverfront Area:

a. total square feet

b. square feet within 100 ft.

c. square feet between 100 ft. and 200 ft.

5. Has an alternatives analysis been done and is it attached to this NOI?

☐ Yes ☒ No

6. Was the lot where the activity is proposed created prior to August 1, 1996?

☐ Yes ☒ No

3. ☐ Coastal Resource Areas: (See 310 CMR 10.25-10.35)

Check all that apply below. Attach narrative and supporting documentation describing how the project will meet all performance standards for each of the resource areas altered, including standards requiring consideration of alternative project design or location.

Online Users:
Include your document transaction number (provided on your receipt page) with all supplementary information you submit to the Department.

Resource Area	Size of Proposed Alteration	Proposed Replacement (if any)
a. <input type="checkbox"/> Designated Port Areas	Indicate size under Land Under the Ocean, below	
b. <input type="checkbox"/> Land Under the Ocean	1. square feet	
	2. cubic yards dredged	
c. <input type="checkbox"/> Barrier Beach	Indicate size under Coastal Beaches and/or Coastal Dunes below	
d. <input type="checkbox"/> Coastal Beaches	1. square feet	2. cubic yards beach nourishment
e. <input type="checkbox"/> Coastal Dunes	1. square feet	2. cubic yards dune nourishment



Massachusetts Department of Environmental Protection
Bureau of Resource Protection - Wetlands

WPA Form 3 – Notice of Intent

Massachusetts Wetlands Protection Act M.G.L. c. 131, §40

Provided by MassDEP:

MassDEP File Number

Document Transaction Number

New Bedford

City/Town

B. Buffer Zone & Resource Area Impacts (temporary & permanent) (cont'd)

	<u>Size of Proposed Alteration</u>	<u>Proposed Replacement (if any)</u>
f. <input type="checkbox"/> Coastal Banks	1. linear feet	
g. <input type="checkbox"/> Rocky Intertidal Shores	1. square feet	
h. <input type="checkbox"/> Salt Marshes	1. square feet	2. sq ft restoration, rehab., creation
i. <input type="checkbox"/> Land Under Salt Ponds	1. square feet	
	2. cubic yards dredged	
j. <input type="checkbox"/> Land Containing Shellfish	1. square feet	
k. <input type="checkbox"/> Fish Runs	Indicate size under Coastal Banks, inland Bank, Land Under the Ocean, and/or inland Land Under Waterbodies and Waterways, above.	
	1. cubic yards dredged	
l. <input type="checkbox"/> Land Subject to Coastal Storm Flowage	1. square feet	
4. <input type="checkbox"/> Restoration/Enhancement	If the project is for the purpose of restoring or enhancing a wetland resource area in addition to the square footage that has been entered in Section B.2.b or B.3.h above, please enter the additional amount here.	

a. square feet of BVW

b. square feet of Salt Marsh

5. ☐ Project Involves Stream Crossings

a. number of new stream crossings

b. number of replacement stream crossings

C. Other Applicable Standards and Requirements

Streamlined Massachusetts Endangered Species Act/Wetlands Protection Act Review

1. Is any portion of the proposed project located in **Estimated Habitat of Rare Wildlife** as indicated on the most recent Estimated Habitat Map of State-Listed Rare Wetland Wildlife published by the Natural Heritage and Endangered Species Program (NHESP)? To view habitat maps, see the *Massachusetts Natural Heritage Atlas* or go to http://www.mass.gov/dfwele/dfw/nhesp/regulatory_review/priority_habitat/online_viewer.htm.

a. ☐ Yes ☒ No

If yes, include proof of mailing or hand delivery of NOI to:

Natural Heritage and Endangered Species Program
Division of Fisheries and Wildlife
Route 135, North Drive
Westborough, MA 01581

2008

b. Date of map



WPA Form 3 – Notice of Intent

Massachusetts Wetlands Protection Act M.G.L. c. 131, §40

MassDEP File Number

Document Transaction Number

New Bedford

City/Town

C. Other Applicable Standards and Requirements (cont'd)

If yes, the project is also subject to Massachusetts Endangered Species Act (MESA) review (321 CMR 10.18). To qualify for a streamlined, 30-day, MESA/Wetlands Protection Act review, please complete Section C.1.C, and include requested materials with this Notice of Intent (NOI); OR complete Section C.1.d, if applicable. *If MESA supplemental information is not included with the NOI, by completing Section 1 of this form, the NHESP will require a separate MESA filing which may take up to 90 days to review (unless noted exceptions in Section 2 apply, see below).*

1. c. Submit Supplemental Information for Endangered Species Review*

1. ☐ Percentage/acreage of property to be altered:

(a) within wetland Resource Area

percentage/acreage

(b) outside Resource Area

percentage/acreage

2. ☐ Assessor's Map or right-of-way plan of site

3. ☐ Project plans for entire project site, including wetland resource areas and areas outside of wetlands jurisdiction, showing existing and proposed conditions, existing and proposed tree/vegetation clearing line, and clearly demarcated limits of work ****

(a) ☐ Project description (including description of impacts outside of wetland resource area & buffer zone)

(b) ☐ Photographs representative of the site

(c) ☐ MESA filing fee (fee information available at:

http://www.mass.gov/dfwele/dfw/nhesp/regulatory_review/ mesa/ mesa_fee_schedule.htm).

Make check payable to "Commonwealth of Massachusetts - NHESP" and **mail to NHESP** at above address

Projects altering 10 or more acres of land, also submit:

(d) ☐ Vegetation cover type map of site

(e) ☐ Project plans showing Priority & Estimated Habitat boundaries

d. OR Check One of the Following

1. ☐ Project is exempt from MESA review.
Attach applicant letter indicating which MESA exemption applies. (See 321 CMR 10.14, http://www.mass.gov/dfwele/dfw/nhesp/regulatory_review/ mesa/ mesa_exemptions.htm; the NOI must still be sent to NHESP if the project is within estimated habitat pursuant to 310 CMR 10.37 and 10.59.)

2. ☐ Separate MESA review ongoing.

a. NHESP Tracking #

b. Date submitted to NHESP

* Some projects not in Estimated Habitat may be located in Priority Habitat, and require NHESP review (see <http://www.mass.gov/dfwele/dfw/nhesp/nhesp.htm>, regulatory review tab). Priority Habitat includes habitat for state-listed plants and strictly upland species not protected by the Wetlands Protection Act.

** MESA projects may not be segmented (321 CMR 10.16). The applicant must disclose full development plans even if such plans are not required as part of the Notice of Intent process.



WPA Form 3 – Notice of Intent

Massachusetts Wetlands Protection Act M.G.L. c. 131, §40

MassDEP File Number

Document Transaction Number

New Bedford

City/Town

C. Other Applicable Standards and Requirements (cont'd)

3. ☐ Separate MESA review completed.
Include copy of NHESP "no Take" determination or valid Conservation & Management Permit with approved plan.
2. For coastal projects only, is any portion of the proposed project located below the mean high water line or in a fish run?
- a. ☒ Not applicable – project is in inland resource area only

- b. ☐ Yes ☐ No If yes, include proof of mailing or hand delivery of NOI to either:

South Shore - Cohasset to Rhode
Island, and the Cape & Islands:

North Shore - Hull to New Hampshire:

Division of Marine Fisheries -
Southeast Marine Fisheries Station
Attn: Environmental Reviewer
1213 Purchase Street – 3rd Floor
New Bedford, MA 02740-6694

Division of Marine Fisheries -
North Shore Office
Attn: Environmental Reviewer
30 Emerson Avenue
Gloucester, MA 01930

Also if yes, the project may require a Chapter 91 license. For coastal towns in the Northeast Region, please contact MassDEP's Boston Office. For coastal towns in the Southeast Region, please contact MassDEP's Southeast Regional Office.

3. Is any portion of the proposed project within an Area of Critical Environmental Concern (ACEC)?
- a. ☐ Yes ☒ No If yes, provide name of ACEC (see instructions to WPA Form 3 or MassDEP Website for ACEC locations). **Note:** electronic filers click on Website.
- b. ACEC
4. Is any portion of the proposed project within an area designated as an Outstanding Resource Water (ORW) as designated in the Massachusetts Surface Water Quality Standards, 314 CMR 4.00?
- a. ☐ Yes ☒ No
5. Is any portion of the site subject to a Wetlands Restriction Order under the Inland Wetlands Restriction Act (M.G.L. c. 131, § 40A) or the Coastal Wetlands Restriction Act (M.G.L. c. 130, § 105)?
- a. ☐ Yes ☒ No
6. Is this project subject to provisions of the MassDEP Stormwater Management Standards?
- a. ☐ Yes. Attach a copy of the Stormwater Report as required by the Stormwater Management Standards per 310 CMR 10.05(6)(k)-(q) and check if:
1. ☐ Applying for Low Impact Development (LID) site design credits (as described in Stormwater Management Handbook Vol. 2, Chapter 3)
 2. ☐ A portion of the site constitutes redevelopment
 3. ☐ Proprietary BMPs are included in the Stormwater Management System.
- b. ☒ No. Check why the project is exempt:
1. ☒ Single-family house

Online Users:
Include your
document
transaction
number
(provided on your
receipt page)
with all
supplementary
information you
submit to the
Department.



WPA Form 3 – Notice of Intent

Massachusetts Wetlands Protection Act M.G.L. c. 131, §40

MassDEP File Number

Document Transaction Number

New Bedford

City/Town

C. Other Applicable Standards and Requirements (cont'd)

2. ☐ Emergency road repair
3. ☐ Small Residential Subdivision (less than or equal to 4 single-family houses or less than or equal to 4 units in multi-family housing project) with no discharge to Critical Areas.

D. Additional Information

Applicants must include the following with this Notice of Intent (NOI). See instructions for details.

Online Users: Attach the document transaction number (provided on your receipt page) for any of the following information you submit to the Department.

1. ☒ USGS or other map of the area (along with a narrative description, if necessary) containing sufficient information for the Conservation Commission and the Department to locate the site. (Electronic filers may omit this item.)
2. ☒ Plans identifying the location of proposed activities (including activities proposed to serve as a Bordering Vegetated Wetland [BVW] replication area or other mitigating measure) relative to the boundaries of each affected resource area.
3. ☒ Identify the method for BVW and other resource area boundary delineations (MassDEP BVW Field Data Form(s), Determination of Applicability, Order of Resource Area Delineation, etc.), and attach documentation of the methodology.
4. ☒ List the titles and dates for all plans and other materials submitted with this NOI.

Plot Plan (Assessors Map 136 Lot 534)

a. Plan Title

SITEC, Inc.

b. Prepared By

5-22-17

d. Final Revision Date

Steven D. Gioiosa

c. Signed and Stamped by

1" = 20'

e. Scale

f. Additional Plan or Document Title

g. Date

5. ☐ If there is more than one property owner, please attach a list of these property owners not listed on this form.
6. ☐ Attach proof of mailing for Natural Heritage and Endangered Species Program, if needed.
7. ☐ Attach proof of mailing for Massachusetts Division of Marine Fisheries, if needed.
8. ☒ Attach NOI Wetland Fee Transmittal Form
9. ☐ Attach Stormwater Report, if needed.



Massachusetts Department of Environmental Protection
Bureau of Resource Protection - Wetlands

Provided by MassDEP:

WPA Form 3 – Notice of Intent

Massachusetts Wetlands Protection Act M.G.L. c. 131, §40

MassDEP File Number

Document Transaction Number

New Bedford

City/Town

E. Fees

1. ☐ Fee Exempt: No filing fee shall be assessed for projects of any city, town, county, or district of the Commonwealth, federally recognized Indian tribe housing authority, municipal housing authority, or the Massachusetts Bay Transportation Authority.

Applicants must submit the following information (in addition to pages 1 and 2 of the NOI Wetland Fee Transmittal Form) to confirm fee payment:

7038	5-24-17
2. Municipal Check Number	3. Check date
7037	5-24-17
4. State Check Number	5. Check date
Rosa	Moniz
6. Payor name on check: First Name	7. Payor name on check: Last Name

F. Signatures and Submittal Requirements

I hereby certify under the penalties of perjury that the foregoing Notice of Intent and accompanying plans, documents, and supporting data are true and complete to the best of my knowledge. I understand that the Conservation Commission will place notification of this Notice in a local newspaper at the expense of the applicant in accordance with the wetlands regulations, 310 CMR 10.05(5)(a).

I further certify under penalties of perjury that all abutters were notified of this application, pursuant to the requirements of M.G.L. c. 131, § 40. Notice must be made by Certificate of Mailing or in writing by hand delivery or certified mail (return receipt requested) to all abutters within 100 feet of the property line of the project location.

1. Signature of Applicant

5-24-17

2. Date

3. Signature of Property Owner (if different)

4. Date

5. Signature of Representative (if any)

5-24-17

6. Date

For Conservation Commission:

Two copies of the completed Notice of Intent (Form 3), including supporting plans and documents, two copies of the NOI Wetland Fee Transmittal Form, and the city/town fee payment, to the Conservation Commission by certified mail or hand delivery.

For MassDEP:

One copy of the completed Notice of Intent (Form 3), including supporting plans and documents, one copy of the NOI Wetland Fee Transmittal Form, and a **copy** of the state fee payment to the MassDEP Regional Office (see Instructions) by certified mail or hand delivery.

Other:

If the applicant has checked the "yes" box in any part of Section C, Item 3, above, refer to that section and the Instructions for additional submittal requirements.

The original and copies must be sent simultaneously. Failure by the applicant to send copies in a timely manner may result in dismissal of the Notice of Intent.



Massachusetts Department of Environmental Protection
Bureau of Resource Protection - Wetlands
NOI Wetland Fee Transmittal Form
Massachusetts Wetlands Protection Act M.G.L. c. 131, §40

Important: When filling out forms on the computer, use only the tab key to move your cursor - do not use the return key.



A. Applicant Information

1. Applicant:

a. First Name _____ b. Last Name _____
D.P.M. Development, Inc.
c. Organization _____
70 Lambeth Street
d. Mailing Address _____
New Bedford MA 02745
e. City/Town _____ f. State _____ g. Zip Code _____
508-993-0381 508-995-4342
h. Phone Number _____ i. Fax Number _____ j. Email Address _____

2. Property Owner (if different):

a. First Name _____ b. Last Name _____
c. Organization _____
d. Mailing Address _____
e. City/Town _____ f. State _____ g. Zip Code _____
h. Phone Number _____ i. Fax Number _____ j. Email Address _____

3. Project Location:

Rosa Drive (Assessors Map 136 Lot 534) New Bedford
a. Street Address _____ b. City/Town _____

B. Fees

To calculate filing fees, refer to the category fee list and examples in the instructions for filling out WPA Form 3 (Notice of Intent).

The fee should be calculated using the following six-step process and worksheet. **Please see Instructions before filling out worksheet.**

Step 1/Type of Activity: Describe each type of activity that will occur in wetland resource area and buffer zone.

Step 2/Number of Activities: Identify the number of each type of activity.

Step 3/Individual Activity Fee: Identify each activity fee from the six project categories listed in the instructions.

Step 4/Subtotal Activity Fee: Multiply the number of activities (identified in Step 2) times the fee per category (identified in Step 3) to reach a subtotal fee amount. Note: If any of these activities are in a Riverfront Area in addition to another Resource Area or the Buffer Zone, the fee per activity should be multiplied by 1.5 and then added to the subtotal amount.

Step 5/Total Project Fee: Determine the total project fee by adding the subtotal amounts from Step 4.

Step 6/Fee Payments: To calculate the state share of the fee, divide the total fee in half and subtract \$12.50. To calculate the city/town share of the fee, divide the total fee in half and add \$12.50.



Massachusetts Department of Environmental Protection
Bureau of Resource Protection - Wetlands
NOI Wetland Fee Transmittal Form
Massachusetts Wetlands Protection Act M.G.L. c. 131, §40

B. Fees (continued)

Step 1/Type of Activity	Step 2/Number of Activities	Step 3/Individual Activity Fee	Step 4/Subtotal Activity Fee
Single Family Dwelling	1	\$500	\$500

Step 5/Total Project Fee: \$500

Step 6/Fee Payments:

Total Project Fee:	\$500.00
	a. Total Fee from Step 5
State share of filing Fee:	\$237.50
	b. 1/2 Total Fee less \$12.50
City/Town share of filing Fee:	\$267.50
	c. 1/2 Total Fee plus \$12.50

C. Submittal Requirements

- a.) Complete pages 1 and 2 and send with a check or money order for the state share of the fee, payable to the Commonwealth of Massachusetts.

Department of Environmental Protection
Box 4062
Boston, MA 02211

- b.) **To the Conservation Commission:** Send the Notice of Intent or Abbreviated Notice of Intent; a copy of this form; and the city/town fee payment.

To MassDEP Regional Office (see Instructions): Send a copy of the Notice of Intent or Abbreviated Notice of Intent; a copy of this form; and a copy of the state fee payment. (E-filers of Notices of Intent may submit these electronically.)



CITY OF NEW BEDFORD
MASSACHUSETTS

CONSERVATION COMMISSION
2009 FILING FEE CALCULATION WORKSHEET*

PROJECT LOCATION:

RODA DRIVE MAP 136 LOT(S) 534

APPLICANT: DPM DEVELOPMENT CORP.

CONSERVATION COMMISSION FEES (check all that apply):

- ☐ REQUEST FOR DETERMINATION OF APPLICABILITY
- ☒ NOTICE OF INTENT
- ☐ INQUIRY AS TO NEED FOR AN AMENDED ORDER**
- ☐ AMENDED ORDER OF CONDITIONS
- ☐ ANRAD (Abbreviated Notice of Resource Area Delineation)
- ☐ EXTENSION PERMIT
- ☐ CERTIFICATE OF COMPLIANCE
- ☐ AFTER THE FACT FILING
- ☐ RESTORATION PLAN FEE (no NOI filing required)
- ☐ LIFTING AN ENFORCEMENT ORDER
- ☐ PENALTIES

(A.) ALTERATION FEES:

Application and field review of a project proposed in a Wetland Resource Area or its Buffer Zone is \$150.00 plus the applicable alteration fee as follows

	AMOUNT DUE
• Application and Field Review Fee (\$150.00)	\$ <u>150.-</u>
• \$0.50 X _____ SF Wetland Resource Area	\$ _____
• \$0.05 X _____ SF Land Subject Coastal Flooding	\$ _____
• \$0.20 X _____ SF Developed Riverfront Area	\$ _____
• \$1.00 X _____ SF Undeveloped Riverfront Area	\$ _____
• \$5.00 X _____ LF Coastal Bank	\$ _____
• \$0.10 X <u>11,450</u> SF Buffer Zone	\$ <u>1,145.-</u>

(B.) EXTENSION of an Order of Conditions:

- Minor Project ... \$100.00 + _____ (¼ local fee from NOI) \$ _____
- Other Projects ... \$200.00 + _____ (¼ local fee from NOI) \$ _____

(C.) AMENDING A PERMIT:

- Written inquiry or request to appear to determine the need for an Amended Order:** (\$50.00 fee) \$ _____
- Amending OOC: \$150.00 + _____ (applicable alteration fee) \$ _____

**(D.) RESOURCE BOUNDARY DELINEATION VERIFICATION
USING AN RDA APPLICATION:**

- \$150.00 + \$2.00 X _____ LF Wetland boundary \$ _____

**(E.) ABBREVIATED RESOURCE AREA DELINEATION VERIFICATION
(ANRAD)**

- \$150.00 + \$1.00 X _____ LF Resource Area boundary \$ _____

**(F.) RESOURCE BOUNDARY DELINEATION VERIFICATION CONDUCTED
DURING A NOTICE OF INTENT REVIEW**

- \$150.00 + \$3.00 X _____ LF Resource Area boundary \$ _____

(G.) DOCKS:

- \$100.00 + \$4.00 X _____ LF of dock \$ _____
- Add 150% to total fee if in significant shellfish habitat \$ _____

(H.) AFTER THE FACT FILING:

- All Total Fees are doubled \$ _____

(I.) RESTORATION PLAN FEE:

- (\$150.00 + _____ Alteration Fee) Multiplied by 2 \$ _____

(J.) LIFTING ON ENFORCEMENT ORDER:

- \$150.00 fee \$ _____

(K.) CERTIFICATE OF COMPLIANCE:

- refer to "K" of the Fee schedule \$ _____

(L.) PENALTIES:

- refer to "L" of the Fee schedule \$ _____

TOTAL AMOUNT DUE (including after-the-fact fee if applicable): \$ 1,295.00

Notes:

* Please refer to the Conservation Commission Fee Schedule - Revised April 2009

** This is not required, but available for anyone who would like to appear to discuss the need to Amend.

Please make check or Money Order payable to: THE CITY OF NEW BEDFORD.
Cash is not Accepted.

DPM DEVELOPMENT CORP.
70 LAMBETH STREET
NEW BEDFORD, MA 02745

WEBSTER BANK
S EASTON, MA 02375

7039

53-70232113
578

5/24/2017

PAY TO THE
ORDER OF CITY OF NEW BEDFORD

\$ **1,295.00

One Thousand Two Hundred Ninety-Five and 00/100*****

DOLLARS

CITY OF NEW BEDFORD

MEMO

Lot #3 Rosa Dr.

Rosa M...
AUTHORIZED SIGNATURE

⑈007039⑈ ⑆211370231⑆10 0133001154⑈

DPM DEVELOPMENT CORP.

7039

CITY OF NEW BEDFORD

5/24/2017

1,295.00

Cash-checking

Lot #3 Rosa Dr.

1,295.00

Details on Back,  Security Features included

Notification to Abutters under the City of New Bedford
Wetlands Ordinance

In Accordance with the City of New Bedford Wetlands Ordinance (New Bedford Code of Ordinances Sections 15-101 through 15-112) you are hereby notified of the following.

The name of the applicant is: DPM DEVELOPMENT CORP.

The applicant has filed a Request for Determination of Applicability for the municipality of New Bedford, Massachusetts seeking permission to remove, fill, dredge or alter an area subject to protection under the City of New Bedford Wetlands Ordinance (New Bedford Code of Ordinances Sections 15-101 through 15-112).

The address of the lot where the activity is proposed is: ROSA DRIVE
Assessor's Map 136; Lot 534

Copies of the Request for Determination of Applicability may be examined at the New Bedford Conservation Commission, City Hall, 133 William St. Room 304 New Bedford, MA 02740 between the hours of 8:00 AM and 4:00 PM, Monday through Friday. For more information call (508) 991-6188.

Copies of the Request for Determination of Applicability may be obtained from either (check one) the applicant _____ or the applicant's representative ☒ by calling this telephone number 508-998-2125 between the hours of 8:00 AM and 4:00 PM on the following days of the week: Monday through Friday.

Information regarding the date, time and place of the public hearing may be obtained from New Bedford Conservation Commission by calling 508-991-6188 between the hours of 8:00 AM and 4:00 PM Monday through Friday.

Note: Notice of the Public hearing, including its date, time and place, will be posted in the City Hall not less than forty eight (48) hours in advance of the meeting.

Note: Notice of the Public Hearing including its date, time and place, will be published at least five (5) days in advance in the Standard Times.

Note: You may also contact the New Bedford Conservation Commission at 508-991-6188 for more information about this publication or the City of New Bedford Wetlands Ordinance



City of New Bedford

REQUEST for a CERTIFIED ABUTTERS LIST

This information is needed so that an official abutters list as required by MA General Law may be created and used in notifying abutters. You, as applicant, are responsible for picking up and paying for the certified abutters list from the assessor's office (city hall, room #109).

SUBJECT PROPERTY	
MAP #	136
LOT(S)#	532
ADDRESS: NS Rosa Dr	
OWNER INFORMATION	
NAME: DPM Development	
MAILING ADDRESS: 70 Lambeth Street, New Bedford, MA 02745	
APPLICANT/CONTACT PERSON INFORMATION	
NAME (IF DIFFERENT): Jeff @ SITEC Engineering	
MAILING ADDRESS (IF DIFFERENT): 449 Faunce Corner Rd, Dartmouth, MA 02747	
TELEPHONE #	508 998.2125
EMAIL ADDRESS:	jtallman@sitec-engineering.com
REASON FOR THIS REQUEST: <i>Check appropriate</i>	
<input type="checkbox"/>	ZONING BOARD OF APPEALS APPLICATION
<input type="checkbox"/>	PLANNING BOARD APPLICATION
<input checked="" type="checkbox"/>	CONSERVATION COMMISSION APPLICATION
<input type="checkbox"/>	LICENSING BOARD APPLICATION
<input type="checkbox"/>	OTHER (Please explain):

Once obtained, the Certified List of Abutters must be attached to this Certification Letter.

Submit this form to the Planning Division Room 303 in City Hall, 133 William Street. You, as applicant, are responsible for picking up and paying for the certified abutters list from the assessor's office (city hall, room #109).

Official Use Only:

As Administrative Assistant to the City of New Bedford's Board of Assessors, I do hereby certify that the names and addresses as identified on the attached "abutters list" are duly recorded and appear on the most recent tax.

Carlos Amado

Printed Name

Signature

5/25/2017

Date

PLANNING
MAY 22 2017
DEPARTMENT

May 22, 2017
Dear Applicant,

Please find below the List of Abutters within 300 feet of the property known as NS Rosa Dr (136-532) The current ownership listed herein must be checked and verified by the City of New Bedford Assessor's Office. Following said verification, the list shall be considered a Certified List of Abutters.

Please note that multiple listed properties with identical owner name and mailing address shall be considered duplicates, and shall require only 1 mailing. Additionally, City of New Bedford-Owned properties shall not require mailed notice.

Parcel	Location	Owner and Mailing Address
136-334	4102 ACUSHNET AVE	BONNEAU PAUL, BONNEAU GRACE T 4102 ACUSHNET AVE NEW BEDFORD, MA 02745
136-283 <i>RES</i>	ACUSHNET AVE	LEBLANC J LOUIS, LEBLANC CLAUDETTE 4090 ACUSHNET AVE NEW BEDFORD, MA 02745
136-474 <i>NS</i>	ROSA DR	MONIZ PROPERTIES INC, 70 LAMBETH STREET NEW BEDFORD, MA 02745
136-276	4045 ACUSHNET AVE	DANDURAND HELEN, 4045 ACUSHNET AVENUE <i>H Kacy Lane</i> NEW BEDFORD, MA 02745 <i>Fairhaven, MA 02719</i>
136-330	4077 ACUSHNET AVE	4077 ACUSHNET AVENUE, LLC, 867 MIDDLE ROAD ACUSHNET, MA 02743
136-24	4060 ACUSHNET AVE	LECOMTE MARK A, LECOMTE LORI A 4060 ACUSHNET AVENUE NEW BEDFORD, MA 02745
136-250	4052 ACUSHNET AVE	BEATRIZ DANIEL, BEATRIZ JOANNE 4052 ACUSHNET AVE NEW BEDFORD, MA 02745
136-272	4085 ACUSHNET AVE	KROUZEK RONALD A, SANTOS PAULINE D 4085 ACUSHNET AVE NEW BEDFORD, MA 02745
136-402 <i>ES</i>	ACUSHNET AVE	LECOMTE MARK A, ASHLEY LORI A 4060 ACUSHNET AVE NEW BEDFORD, MA 02745
136-470 <i>SS</i>	ROSA DR	DPM DEVELOPMENT CORP, 70 LAMBETH STREET NEW BEDFORD, MA 02745
136-532 <i>NS</i>	ROSA DR	DPM DEVELOPMENT CORP, 70 LAMBETH STREET NEW BEDFORD, MA 02745
136-469 <i>SS</i>	ROSA DR	MONIZ PROPERTIES INC, 70 LAMBETH STREET NEW BEDFORD, MA 02745
136-245 <i>ES</i>	ACUSHNET AVE	LEBLANC J LOUIS, LEBLANC CLAUDETTE 4090 ACUSHNET AVE NEW BEDFORD, MA 02745

May 22, 2017
Dear Applicant,

Please find below the List of Abutters within 300 feet of the property known as 1669 Acushnet Ave (103-292) The current ownership listed herein must be checked and verified by the City of New Bedford Assessor's Office. Following said verification, the list shall be considered a Certified List of Abutters.

Please note that multiple listed properties with identical owner name and mailing address shall be considered duplicates, and shall require only 1 mailing. Additionally, City of New Bedford-Owned properties shall not require mailed notice.

Parcel	Location	Owner and Mailing Address
136-23 NS	ROSA DR	DPM DEVELOPMENT CORP, 70 LAMBETH STREET NEW BEDFORD, MA 02745
136-248	4080 ACUSHNET AVE	DECOSTA ALEX R, 4080 ACUSHNET AVENUE NEW BEDFORD, MA 02745
136-249	4090 ACUSHNET AVE	LEBLANC J LOUIS, LEBLANC CLAUDETTE 4090 ACUSHNET AVE NEW BEDFORD, MA 02745

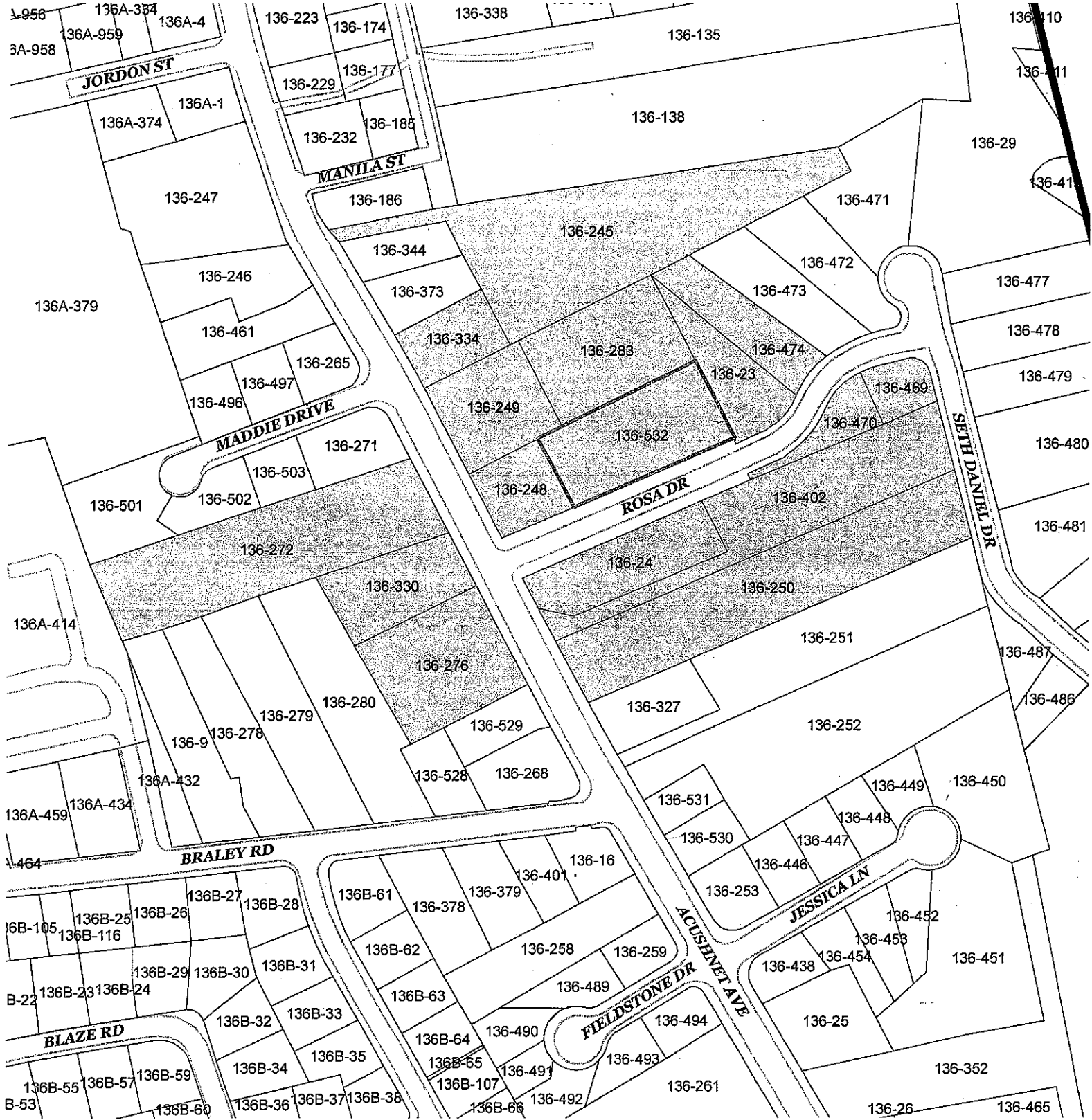

REG. OF DEEDS
BRISTOL
12/03/13 11:15 AM
20000 00373
4074.40
0.00

RE: 4080 Acushnet Avenue
New Bedford, MA 02740

EXHIBIT "A"

RE: 4080 Acushnet Avenue, New Bedford, MA 02745

The land, with any buildings thereon, situated in New Bedford, Bristol County, Commonwealth of Massachusetts, bounded and described as follows:

**MASSACHUSETTS OUTCLAIM DEED
INDIVIDUAL**

I, JUDITH A. ROWSON, of New Bedford, Massachusetts,
being *unmarried*, for consideration paid, and in full consideration of TWO HUNDRED FORTY
THOUSAND and 00/100 (\$240,000.00) DOLLARS
grant to DPM DEVELOPMENT CORP., a Massachusetts Corporation having a principal place
of business at 70 Lambeth Street, New Bedford, Massachusetts 02745
with Quitclaim Covenants
the land and buildings located at 4080 Acushnet Avenue, New Bedford, Massachusetts 02745,
bounded and described as follows:

(Description and encumbrances, if any)

SEE EXHIBIT "A" ATTACHED HERETO AND INCORPORATED
HEREIN BY REFERENCE

WITNESS my hand and seal this 3rd day of December 2013.

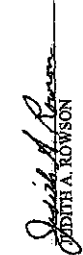
JUDITH A. ROWSON

COMMONWEALTH OF MASSACHUSETTS

BRISTOL, SS. December 3, 2013

Then personally appeared the above-named Judith A. Rowson, proved to me through satisfactory evidence of identification, which was a Massachusetts Drivers License, to be the person whose name is signed on the within document, and acknowledged the foregoing instrument to be her free act and deed, before me

Notary Public



My Commission Expires: 3/18/15

Return to:
MATTHEW E. MATHEU
50 Fifth Street
New Bedford, MA 02745

BEGINNING at a point in the easterly line of Acushnet Avenue, formerly called Old County Road, at the northwesterly corner of the premises to be conveyed, and at the southwesterly corner of land now or formerly of John E. Luby; thence running
EAST 13 3/4° North by said last-named land, three hundred eighty-nine and 7/10 (389.7) feet for a corner; thence
SOUTH 11 3/4° East by a wall and land now or formerly of Susan A. Ashley, one hundred forty and 8/10 (140.8) feet for a corner thence
WEST 10° South by said last-named land, three hundred eighty-seven and 8/10 (387.8) feet to said east line of Acushnet Avenue; and thence
NORTHERLY by said Acushnet Avenue, one hundred fourteen and 3/10 (114.3) feet to the point of beginning.

CONTAINING one (1) acre and twenty-one and 9/10 (21.9) square rods, more or less.

FOR TITLE see deed August 24, 2007 and recorded in the Bristol County (S.D.) Registry of Deeds in Book 8767, Page 121.

