

File number:	200220-4	UNREGISTERED LAND		
Attorney:	SULLIVAN, WILLIAMS & QUINTIN	Deed Book	12415	Page 12
Lender:	BAYCOAST MORTGAGE COMPANY, LLC	Plan Book		Page Lot(s)
Owner:	CSY REALTY TRUST	REGISTERED LAND		
		Reg. Book	Sheet	Lot(s):
Date:	2/21/2020	Certificate of Title		
Assessor's Map	136A	Blk:	Lot 827	Census Tract

MORTGAGE INSPECTION PLAN
1091 TOBEY STREET, NEW BEDFORD, MA

Scale: 1"=30'

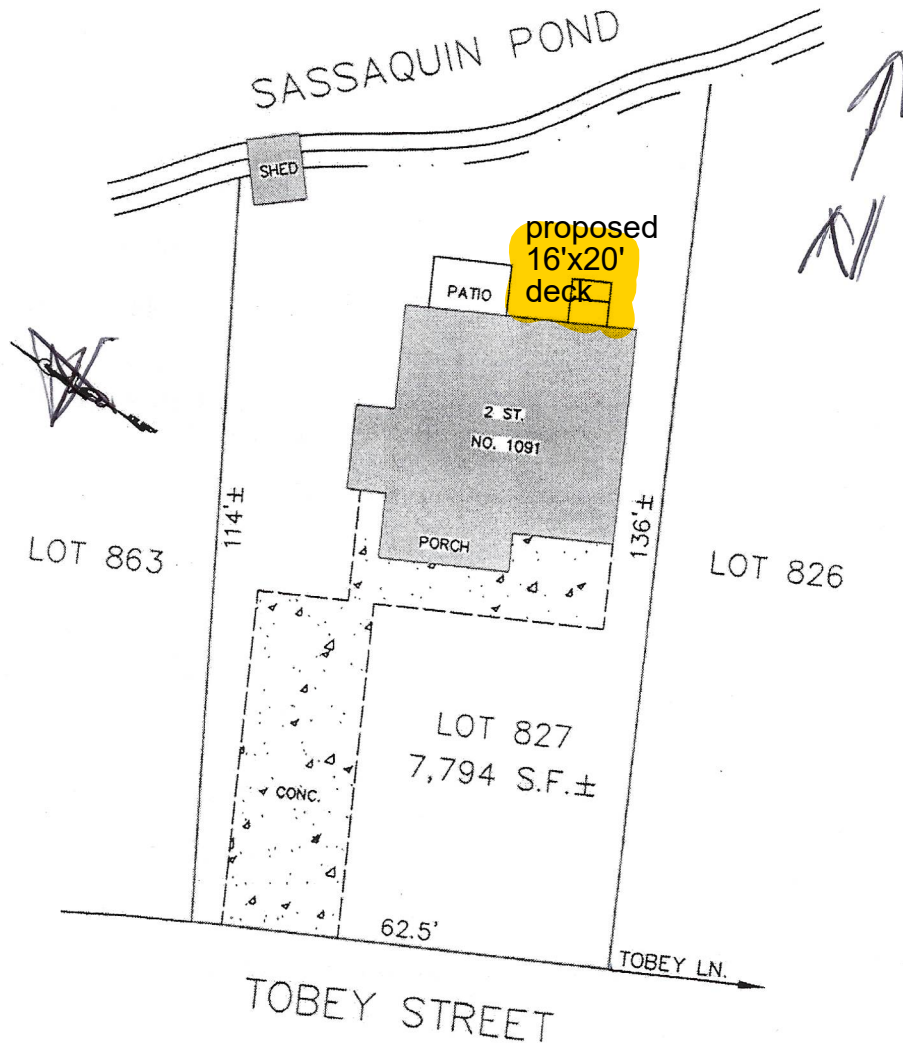

CERTIFICATION

I CERTIFY TO THE ABOVE ATTORNEY, BANK, AND THEIR TITLE INSURANCE COMPANY THAT THE MAIN BUILDING, FOUNDATION OR DWELLING WAS IN COMPLIANCE WITH THE LOCAL ZONING BYLAWS IN EFFECT WHEN CONSTRUCTED (WITH RESPECT TO STRUCTURAL SETBACK REQUIREMENTS ONLY) OR IS EXEMPT FROM VIOLATION ENFORCEMENT ACTION UNDER MASS. GENERAL LAW TITLE VII, CHAPTER 40A, SECTION 7.

FLOOD DETERMINATION

BY SCALE, THE DWELLING SHOWN HERE DOES NOT FALL WITHIN A SPECIAL FLOOD HAZARD ZONE AS DELINEATED ON A MAP OF COMMUNITY # 25005C377F AS ZONE X DATED 07/07/2009 BY THE NATIONAL FLOOD INSURANCE PROGRAM.

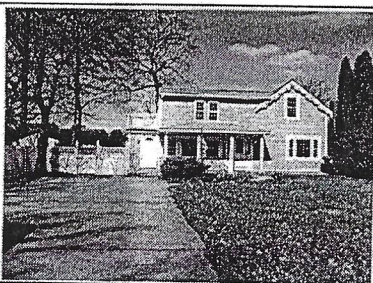

Olde Stone Plot Plan Service, LLC
P.O. Box 1166
Lakeville, MA 02347-
Tel: (800) 993-3302
Fax: (800) 993-3304

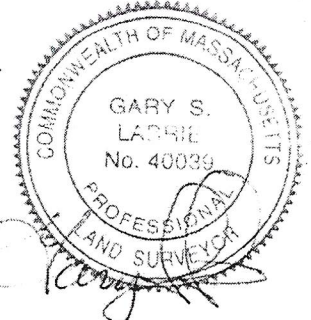

PLEASE NOTE: This inspection is not the result of an instrument survey. The structures as shown are approximate only. An instrument survey would be required for an accurate determination of building locations, encroachments, property line dimensions, fences and lot configuration and may reflect different information than shown here. The land as shown is based on client furnished information only or assessor's map & occupation and may be subject to further out-sales, takings, easements and rights of way. No responsibility is extended to the landowner or surveyor, or occupant. This is merely a mortgage inspection and is not be recorded.