



City of New Bedford **REQUEST for a CERTIFIED ABUTTERS LIST**

This information is needed so that an official abutters list as required by MA General Law may be created and used in notifying abutters. You, as applicant, are responsible for picking up and paying for the certified abutters list from the assessor's office (city hall, room #109).

| SUBJECT PROPERTY | | | |
|---|-------------------------------------|---------|--|
| MAP # | | LOT(S)# | |
| ADDRESS: | | | |
| | | | |
| OWNER INFORMATION | | | |
| NAME: | | | |
| MAILING ADDRESS: | | | |
| | | | |
| APPLICANT/CONTACT PERSON INFORMATION | | | |
| NAME (IF DIFFERENT): | | | |
| MAILING ADDRESS (IF DIFFERENT): | | | |
| | | | |
| TELEPHONE # | | | |
| EMAIL ADDRESS: | | | |
| REASON FOR THIS REQUEST: <i>Check appropriate</i> | | | |
| <input type="checkbox"/> | ZONING BOARD OF APPEALS APPLICATION | | |
| <input type="checkbox"/> | PLANNING BOARD APPLICATION | | |
| <input type="checkbox"/> | CONSERVATION COMMISSION APPLICATION | | |
| <input type="checkbox"/> | LICENSING BOARD APPLICATION | | |
| <input type="checkbox"/> | OTHER (<i>Please explain</i>): | | |

Once obtained, the Certified List of Abutters must be attached to this Certification Letter.

Submit this form to the Planning Division Room 303 in City Hall, 133 William Street. You, as applicant, are responsible for picking up and paying for the certified abutters list from the assessor's office (city hall, room #109).

Official Use Only:

As Administrative Assistant to the City of New Bedford's Board of Assessors, I do hereby certify that the names and addresses as identified on the attached "abutters list" are duly recorded and appear on the most recent tax.

Michael J. Motta

Printed Name

Signature

Date

May 25, 2021
Dear Applicant,

Please find below the List of Abutters within 100 feet of the property known as Victory Park (Map: 6, Lot: 1). The current ownership listed herein must be checked and verified by the City of New Bedford Assessor's Office. Following said verification, the list shall be considered a Certified List of Abutters.

Please note that multiple listed properties with identical owner name and mailing address shall be considered duplicates and shall require only 1 mailing. Additionally, City of New Bedford-Owned properties shall not require mailed notice.

| <u>Parcel</u> | <u>Location</u> | <u>Owner and Mailing Address</u> |
|---------------|------------------|---|
| 6-68 | 38 LIGHTHOUSE LN | MENESES ARLETE & FERNANDES JOSE 38 LIGHTHOUSE LANE NEW BEDFORD, MA 02744 |
| 8-145 | 103 RICKETSON ST | NANOPOULOS GRACIA A, 103 RICKETSON ST NEW BEDFORD, MA 02744 |
| 6-1 | 224 BROCK AVE | CITY OF NEW BEDFORD, 131 WILLIAM ST NEW BEDFORD, MA 02740 |
| 6-76 | 44 LIGHTHOUSE LN | TAVARES FRANCISCO A, 44 LIGHTHOUSE LANE NEW BEDFORD, MA 02744 |
| 5-227 | 159 BROCK AVE | JACQUES THERESA SIMON, DUGAN WILLIAM 159 BROCK AVE NEW BEDFORD, MA 02744 |
| 6-3 | ES BROCK AVE | CITY OF NEW BEDFORD, 131 WILLIAM ST NEW BEDFORD, MA 02740 |
| 6-80 | 74 FREEDOM BLVD | HAGHIGHAT HOSSEIN, HAGHIGHAT ISABEL A 74 FREEDOM BLVD NEW BEDFORD, MA 02744 |
| 6-79 | 66 FREEDOM BLVD | OLIVEIRA JOE, OLIVEIRA ZELIA M 66 FREEDOM BLVD NEW BEDFORD, MA 02744-1911 |
| 7-7 | 235 BROCK AVE | CITY OF NEW BEDFORD, SO END BRONCO LEAGUE 131 WILLIAM ST NEW BEDFORD, MA 02740 |
| 6-67 | 28 LIGHTHOUSE LN | FREITAS WALTER R, FREITAS NATALIE 28 LIGHTHOUSE LN NEW BEDFORD, MA 02744 |
| 7-161 | 9 ABALONE ST | FONSECA ERNESTINE O "TRUSTEE", ERNESTINE O FONSECA REVOCABLE TRUST-2004 (THE) 9 ABALONE ST NEW BEDFORD, MA 02744 |
| 6-59 | 10 LIGHTHOUSE LN | DASILVA SONIA R "TRUSTEE", DASILVA TANIA R "TRUSTEE" 10 LIGHTHOUSE LANE NEW BEDFORD, MA 02744 |
| 6-60 | 22 LIGHTHOUSE LN | PONTES ROBYN M "TRUSTEE", ROBYN M PONTES REVOCABLE TRUST 22 LIGHTHOUSE LN NEW BEDFORD, MA 02744 |

May 25, 2021
Dear Applicant,

Please find below the List of Abutters within 100 feet of the property known as Victory Park (Map: 6, Lot: 1). The current ownership listed herein must be checked and verified by the City of New Bedford Assessor's Office. Following said verification, the list shall be considered a Certified List of Abutters.

Please note that multiple listed properties with identical owner name and mailing address shall be considered duplicates and shall require only 1 mailing. Additionally, City of New Bedford-Owned properties shall not require mailed notice.

| <u>Parcel</u> | <u>Location</u> | <u>Owner and Mailing Address</u> |
|---------------|------------------|---|
| 7-6 | WS BROCK AVE | CITY OF NEW BEDFORD, VICTORY PARK 131 WILLIAM ST NEW BEDFORD, MA 02740 |
| 8-123 | ES BROCK AVE | COMMONWEALTH ELECTRIC CO, C/O PROPERTY TAX DEPT P O BOX 270 HARTFORD, CT 06141 |
| 8-156 | 153 RICKETSON ST | MOCO FERNANDA M, MENDES FLORINDA M 153 RICKETSON ST NEW BEDFORD, MA 02744 |
| 8-154 | 147 RICKETSON ST | SOUZA JAMES W& SOUZA VANESSA A 147 RICKETSON ST NEW BEDFORD, MA 02744 |
| 8-152 | 143 RICKETSON ST | DEVINE RICHARD P, DEVINE SHEILA D 143 RICKETSON STREET NEW BEDFORD, MA 02744 |
| 6-33 | 6 LIGHTHOUSE LN | SHAH WALEED SHAH ANUM 6 LIGHTHOUSE LANE NEW BEDFORD, MA 02744 |
| 8-143 | 99 RICKETSON ST | TAVARES CORY WORSLEY CIERRA 99 RICKETSON STREET NEW BEDFORD, MA 02744 |
| 6-77 | 48 FREEDOM BLVD | VINAGRE FERNANDO & VINAGRE ANDREA, 48 FREEDOM BLVD NEW BEDFORD, MA 02744 |
| 8-120 | 294 BROCK AVE | FLOREK DAVID A, 294 BROCK AVENUE NEW BEDFORD, MA 02744 |
| 8-124 | 174 BELLEVUE ST | THORNHILL JUDITH M, 174 BELLEVUE ST NEW BEDFORD, MA 02744 |
| 8-146 | RICKETSON ST | ROBINSON MARIE E, 462 PURCHASE STREET NEW BEDFORD, MA 02740 |
| 8-150 | 131 RICKETSON ST | BERUBE WARREN E, 131 RICKETSON STREET NEW BEDFORD, MA 02744 |
| 8-158 | RICKETSON ST | FONTAINE RAYMOND J "TRUSTEE", FONTAINE CLAIRE A "TRUSTEE" 160 BELLEVUE ST NEW BEDFORD, MA 02744 |

May 25, 2021
Dear Applicant,

Please find below the List of Abutters within 100 feet of the property known as Victory Park (Map: 6, Lot: 1). The current ownership listed herein must be checked and verified by the City of New Bedford Assessor's Office. Following said verification, the list shall be considered a Certified List of Abutters.

Please note that multiple listed properties with identical owner name and mailing address shall be considered duplicates and shall require only 1 mailing. Additionally, City of New Bedford-Owned properties shall not require mailed notice.

| <u>Parcel</u> | <u>Location</u> | <u>Owner and Mailing Address</u> |
|---------------|-----------------|--|
| 8-159 | RICKETSON ST | DEJESUS CARMEN & DEJESUS JOSHUA, 170 BELLEVUE STREET NEW BEDFORD, MA 02744 |
| | | |
| | | |
| | | |
| | | |
| | | |
| | | |
| | | |
| | | |
| | | |
| | | |
| | | |
| | | |
| | | |

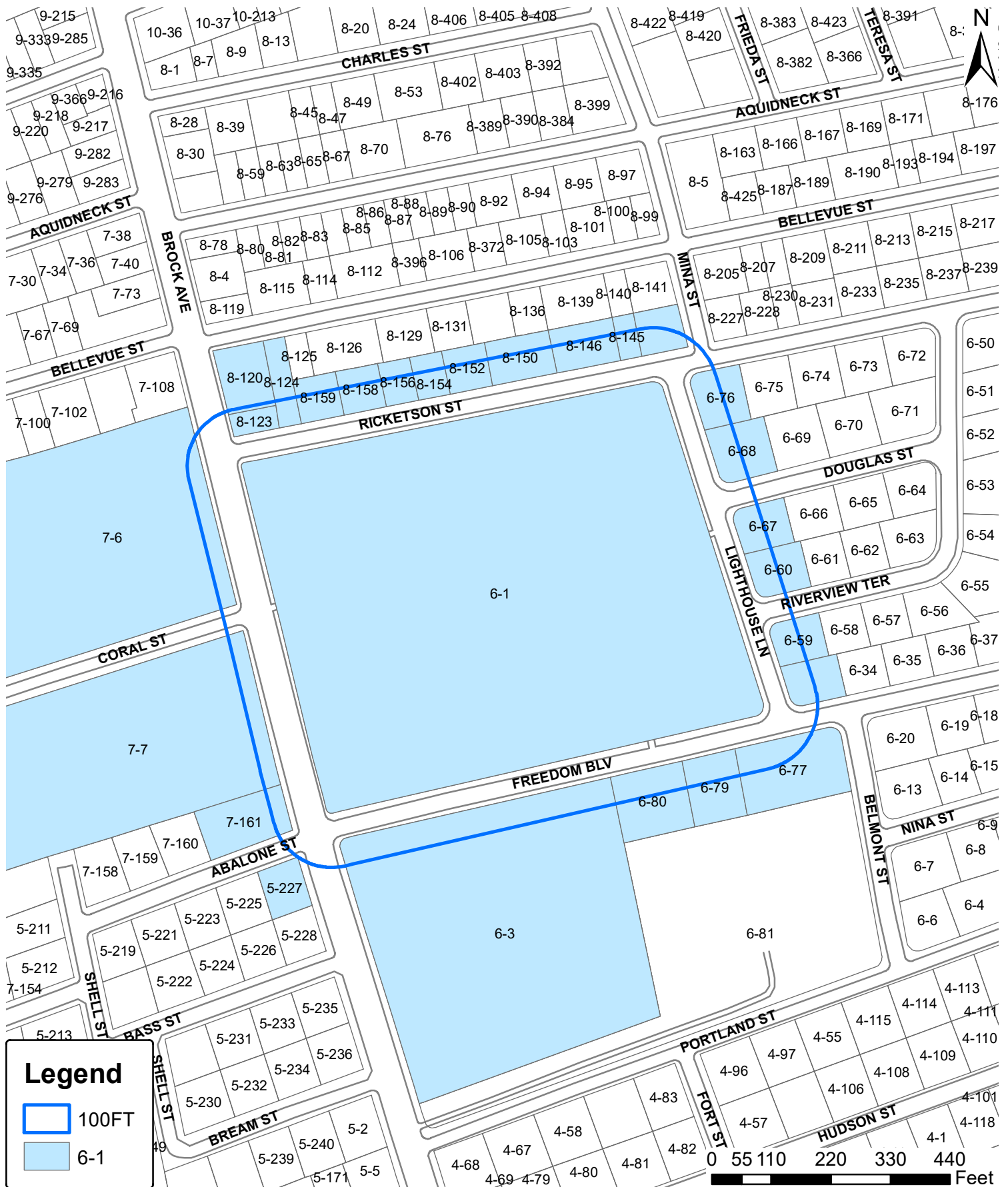

City of New Bedford, Massachusetts
Department of City Planning

Parcel within 100FT

