

# NOT FOR CONSTRUCTION - PERMIT DRAWINGS

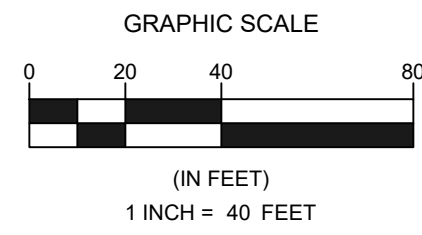

**LEGEND:**

- MLLW (-1.92)
- MLW (-1.79)
- MHW (+1.79)
- AHTL (+4.99)
- ELEVATION CONTOURS
- 100' WETLAND BUFFER ZONE
- FEMA FIRM MAP 25005C0393G
- NHESP HABITAT
- SHELLFISH SUITABILITY AREA

**PROJECT NOTES:**

1. WORK SHOWN AS PROPOSED WORK OUTSIDE OF THE SCOPE OF THIS NOTICE OF INTENT APPLICATION SHALL BE PERMITTED THROUGH THE STATE ENHANCED REMEDY PROCESS UNDER THE SUPERVISION OF MASSDEP AND USEPA.
2. PROJECT COMPONENTS INCLUDED UNDER SER REVIEW INCLUDE THE PROPOSED SHEETPILE BULKHEAD AND ASSOCIATED ANCHOR SYSTEM, PROPOSED PILE SUPPORTED CRANE & LANDING PADS, PROPOSED FENDER PILES, AND THE PROPOSED DREDGE TEMPLATE.
3. SEE NOI SUBMITTAL ATTACHMENTS FOR EPA AUTHORIZATION LETTER.
4. PROPOSED SITE PLAN SHOW WITH FUTURE FULL DEMOLISHED CONDITION OF THE BUILDING AREA FOR FUTURE USE AS VESSELS STORAGE AREA.

WORK FILED FOR UNDER THIS NOI

WORK PERMITTED THROUGH THE STATE ENHANCED REMEDY PROCESS

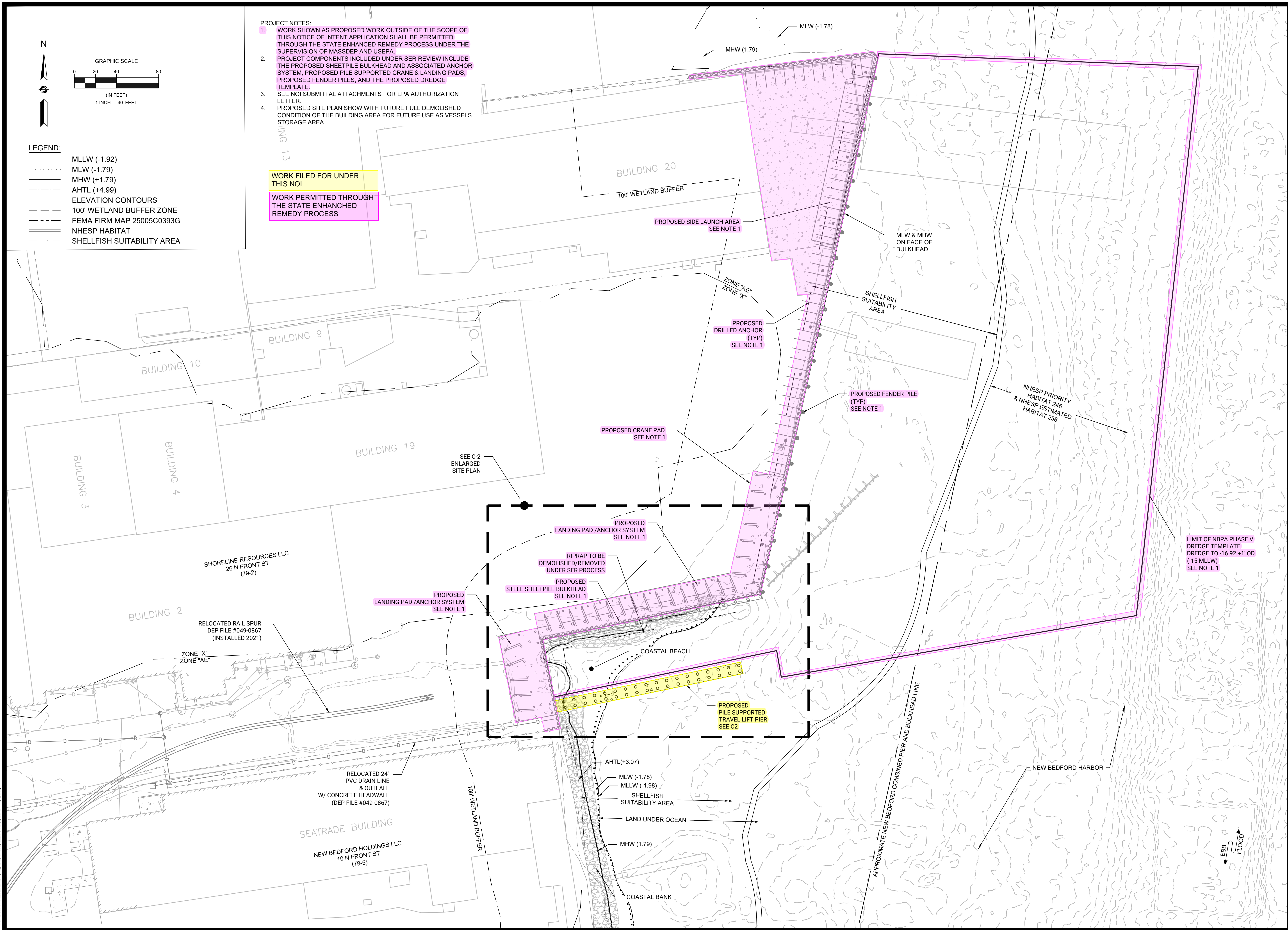

OWNER

CONSULTANT



FOTH INFRASTRUCTURE & ENVIRONMENT, LLC  
15 CREEK ROAD, MARION, MA 02738

**REVERE COPPER  
TRAVEL LIFT PIER  
NOTICE OF INTENT DRAWINGS  
137 POPE'S ISLAND  
NEW BEDFORD, MA 02740  
SHORELINE RESOURCES**

SEAL AND SIGNATURE

REVISIONS

NO.	DESCRIPTION

SHEET TITLE

**OVERALL  
SITE PLAN**

ISSUANCE

SCALE  
1" = 40'

DRAWN BY  
**PSR**

CHECKED BY  
**SEN**

PROJECT NO  
**0020S025**

DATE  
**02/16/2022**

SHEET NUMBER  
**C-1**

# NOT FOR CONSTRUCTION - PERMIT DRAWINGS

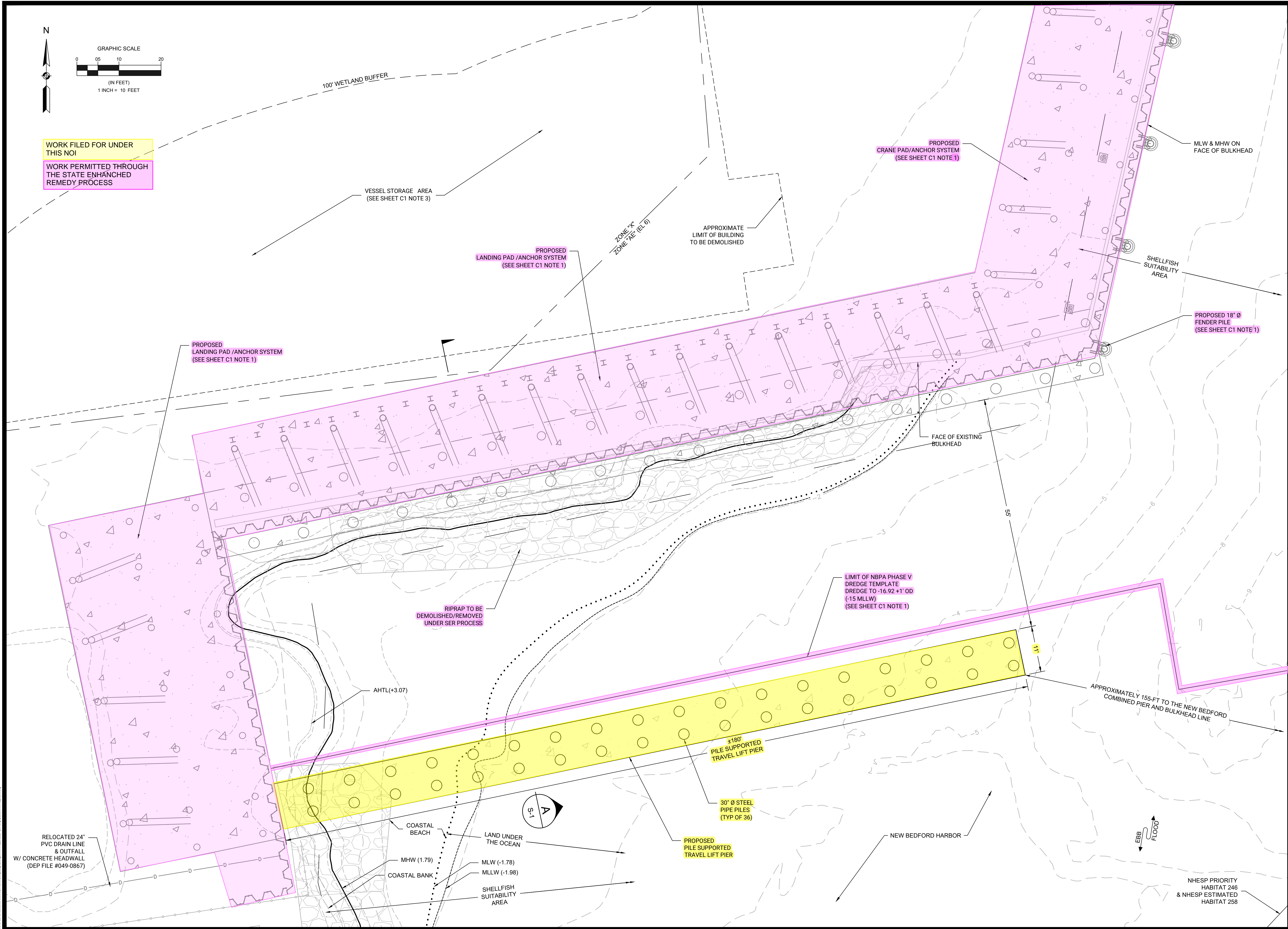

WORK FILED FOR UNDER THIS NOI  
 WORK PERMITTED THROUGH THE STATE ENHANCED REMEDY PROCESS

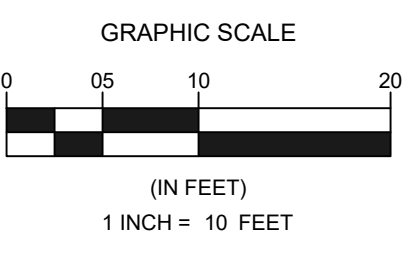

OWNER

CONSULTANT

FOTH INFRASTRUCTURE & ENVIRONMENT, LLC  
 15 CREEK ROAD, MARION, MA 02738

**REVERE COPPER  
 TRAVEL LIFT PIER  
 NOTICE OF INTENT DRAWINGS  
 137 POPE'S ISLAND  
 NEW BEDFORD, MA 02740  
 SHORELINE RESOURCES**

SEAL AND SIGNATURE

REVISIONS

NO.	DESCRIPTION

SHEET TITLE

**ENLARGED  
 SITE PLAN**

ISSUANCE

SCALE  
 1" = 10'

DRAWN BY  
 PSR

CHECKED BY  
 SEN

PROJECT NO  
 0020S025

DATE  
 02/16/2022

SHEET NUMBER

**C-2**

NHESP PRIORITY HABITAT 246 & NHESP ESTIMATED HABITAT 258

