

DETAIL OF PLANTING AREA - NOT TO SCALE

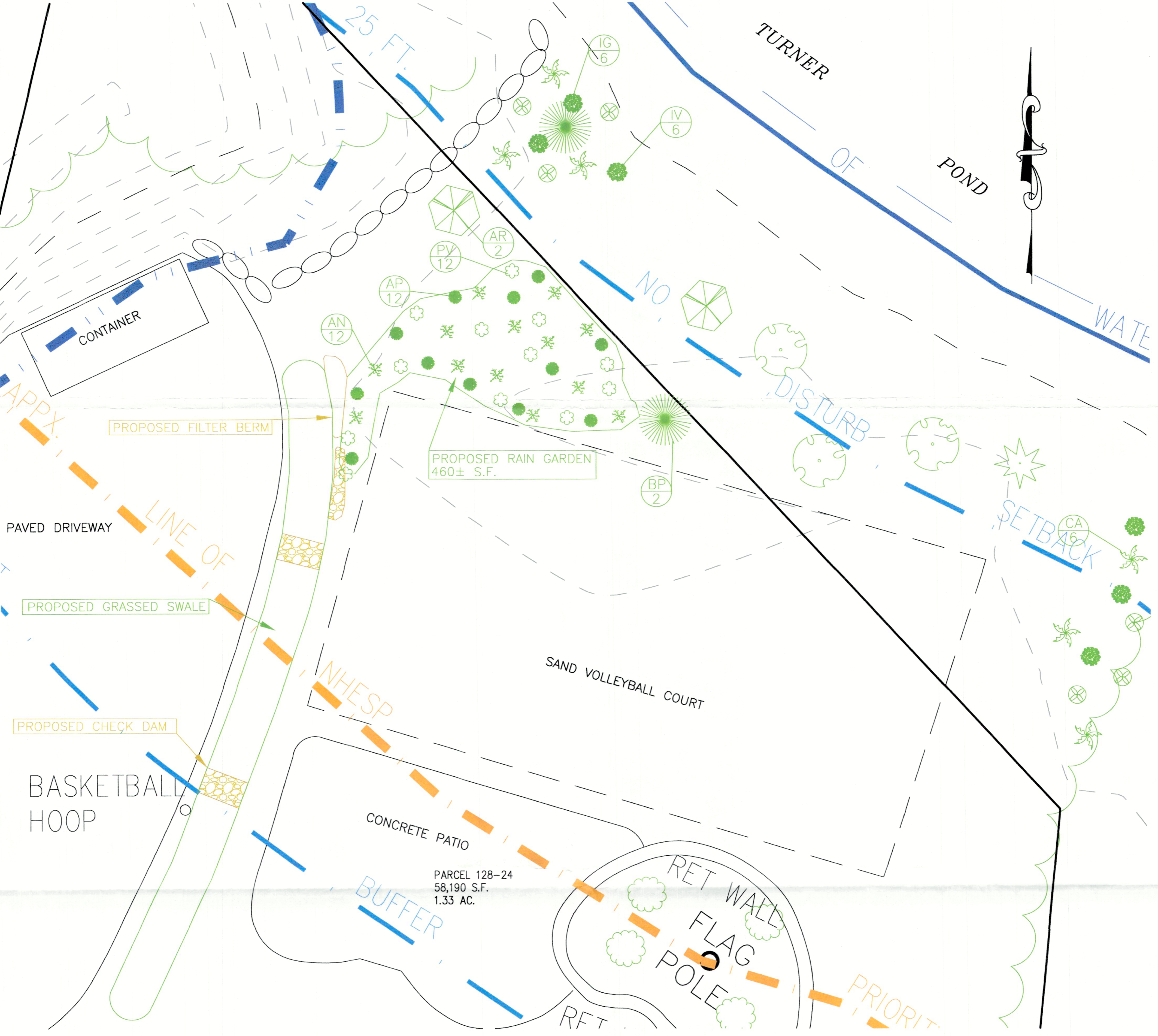

PLANTING KEY

BOTANICAL NAME	COMMON NAME	QTY.	SIZE
HERBACEOUS SPECIES			
PASCIVM VIRGETUM	SWITCH GRASS	12	1 GAL.
ADIANTUM PEDANTUM	MAIDENHAIR FERN	12	1 GAL.
ASTER NOVAE-ANGLIAE (MAY SUBSTITUTE)	NEW ENGLAND ASTER	12	1 GAL.
SHRUB SPECIES			
ILEX GLABRA	INKBERRY	6	3 GAL.
ILEX VERTICILLATA	WINTERBERRY	6	3 GAL.
CORNUS AMOMUM	SILKY DOGWOOD	6	3 GAL.
TREE SPECIES			
BETULA PAPIRIFERA	PAPER BIRCH	2	4-6'
ACER RUBRUM	RED MAPLE	2	4-6'

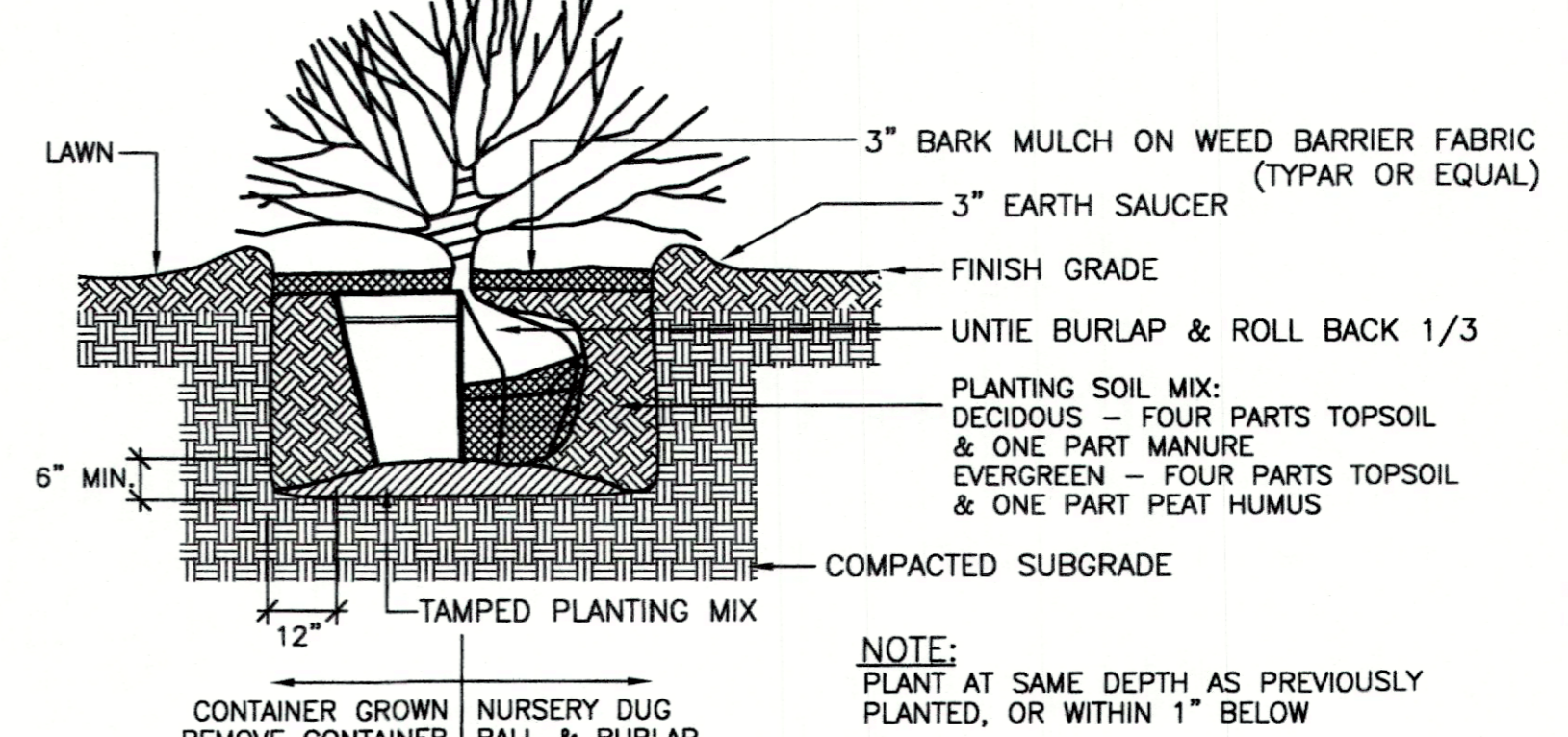
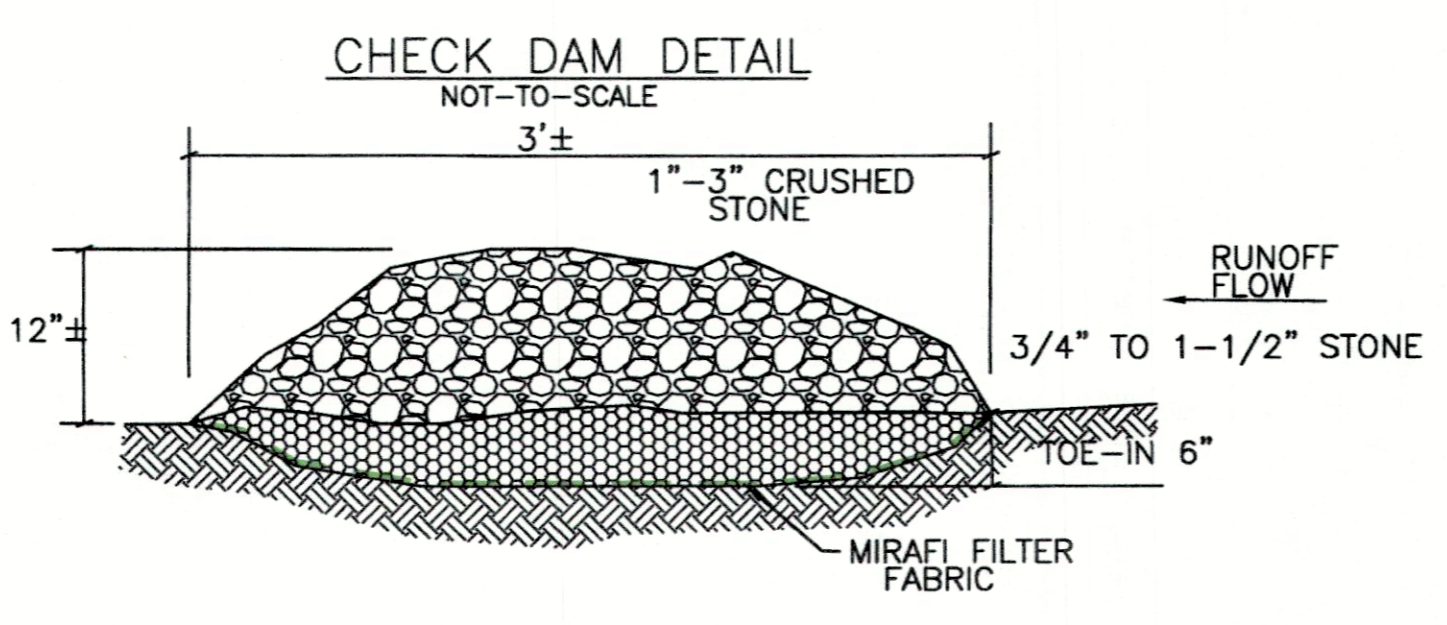

BIORETENTION MAINTENANCE SCHEDULE

ACTIVITY	TIME OF YEAR	FREQUENCY
INSPECT AND REMOVE TRASH	YEAR ROUND	MONTHLY
MULCH	SPRING	ANNUALLY
REMOVE DEAD VEGETATION	FALL OR SPRING	ANNUALLY
REPLACE DEAD VEGETATION	SPRING	ANNUALLY
PRUNE	SPRING OR FALL	ANNUALLY
REPLACE MEDIA AND ALL VEGETATION	LATE SPRING	AS NEEDED
	EARLY SUMMER	

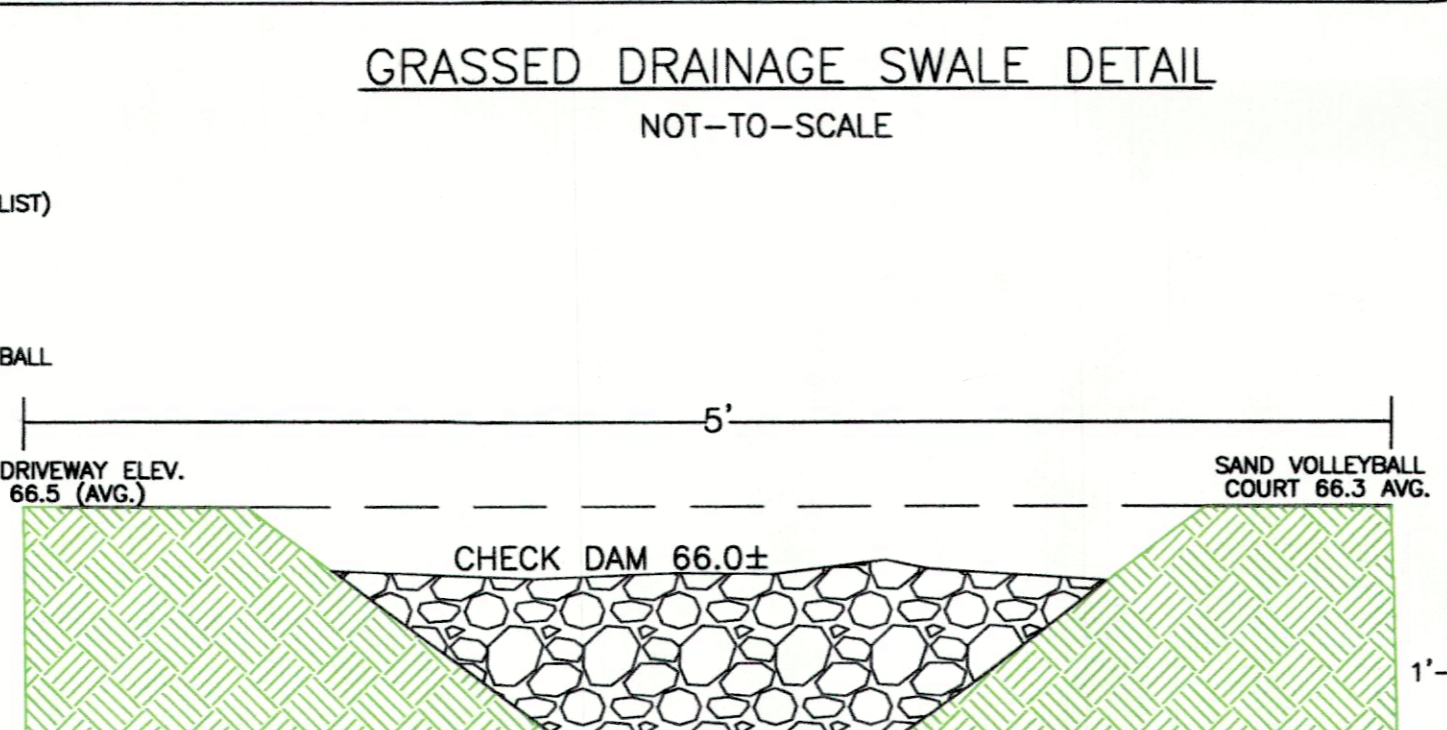
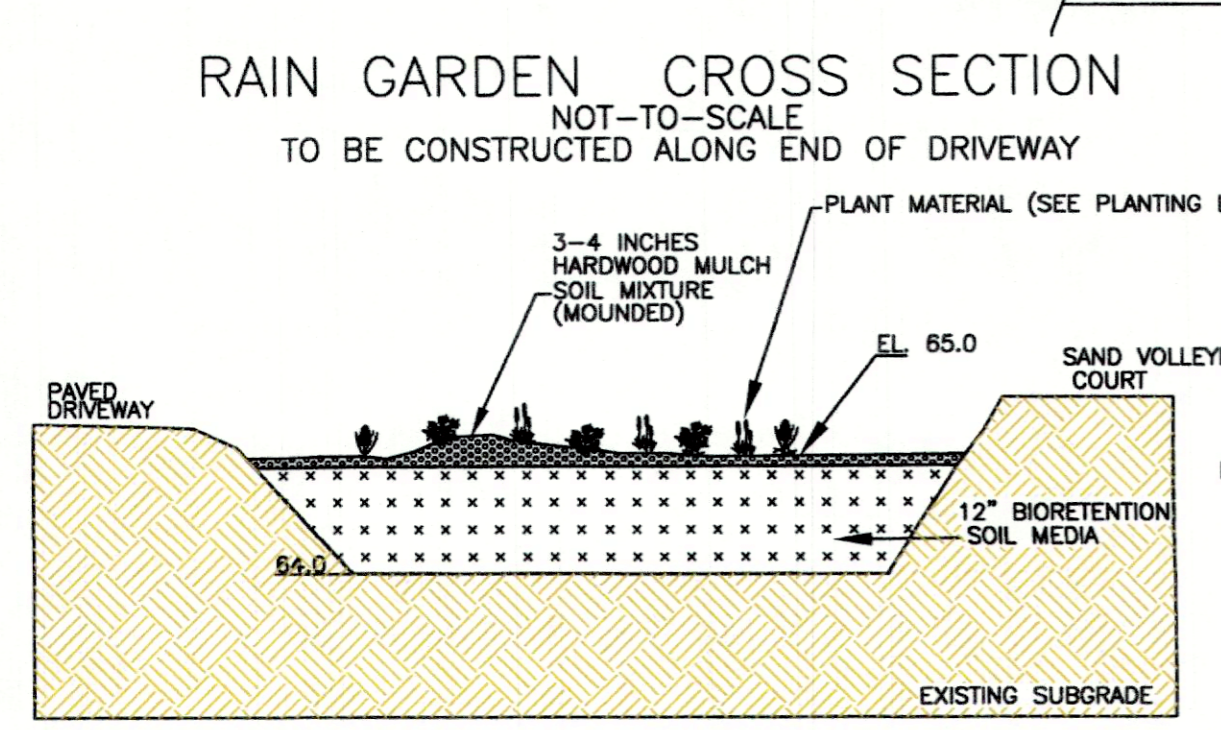
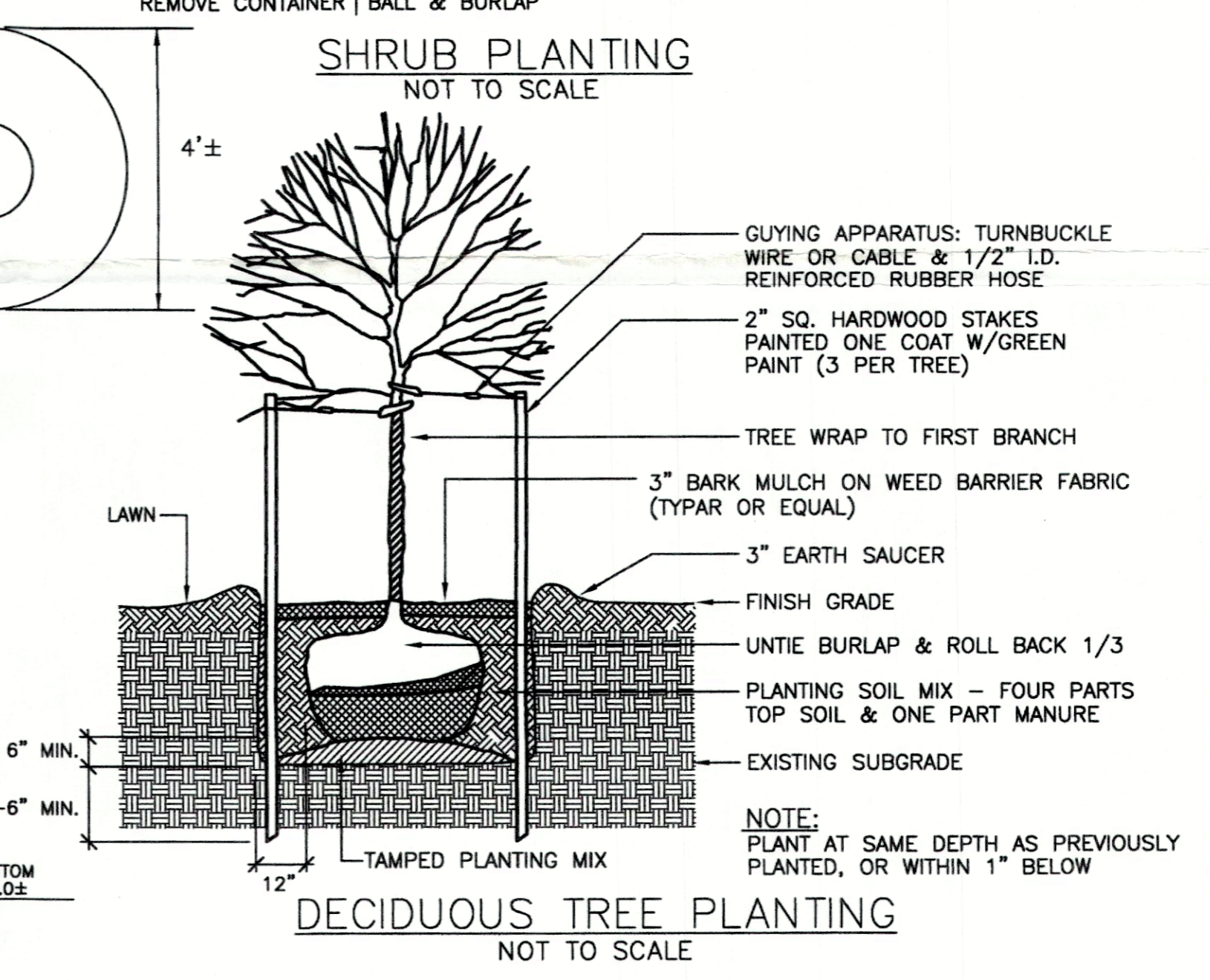
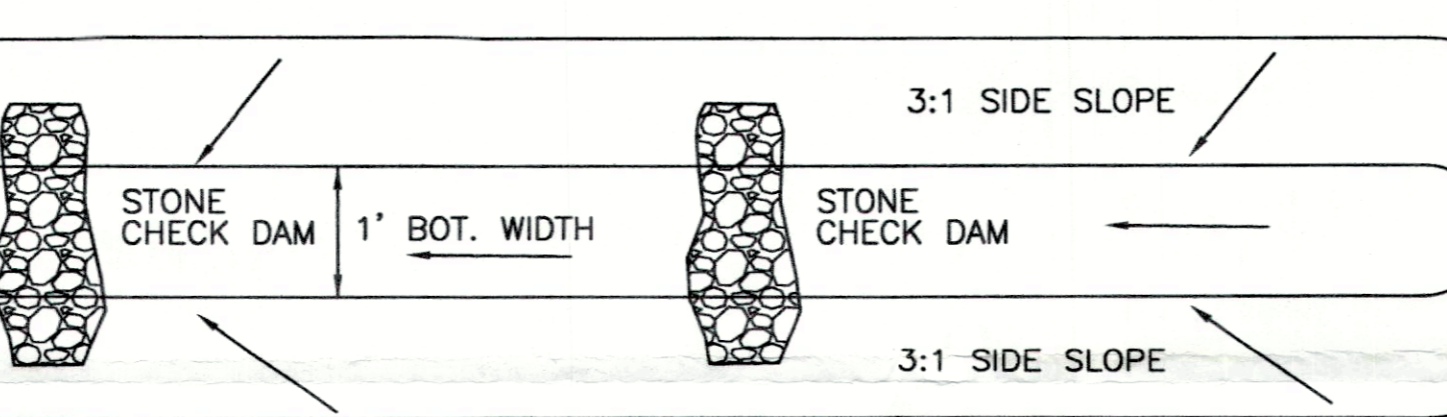

DIG-SAFE
ANYONE WHO EXCAVATES ON PUBLIC OR PRIVATE PROPERTY MUST NOTIFY UTILITY COMPANIES AT LEAST 72 HOURS PRIOR TO DIGGING, EXCEPT IN AN EMERGENCY. THE EXPENSE OF REPAIRING DAMAGED FACILITIES GOES TO THOSE RESPONSIBLE FOR DAMAGING THEM. NOTIFY DIG-SAFE AT 1-888-344-7233 (1-888-DIG-SAFE) TO MARK FACILITIES ON THE GROUND PRIOR TO EXCAVATING

MITIGATION PLAN
SHOWING PROPOSED PLANTINGS
PARCEL 128-24

PROJECT SITE: **2044-2046 SHAWMUT AVENUE**
NEW BEDFORD, MASSACHUSETTS 02746

CLIENT INFO: **ALLISON VIGNA & IAN YATES**
2044 & 2046 SHAWMUT AVENUE
NEW BEDFORD, MASSACHUSETTS 02746

DRAWN BY:	DATE:	REV.	DATE	DESCRIPTION	BY	APP.
TDR/WJM	SEPTEMBER 16, 2022					
DESIGNED BY:	PROJECT NUMBER					
811-01-01						
CHECKED BY:	DRAWING SCALE:					
JP	AS NOTED					
APPROVED BY:	SHEET ID					
WJM	PLANTING PLAN					

REGISTERED LAND SURVEYOR *William J. McGovern* DATE *September 16, 2022*

ZLS
ZENITH LAND SURVEYORS, LLC
1162 ROCKDALE AVENUE
NEW BEDFORD, MA 02740
(508) 995-0100