

- NOTES:**
1. THE PURPOSE OF THIS PLAN IS FOR SUBMISSION TO THE NEW BEDFORD CONSERVATION COMMISSION REQUESTING A CERTIFICATE OF COMPLIANCE FOR WORK AUTHORIZED BY AN ORDER OF CONDITIONS ISSUED UNDER DEP FILE No. SE049-0888.
  2. AS-BUILT CONDITIONS INFORMATION IS BASED FROM AN ACTUAL ON THE GROUND FIELD SURVEY PERFORMED BY G.A.F. ENGINEERING, INC., ON NOVEMBER 21, 2022.

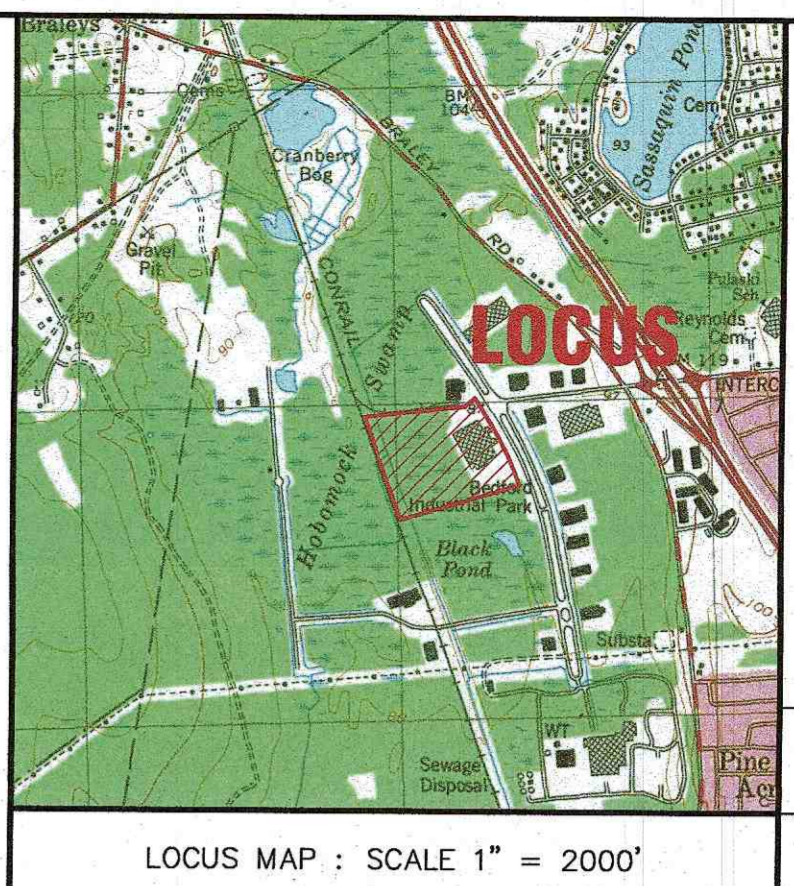
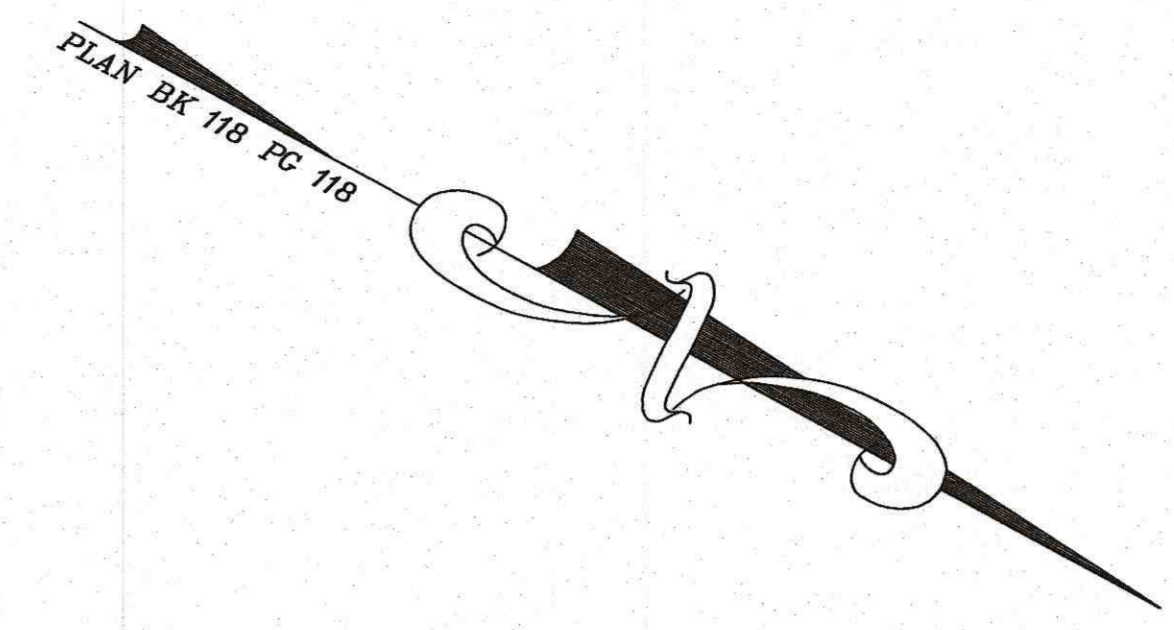

**LOT DATA:**  
 ASSESSORS MAP 136, LOT 331  
 ADDRESS: 215 DUCHAINE BOULEVARD

OWNER/APPLICANT:  
 ACUSHNET COMPANY  
 P.O. BOX 965  
 FAIRHAVEN, MA 02719

**ZONING DATA:**  
 ZONE: INDUSTRIAL C (IC)

SETBACKS:  
 MINIMUM LOT AREA: 0  
 MINIMUM FRONTAGE: 0  
 MINIMUM FRONT SETBACK: 25'  
 MINIMUM SIDE SETBACK: 25'  
 MINIMUM REAR SETBACK: 25'  
 MAXIMUM BUILDING HEIGHT: 100'  
 MAXIMUM BUILDING COVERAGE: 50%

EX. BUILDING COVERAGE=13.9%  
 PROP. BUILDING COVERAGE=14.0%

**FLOOD ZONE DATA:**  
 THE PROJECT IS WITHIN FLOOD ZONE X.  
 REFER TO THE F.E.M.A. FLOOD INSURANCE  
 RATE MAP PANEL NUMBER 25005C0377G,  
 DATED: JULY 6, 2021.

DATE: NOV. 22, 2022	BY: JPM	DESCRIPTION:
DRAWN BY: JPM	DATE:	
CHECKED BY: WFM	REV.:	
JOB NO.: 22-9846	DATE:	
SCALE: 1" = 20'	DATE:	

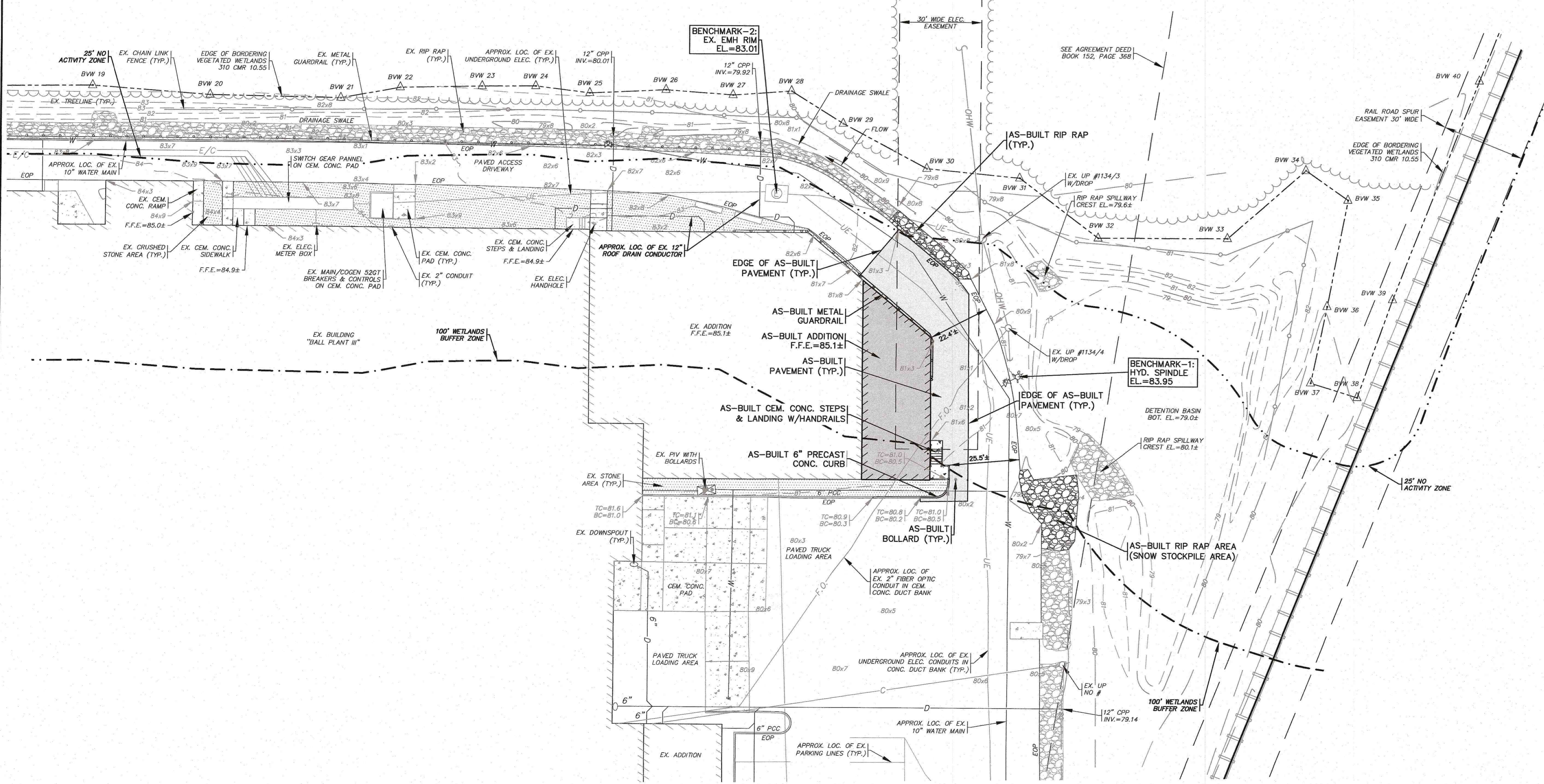

**LEGEND**

EXISTING	DESC.
80	CONTOURS
83x5	SPOT GRADES
(Symbol)	WETLANDS
(Symbol)	25' NO ACTIVITY ZONE
(Symbol)	100' BUFFER ZONE
(Symbol)	F.E.M.A. FLOOD ZONE
(Symbol)	CATCH BASIN (CB)
(Symbol)	DRAIN MANHOLE (DMH)
(Symbol)	OVERHEAD WIRES
(Symbol)	UTILITY POLE
(Symbol)	GUY POLE
(Symbol)	WATER GATE VALVE
(Symbol)	WATER SHUTOFF/CURB STOP
(Symbol)	HYDRANT
(Symbol)	WATER LINE
(Symbol)	UNDERGROUND ELECTRIC
(Symbol)	FIBER OPTIC CONDUIT
(Symbol)	SEWER MANHOLE (SMH)
(Symbol)	SEWER LINE
(Symbol)	FORCE MAIN
(Symbol)	TREE/BRUSH LINE
(Symbol)	LIGHT POST
(Symbol)	GAS LINE
(Symbol)	GAS GATE/VALVE
(Symbol)	GAS SHUTOFF
(Symbol)	GAS METER
(Symbol)	FENCE
(Symbol)	SIGN
(Symbol)	BOUND
(Symbol)	STONE WALL
(Symbol)	REBAR

APPROVED BY: *[Signature]*

**G.A.F. ENGINEERING, INC.**  
 PROFESSIONAL ENGINEERS & LAND SURVEYORS  
 266 MAIN STREET - WARREN, MA 02571  
 TEL: (508) 295-6600 FAX: (508) 295-6634  
 E-MAIL: info@gafenginc.com

**PLAN TO ACCOMPANY CERTIFICATE OF COMPLIANCE FOR SE049-0888**  
 215 DUCHAINE BLVD. NEW BEDFORD, MA

PREPARED FOR:  
**ACUSHNET COMPANY**  
 FAIRHAVEN, MA  
 P.O. BOX 965

JOB NO.: 22-9846  
 DWG. 1 OF 1

H:\GAF DRAWINGS\2022 DRAWINGS\22-9846 (ACUSHNET COMPANY) 3P (1)\22-9846.dwg\22-9846-AS-BUILD.dwg