



CITY OF NEW BEDFORD
JONATHAN F. MITCHELL, MAYOR

DEPARTMENT OF INSPECTIONAL SERVICES
133 WILLIAM STREET - ROOM 308
NEW BEDFORD, MA 02740

New Bedford Comprehensive Zoning Code Review

Code of Ordinances – Chapter-9

510 BELLEVILLE AVE – PLOT: 100 – LOT: 115 – ZONED DISTRICT: IB

SITE PLAN REVIEW Required from the PLANNING BOARD

Zoning Code Review as follows:

SITE PLAN REVIEW

❖ SECTIONS

- **5400 SITE PLAN REVIEW**
 - **5427 COMMERCIAL OR INDUSTRIAL GROUND SIGNS**
 - **5410 THRU 5490**
-

IX. HOMEOWNER LICENSE EXEMPTION

Supplement #1

The current exemption for "homeowner" was extended to include owner-occupied dwellings of two units or less and to allow such homeowners to engage an individual for hire who does not possess a license, provided that the owner acts as supervisor. (State Building Code Section 110.5)

DEFINITION OF HOMEOWNER:

Person(s) who own a parcel of land on which he/she resides or intends to reside, on which there is, or is intended to be, a one to two family dwelling, attached or detached structures accessory to such use and /or farm structures. A person who constructs more than one home in a two-year period shall not be considered a homeowner. Such "homeowner shall submit to the Building Official, on a form acceptable to the Building Official, that he/she shall be responsible for all such work performed under the building permit. (Section 110.5)

The undersigned "homeowner assumes responsibility for compliance with the State Building Code and other applicable codes, ordinance, rules and regulations, and will comply with the City of New Bedford Building Department minimum inspection procedures and requirements.

HOMEOWNERS SIGNATURE _____

X. CONSTRUCTION DEBRIS DISPOSAL

Supplement #2

In accordance with provisions of Massachusetts General Law C40, S54, debris resulting from this work shall be disposed of in a properly licensed solid waste disposal facility as defined by Massachusetts General Law C111, S150A

The debris will be disposed of in:

Michael Frates (Location of Facility)

Date

9-2-2014

XI. HOME IMPROVEMENT CONTRACTOR LAW AFFIDAVIT

(Residential Use Only) Supplement to Permit Application

Supplement #3

MGLc. 142 A requires that the "reconstruction, alteration, renovation, repair, modernization, conversion, improvement, removal, demolition, or construction of an addition to any pre-existing owner-occupied building containing at least one but not more than four dwelling units... or to structures which are adjacent to such residence of building" be conducted by registered contractors, with certain exceptions, along with other requirements.

Type of Work:

SIGN

Est. Cost

\$2500

Address of Work

510 Belleville Ave

Owner Name:

Michael Frates

Date of Permit Application:

I hereby certify that: Registration is not required for the following reason(s):

Work excluded by law

Job under \$1,000

Building not owner-occupied

Owner obtaining own permit

Other (specify):

Notice is hereby given that:

OWNERS OBTAINING THEIR OWN PERMIT OR EMPLOYING UNREGISTERED CONTRACTORS FOR APPLICABLE HOME IMPROVEMENT WORK DO NOT HAVE ACCESS TO THE ARBITRATION PROGRAM OF GUARANTY FUND UNDER MGLC. 142A.

signed under penalties of perjury:

I hereby apply for a permit as the agent of the owner:

Date

OR:

Contractor Signature

Registration No.

Notwithstanding the above notice, I hereby apply for a permit as the owner of the above property:

Date

Owner Signature

XII. BUILDING COMMISSIONERS REVIEW COMMENTS AND CONDITIONS

C. Building Permit Rejected

☒ PLANNING BOARD

Reason For Rejection:

"SEE ATTACHED"

Fee

Permit #

13

Comments and Conditions:

Signed

Lanny N. Romanowicz

Date:

2/6

20 18

Title

Building Commissioner

Not valid unless signed (not stamped) by Building Commissioner



City of New Bedford, Massachusetts
Building Department
Application for Plan Examination
and Building Permit

FOR BUILDING DEPT. USE
DATE RECEIVED: _____
RECEIVED BY: _____
ISSUED BY: _____

IMPORTANT — COMPLETE ALL ITEMS — MARK BOXES WHERE APPLICABLE — PRINT

(AT LOCATION) 510 BELLEVILLE AVE
(NO) (STREET)
BETWEEN EARLE AND HATHAWAY
(CROSS STREET) (CROSS STREET)
PLOT 100 LOT 115 DISTRICT _____ ACCEPTED STREET _____
PLANS FILED ☐ YES ☐ NO

II. TYPE AND COST OF BUILDING — all applicants complete parts A through D — PRINT

A. TYPE OF IMPROVEMENT

- 1 ☐ New Building
2 ☐ Addition (If residential, enter number of new housing units added, if any, in Part D, 14)
3 ☐ Alteration (If residential, enter number of new housing units added, if any, in Part D, 14)
4 ☒ Repair, replacement
5 ☐ Demolition (If multifamily residential, enter number of units in building in Part D, 14, if non-residential, indicate most recent use checking D-18 - D-32)
6 ☐ Moving (refocation)
7 ☐ Foundation only

D1 PROPOSED USE — For demolition most recent use

Residential

- 13 ☐ One family
14 ☐ Two or more family — Enter number of units _____
15 ☐ Transient hotel, motel, or dormitory — Enter number of units _____
16 ☒ Garage
17 ☐ Carport
18 ☐ Other — Specify _____

Nonresidential

- 19 ☐ Amusement, recreational
20 ☐ Church, other religious
21 ☐ Industrial
22 ☐ Parking garage
23 ☒ Service station, repair garage
24 ☐ Hospital, institutional
25 ☐ Office, bank, professional
26 ☐ Public utility
27 ☐ School, library, other educational
28 ☐ Stores, mercantile
29 ☐ Tanks, towers
30 ☐ Funeral homes
31 ☐ Food establishments
32 ☐ Other — Specify _____

B. OWNERSHIP

- 8 ☒ Private (individual, corporation, nonprofit institution, etc.)
9 ☐ Public (Federal, State, or local government)

D2. Does this building contain asbestos?

☐ YES ☒ NO If yes complete the following:
Name & Address of Asbestos Removal Firm: _____

Submit copy of notification sent to DEQE and the State Dept. of Labor & Industries and results of air sample analysis after asbestos removal is completed

C. COST

10. Cost of construction \$ 2500.00 (Omit cents)
To be installed but not included in the above cost
a. Electrical
b. Plumbing
c. Heating, air conditioning
d. Other (elevator, etc.)
11. TOTAL VALUE OF CONSTRUCTION
12. TOTAL ASSESSED BLDG. VALUE

D3. Non-residential — Describe in detail proposed use of buildings, e.g., food processing plant, machine shop, laundry building at hospital, elementary school, secondary school, college, parochial school, parking garage for department store, rental office building, office building at industrial plant. If use of existing building is being changed, enter proposed use.

III. SELECTED CHARACTERISTICS OF BUILDING —

For new buildings complete part E through I. For demolition, complete only parts G; H & I.
For all others, (additions, alterations, repair, moving, foundation), complete E through I.

E. PRINCIPAL TYPE OF FRAME

- 33 ☐ Masonry (wall bearing)
34 ☐ Wood frame
35 ☐ Structural steel
36 ☐ Reinforced concrete
37 ☒ Other — Specify SIGN

G. TYPE OF SEWAGE DISPOSAL

- 43 ☒ Public or private company
44 ☐ Private (septic tank, etc.)

H. TYPE OF WATER SUPPLY

- 45 ☐ Public or private company
46 ☐ Private (well, cistern)

F. PRINCIPAL TYPE OF HEATING FUEL

- 38 ☒ Gas
39 ☐ Oil
40 ☐ Electricity
41 ☐ Coal
42 ☐ Other — Specify _____

I. TYPE OF MECHANICAL

- Is there a fire sprinkler system?
47 ☐ YES 48 ☐ NO
Will there be central air conditioning?
49 ☐ Yes 50 ☐ No
Will there be an elevator?
51 ☐ Yes 52 ☐ No

J. DIMENSIONS

- 53 Number of stories _____
54 Height _____
55 Total square feet of floor area, all floors based on exterior dimensions _____
56 Building length _____
57 Building width _____
58 Total sq. ft. of bldg. footprint _____
59 Front lot line width _____
60 Rear lot line width _____
61 Depth of lot _____
62 Total sq. ft. of lot size _____
63 % of lot occupied by bldg. (58+62) _____
64 Distance from lot line (front) _____
65 Distance from lot line (rear) _____
66 Distance from lot line (left) _____
67 Distance from lot line (right) _____

COPY

158

6-ft

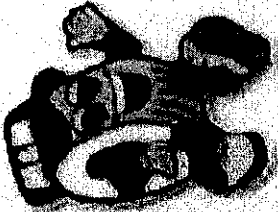

MM

used tire Superstore

MARTIN SQ.

104

144.20
382.59

350.0
250.00

115
22.82
62.14

105
22.83
62.16

106

145.25
395.45

108

1A - 43.84 R.
55.502

104

46.93
12.776

DAVIS

ST.

IND. B.

IND. B.

BUS.
101.55

7

39.08
106.39

50.0	45.45	50.0	40	40	50
97	98	9	10	94	95
0.28	0.26	90.2	90.32	90.32	90.32
16.58	14.90	16.56	13.27	13.27	16.59

AVE.

286.2

232.84

148.00

73.88

31.48

150.00

100.00

100.0

72.07

1000

112.85

18.6

60.24

123.78

202.60

36.84

40.12

15.43

Google

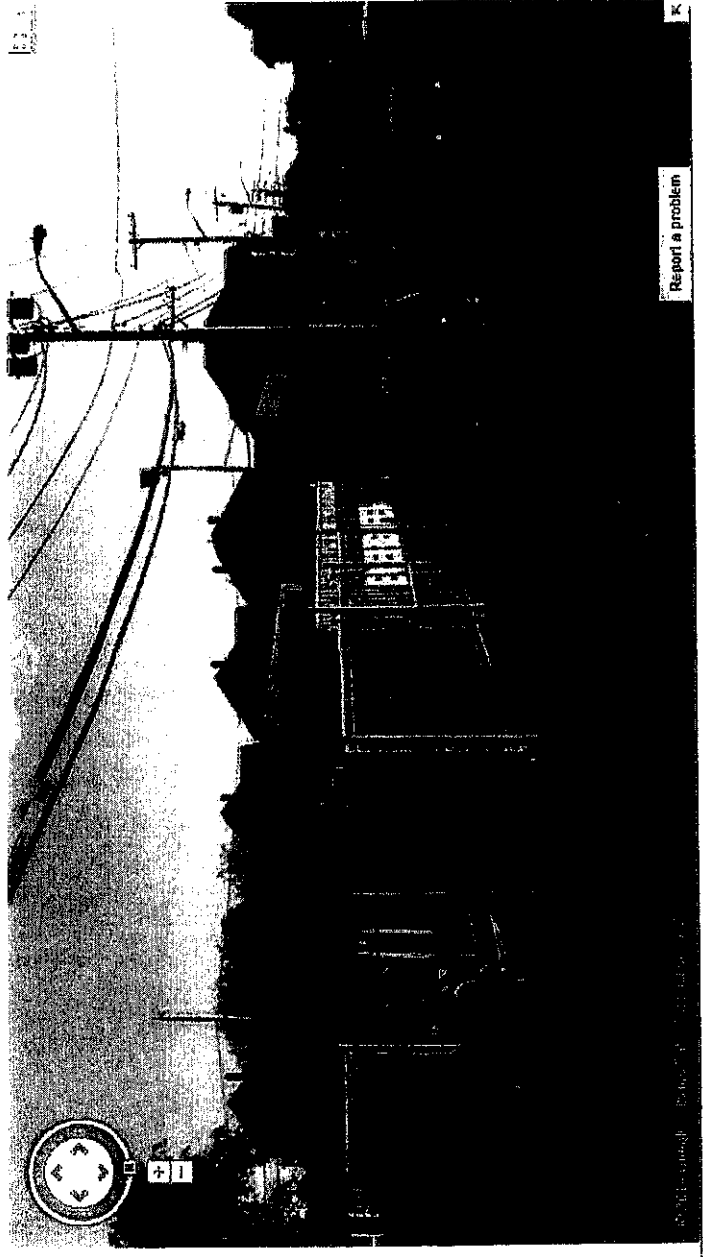

W
L

To see all the details that are visible on the screen, use the "Print" link next to the map.

Location: 510 BELLEVILLE AVE

Parcel ID: 100 115

Zoning: IB

Fiscal Year: 2016

Current Owner Information:

TIRES R US, LLC

510 BELLEVILLE AVE

NEW BEDFORD, MA 02746

Current Sales Information:

Sale Date:

11/20/2014

Sale Price:

\$100.00

Legal Reference:

11230-29

Grantor:

FRATES, MICHAEL A.

Card No. 1 of 1

This Parcel contains 0.285 acres of land mainly classified for assessment purposes as AUTO S&S with a(n) COMMERCIAL GARAGE style building, built about 1956, having Conc Blk exterior, Rolled Composition roof cover and 5119 Square Feet, with 1 unit(s), total room(s), total bedroom(s) 0 total bath(s), 0 3/4 baths, and 1 total half bath(s).

Building Value:

136500

Land Value:

110100

Yard Items Value:

9500

Total Value:

256100

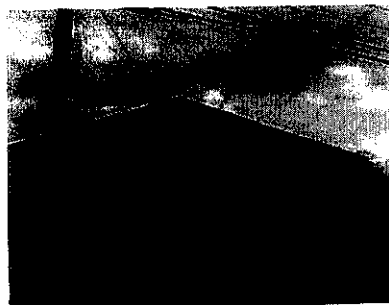
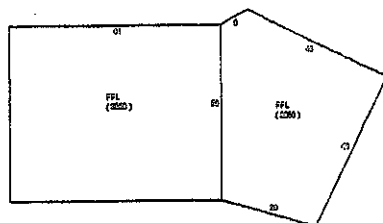

Fiscal Year 2016

Tax Rate Res.: 16.49

Tax Rate Com.: 35.83

Property Code: 330

Total Bldg Value: 136500

Total Yard Value: 9500

Total Land Value: 110100

Total Value: 256100

Tax: \$9,176.06

Fiscal Year 2015

Tax Rate Res.: 15.73

Tax Rate Com.: 33.56

Property Code: 330

Total Bldg Value: 122600

Total Yard Value: 9500

Total Land Value: 110100

Total Value: 242200

Tax: \$8,128.24

Fiscal Year 2014

Tax Rate Res.: 15.16

Tax Rate Com.: 31.08

Property Code: 330

Total Bldg Value: 119900

Total Yard Value: 9500

Total Land Value: 116200

Total Value: 245600

Tax: \$7,633.25

Disclaimer: Classification is not an indication of uses allowed under city zoning.
This information is believed to be correct but is subject to change and is not warranted.

- (a) Describe the methods to be used during construction to control erosion and sedimentation through use of sediment basins, mulching, matting, temporary vegetation, or covering of soil stockpiles. Describe the approximate size and location of portion of the parcel to be cleared at any given time and length of time of exposure.
- (b) Describe the phased construction, if any, of any required public improvements, and how such improvements are to be integrated into site development.

(Ord. of 12-23-03, § 1)

5360. Conditions. Special permits may be granted with such reasonable conditions, safeguards, or limitations on time or use, including performance guarantees, as the special permit granting authority may deem necessary to serve the purposes of this Ordinance.

(Ord. of 12-23-03, § 1)

5370. Lapse. Special permits shall lapse if a substantial use thereof or construction thereunder has not begun, except for good cause, within twelve (12) months following the filing of the special permit approval (plus such time required to pursue or await the determination of an appeal referred to in M.G.L.A. c. 40A, § 17, from the grant thereof) with the City Clerk.

(Ord. of 12-23-03, § 1)

5380. Regulations. The special permit granting authority may adopt rules and regulations for the administration of this Section.

(Ord. of 12-23-03, § 1)

5390. Fees. The special permit granting authority may adopt reasonable administrative fees and technical review fees for applications for special permits.

(Ord. of 12-23-03, § 1)

State law reference— Special permits, M.G.L.A. c. 40A, § 9.

5400. - SITE PLAN REVIEW.

5410. Purpose. The purpose of this Section is to provide for individual detailed review of development proposals which have an impact on the natural or built environment of the City in order to promote the health, safety and general welfare of the community; to ensure adequate parking, safe and accessible pedestrian and vehicular circulation; and to minimize traffic impact on City streets.

(Ord. of 12-23-03, § 1)

5420. Applicability. The following types of activities and uses require site plan review by the Planning Board:

5421. Any new industrial or commercial construction or expansion over two thousand (2,000) gross square feet or any new industrial or commercial construction or expansion requiring more than five (5) additional parking spaces;

5422. New multiple-family residential construction of three (3) or more units or expansion of existing multifamily residential structures resulting in the creation of one or more additional units.

5423. Any new construction or expansion of existing construction where a drive-thru window for any service including self-service is proposed; and any expansion of a structure presently containing a drive-thru; or any facility currently containing a drive-thru, at which the owner or operator of the drive-thru is altered or changed; or at which the drive-thru is closed for a period of 10 days or more and to be reopened.

5424. Any residential subdivision which is submitted under the subdivision control process;

5425. New industrial or commercial construction or additions less than two thousand (2,000) square feet if requiring a new curb cut or driveway or if substantially affecting existing internal circulation.

5426. Driveways in residential areas which require more than one new curb cut.

5427. Commercial or industrial ground signs.

(Ord. of 12-23-03, § 1; Ord. of 12-31-08, § 1)

5430. Procedures. Applicants for site plan approval shall submit seventeen (17) copies of the site plan to the Planning Board for distribution to City departments and commissions for their review. The Planning Board shall review and act upon the site plan, with such conditions as may be deemed appropriate and notify the applicant of its decision. In the event two (2) meetings have lapsed after the application for site plan approval is filed, without the

Planning Board taking action on said site plan said Applicant may file a statement with the Board that the Board has received complete information in accordance with this Ordinance and has had adequate time to consider the Site Plan. Upon receiving said statement, the Planning Board shall act on said Site Plan at its next meeting, if said Board determines that the Board has, in fact, received complete information in accordance with this Ordinance. The decision of the Planning Board shall be a vote of a majority of the members of the Planning Board and shall be in writing. No building permit, for activities requiring site plan approval, shall be issued by the Inspector of Buildings without the written approval of the site plan by the Planning Board.

5431. Application for Building Permit. An application for a building permit to perform work as set forth in Section 5410 available as of right shall be accompanied by an approved site plan.

5432. Application for Special Permit or Variance. An application for a special permit or a variance to perform work as set forth in Section 5420 shall be accompanied by an approved site plan; in the alternative, any special permit or variance granted for work set forth in Section 5420 shall contain the following condition and cause the same to be written on such special permit or variance:

The work described herein requires the approval of a site plan by the New Bedford Planning Board pursuant to Section 5400 of the Zoning Ordinance. Any conditions imposed in such site plan approval shall also be conditions of this special permit/variance.

5433. Where the Planning Board approves a site plan "with conditions", and said approved site plan accompanies a special permit or variance application to the Board of Appeals, the conditions imposed by the Planning Board shall be incorporated into the issuance, if any, of a special permit or variance by the Board of Appeals.

5434. Where the Planning Board serves as the special permit granting authority for proposed work, it shall consolidate its site plan review and special permit procedures.

5435. The applicant may request, and the Planning Board may grant by majority vote of its' membership, an extension of the time limits set forth herein.

5436. No deviation from an approved site plan shall be permitted without modification thereof.

5437. Site plan approval does not constitute a certification that the proposed plan conforms to applicable zoning regulations, wetland regulations and/or any other City, state or federal requirements that must be obtained prior to implementation the of elements of the site plan.

(Ord. of 12-23-03, § 1)

5440. **Preparation of Plans.** Applicants are invited to submit a pre-application sketch of the proposed project to the Planning Department and are encouraged to schedule a pre-submission meeting with the Planning Department. Site Plans shall be submitted on 24-inch by 36-inch sheets. Plans shall be prepared by a Registered Professional Engineer, Registered Land Surveyor, Architect, or Landscape Architect, as appropriate. Dimensions and scales shall be adequate to determine that all requirements are met and to make a complete analysis and evaluation of the proposal. All plans shall have a minimum scale of 1" = 40'.

(Ord. of 12-23-03, § 1)

5450. **Contents of Plan.** The contents of the site plan are as follows:

5451. Plan sheets prepared at a scale of one inch equals forty (40) feet or such other scale as may be approved by the Planning Board. The plans are as follows:

5451.a. Site layout, which shall contain the boundaries of the lot(s) in the proposed development, proposed structures, general circulation plan for vehicles and pedestrians, drive-thru windows, curb cut locations, parking, fences, walls, walks, outdoor lighting including proposed fixtures, loading facilities, solid waste storage locations, and areas for snow storage after plowing. The first sheet in this plan shall be a locus plan, at a scale of one inch equals one hundred (100) feet, showing the entire project and its relation to existing areas, buildings and roads for a distance of one thousand (1,000) feet from the project boundaries or such other distance as may be approved or required by the Planning Board.

5451.b. Topography and drainage plan, which shall contain the existing and proposed final topography at two-foot intervals and plans for handling stormwater runoff drainage.

5451.c. Utility plan, which shall include all facilities for refuse and sewerage disposal or storage of all these wastes, the location of all hydrants, fire alarm and firefighting facilities on and adjacent to the site, all proposed recreational facilities and open space areas, and all wetlands including floodplain areas.

5451.d. Architectural plan, which shall include the ground floor plan, proposed exterior building materials, treatments and colors and architectural elevations of all proposed buildings and a color rendering where necessary to determine the proposal's affect on the visual environment.

5451.e. Landscaping plan, showing the limits of work, existing tree lines as well as those tree lines to remain, and all proposed landscape features and improvements including screening, planting areas with size and type of stock for each shrub or tree, and including proposed erosion control measures during construction.

5451.f. Lighting plan showing the location and orientation of all existing and proposed exterior lighting, including building and ground lighting. The plan shall note the height, initial foot-candle readings on the ground and the types of fixtures to be used.

5452. The site plan shall be accompanied by a written statement indicating the estimated time required to complete the proposed project and any and all phases thereof. There shall be submitted a written estimate, showing in detail the costs of all site improvements planned.

5453. A written summary of the contemplated project shall be submitted with the site plan indicating, where appropriate, the number of dwelling units to be built and the acreage in residential use, the evidence of compliance with parking and off-street loading requirements, the forms of ownership contemplated for the property and a summary of the provisions of any ownership or maintenance thereof, identification of all land that will become common or public land, and any other evidence necessary to indicate compliance with this Ordinance.

5454. The site plan shall be accompanied by drainage calculations by a registered professional engineer as well as wetland delineations, if applicable. Storm drainage design must conform to City of New Bedford subdivision regulations.

5455. The Planning Board may require a DIS as set forth in Section 5300, above.

5456. Certification that the proposal is in compliance with the provisions, if applicable, of the Americans with Disabilities Act and the Massachusetts Architectural Barriers Board.

(Ord. of 12-23-03, § 1)

5460. Waivers. The Planning Board may, upon written request of the applicant, waive any of the submittal or technical requirements of Section 5430 and 5440 where the project involves relatively simple development plans.

(Ord. of 12-23-03, § 1)

5470. Approval. Site Plan approval shall be granted upon determination by the Planning Board that the plan meets the following objectives: The Planning Board may impose reasonable conditions at the expense of the applicant, including performance guarantees, to promote these objectives. Any new building construction or other site alteration shall provide adequate access to each structure for fire and service equipment and adequate provision for utilities and stormwater drainage consistent with the functional requirements of the Planning Board's Subdivision Rules and Regulations. New building construction or other site alteration shall be designed in the Site Plan, after considering the qualities of the specific location, the proposed land use, the design of building form, grading, egress points, and other aspects of the development, so as to:

5471. Minimize: the volume of cut and fill, the number of removed trees six-inch caliper or larger, the length of removed stone walls, the area of wetland vegetation displaced, the extent of stormwater flow increase from the site, soil erosion, and the threat of air and water pollution;

5472. Maximize: pedestrian and vehicular safety to and from the site;

5473. Minimize obstruction of scenic views from publicly accessible locations;

5474. Minimize visual intrusion by controlling the layout and visibility of parking, storage, or other outdoor service areas viewed from public ways or premises which are residentially used or zoned;

5475. Minimize glare from vehicle headlights and lighting fixtures;

5476. Minimize unreasonable departure from the character, materials, and scale of buildings in the vicinity, as viewed from public ways and places.

5477. Minimize contamination of groundwater from on-site wastewater disposal systems or operations on the premises involving the use, storage, handling, or containment of solid and liquid wastes and hazardous substances;

5478. Ensure compliance with the provisions of this Zoning Ordinance.

5479. Minimize damage to existing adjacent public ways.

5479A. Promote orderly and reasonable internal circulation within the site so as to protect public safety and not unreasonably interfere with access to a public way or circulation of traffic on a public way in general.

(Ord. of 12-23-03, § 1)

5480. **Lapse.** Site plan approval shall lapse after one year from the final approval if a substantial use in accordance with such approved plans has not commenced except for good cause. Such approval may, for good cause, be extended in writing by the Planning Board upon the written request of the applicant, within this one-year period.

(Ord. of 12-23-03, § 1)

5490. **Regulations.** The Planning Board may adopt and from time to time amend reasonable regulations for the administration of these Site Plan guidelines.

(Ord. of 12-23-03, § 1)

5490A. **Fee.** The Planning Board may, from time to time, adopt reasonable administrative fees and technical review fees for site plan review.

(Ord. of 12-23-03, § 1)

5490B. **Appeal.** Any person aggrieved by a decision of the Planning Board rendered pursuant to Section 5400 may appeal such decision to the Zoning Board of Appeals as provided in M.G.L.A. c. 40A, § 8.

(Ord. of 12-23-03, § 1)

5500. - AMENDMENTS.

This Ordinance may from time to time be changed by amendment, addition, or repeal by the City Council in the manner provided in M.G.L.A. c. 40A, § 5, and any amendments thereto.

5510. **Amendment advertising.** Any advertisement for a hearing, the purpose of which is to serve as notice of a zoning amendment proposal under M.G.L.A. c. 40A, § 5, that proposes to change twenty-five (25) parcels or fewer from one principal use district to another principal use district under Section 2100, shall include the plot and lot number and the street address of the parcel or parcels whenever said plot and lot number and address is reasonably ascertainable.

(Ord. of 12-23-03, § 1; Ord. of 4-19-06, § 1)

5600. - APPLICABILITY.

5610. **Other Laws.** Where the application of this Ordinance imposes greater restrictions than those imposed by any other regulations, permits, restrictions, easements, covenants, or agreements, the provisions of this Ordinance shall control.

(Ord. of 12-23-03, § 1)

5620. **Conformance.** Construction or operations under a Building or Special Permit shall conform to any subsequent amendment of this Ordinance unless the use or construction is commenced within a period of six (6) months after the issuance of the permit, and in cases involving construction, unless such construction is continued through to completion as continuously and expeditiously as is reasonable.

(Ord. of 12-23-03, § 1)

5700. - PLANNING MORATORIUM.

5710. **Moratorium on used car sales permits.** To provide the licensing board with the opportunity to review criteria for granting licenses for used car sales, there is hereby imposed a moratorium on Class II used car sales permits, other than renewals, for a period of one year. During the term of this moratorium (unless earlier terminated by ordinance) the City will not accept any permit applications for Class II used car sales. The moratorium imposed by this Section shall be in effect for one year commencing on the date of passage.

(Ord. of 12-23-03, § 1)

5800—8999. - RESERVED.