

TION NOTES:

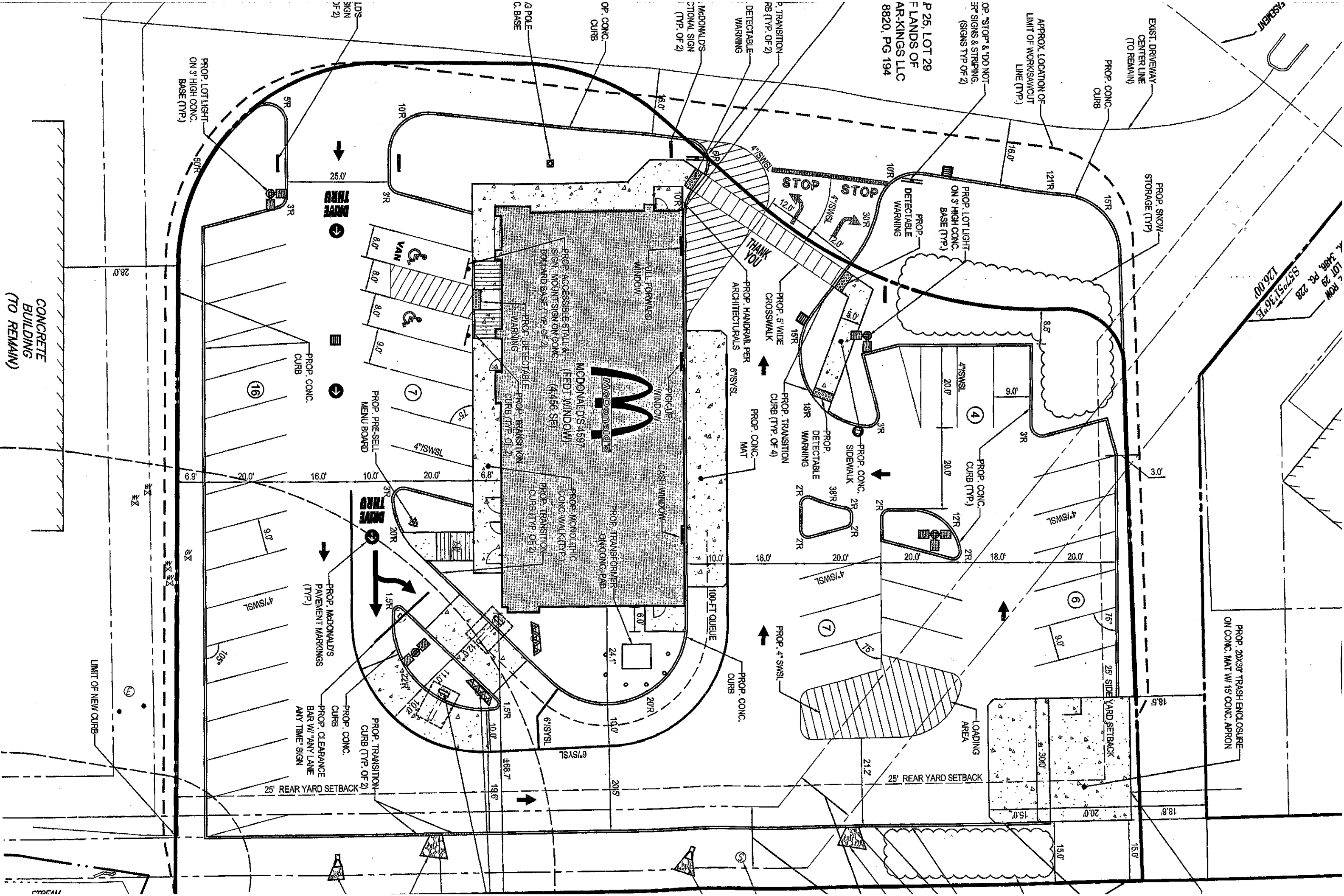

CONCRETE BUILDING (TO REMAIN)

P 25, LOT 29
LANDS OF
AR-KINGS LLC
8820, PG 194

PROP. 20'X30' TRASH ENCLOSURE-
ON CONC. MAT W/ 15' CONC. APRON

LOT 28
Pg. 228
557'x513'6" E
126.00'