

**Sidewalk Café  
Permit Application**

**PLANNING  
MAR 2 5 2015  
DEPARTMENT**

**Return completed application, supporting documentation, and application fee to:  
City of New Bedford-Planning Department Room 303 at City Hall. For assistance,  
Please call (508) 979-1488**

**Applicant Information**

Date: 3/16/15  
Restaurant Owner: Gaig Ribeiro  
Restaurant Address: 780 Purchase ST  
Telephone: 508 990 1127 Fax: \_\_\_\_\_  
Requested Number of Outdoor: Tables: 5 Chairs: 20

<u>Permit Type</u>	
<input type="checkbox"/>	New Permit (\$25)
<input checked="" type="checkbox"/>	W/alcohol (\$50)

**Required Materials (Applications will not be accepted without the following)**

- Copy of a valid restaurant license.
- Copy of a current certificate of insurance, naming the City of New Bedford as additional insured.
- A layout, drawn to scale on 8.5 x 11" paper, which accurately depicts the dimensions of the existing sidewalk area and adjacent private property, the proposed location of the sidewalk café, size and number of tables, chairs, steps, planters, and umbrellas, location of doorways, trees, parking meters, bus shelters, sidewalk benches, trash receptacles, and any other sidewalk obstructions, either existing or proposed, within the pedestrian area.
- Photographs, drawings, or manufacturer's brochures describing the appearance and dimensions of all tables, chairs, umbrellas or other objects related to the sidewalk Café.
- Signed Hold Harmless Agreement
- A Non-refundable application fee
- New permit - \$25
- New Permit W/alcohol expansion \$50

If this application is approved, I hereby agree to abide by all the relevant City regulations pertaining to the installation of sidewalk cafes, including but not limited to Chapter 15 Article VI Sec. 15-100 of the City Code of Ordinances.

Signature – Restaurant Owner

**Official Use Only**

Review date: \_\_\_\_\_ All materials submitted: \_\_\_\_\_ yes Liquor License: \_\_\_\_\_  
Signature: \_\_\_\_\_ Fee: \_\_\_\_\_

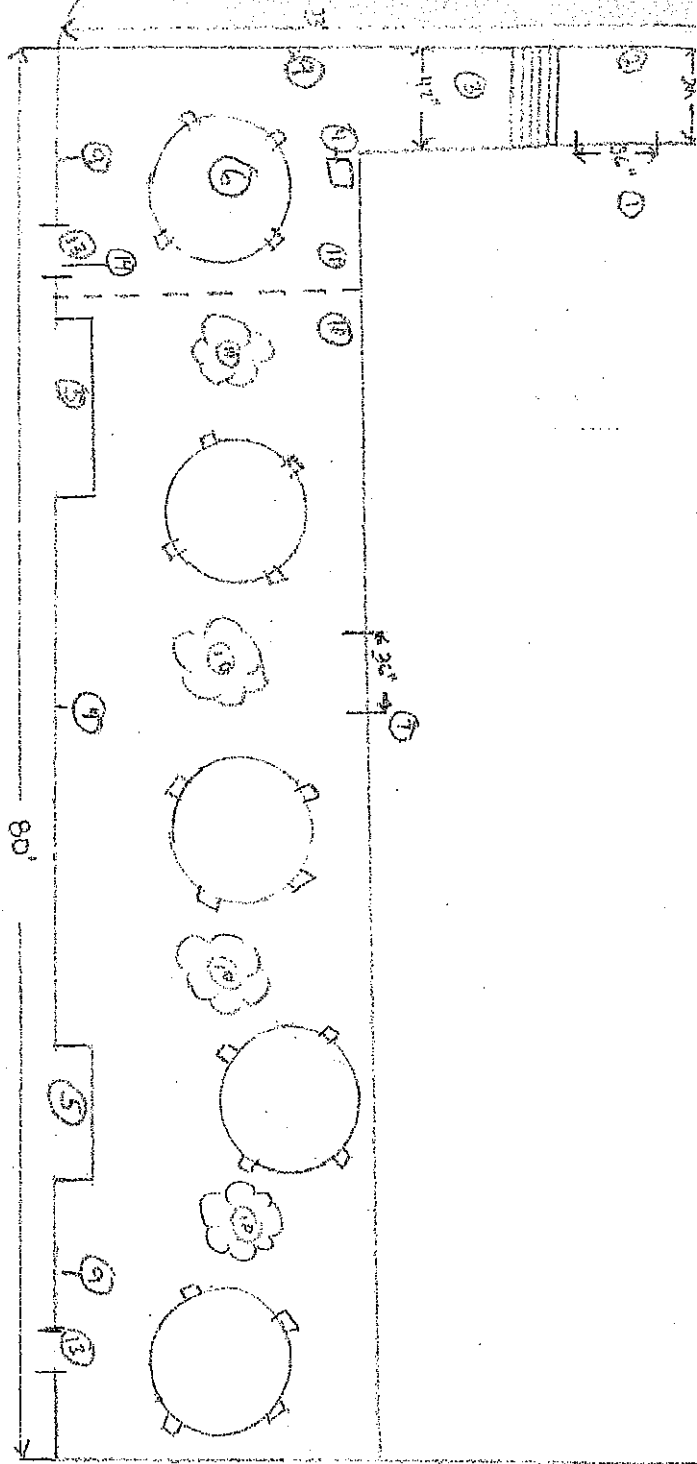

2012 SEASON PLAN

8

12

**FENCE - Leslie Locke 8ft x 4ft Super Galvanized Fence Panel - Black**

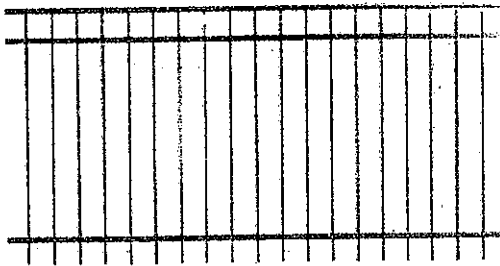

**Gate**

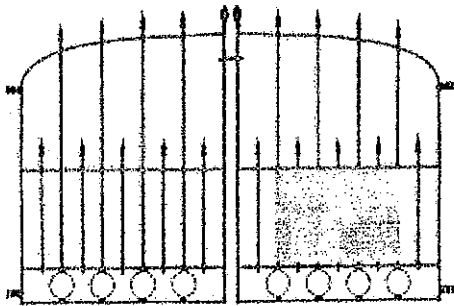

*2012 SEASON PLAN*