

# BUZZARDS BAY

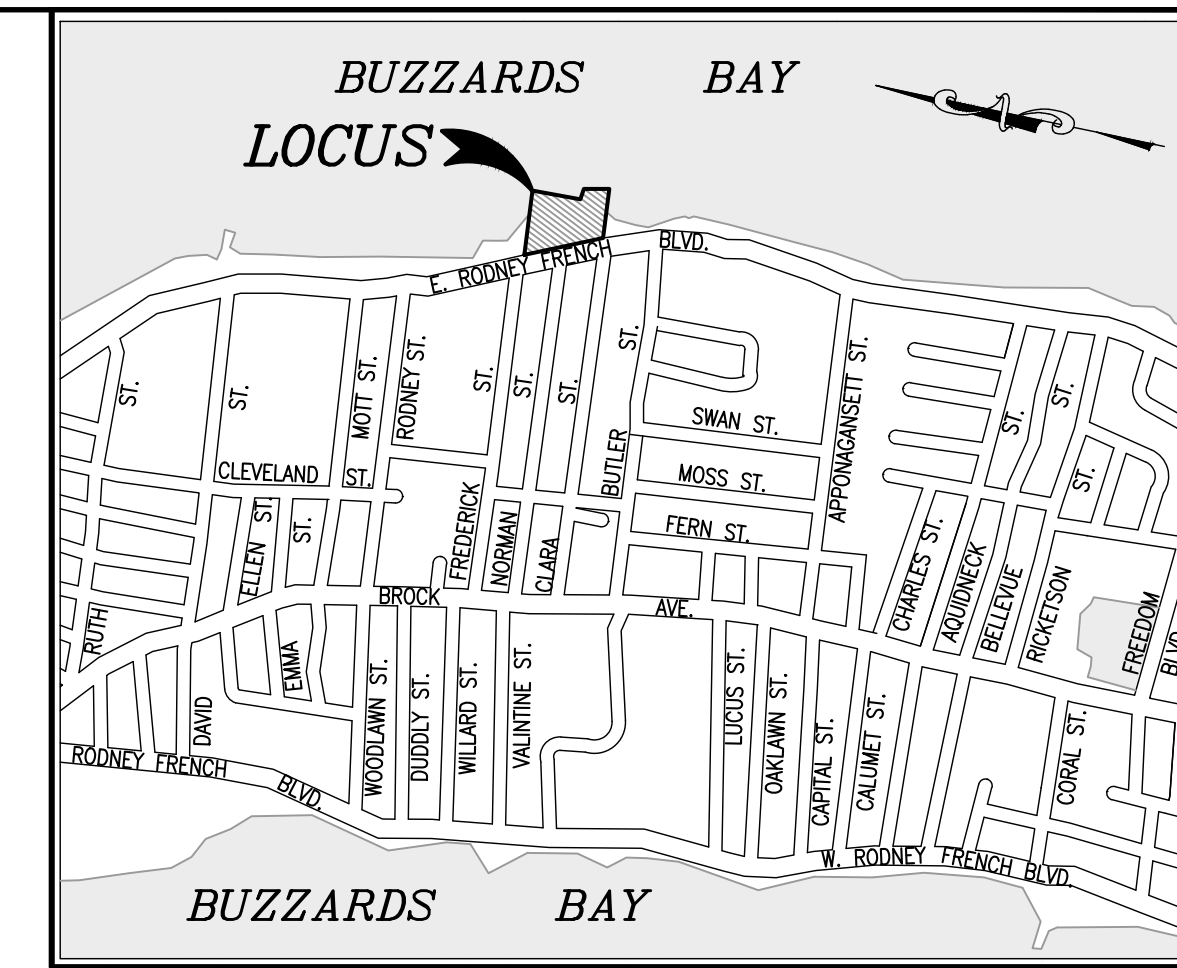
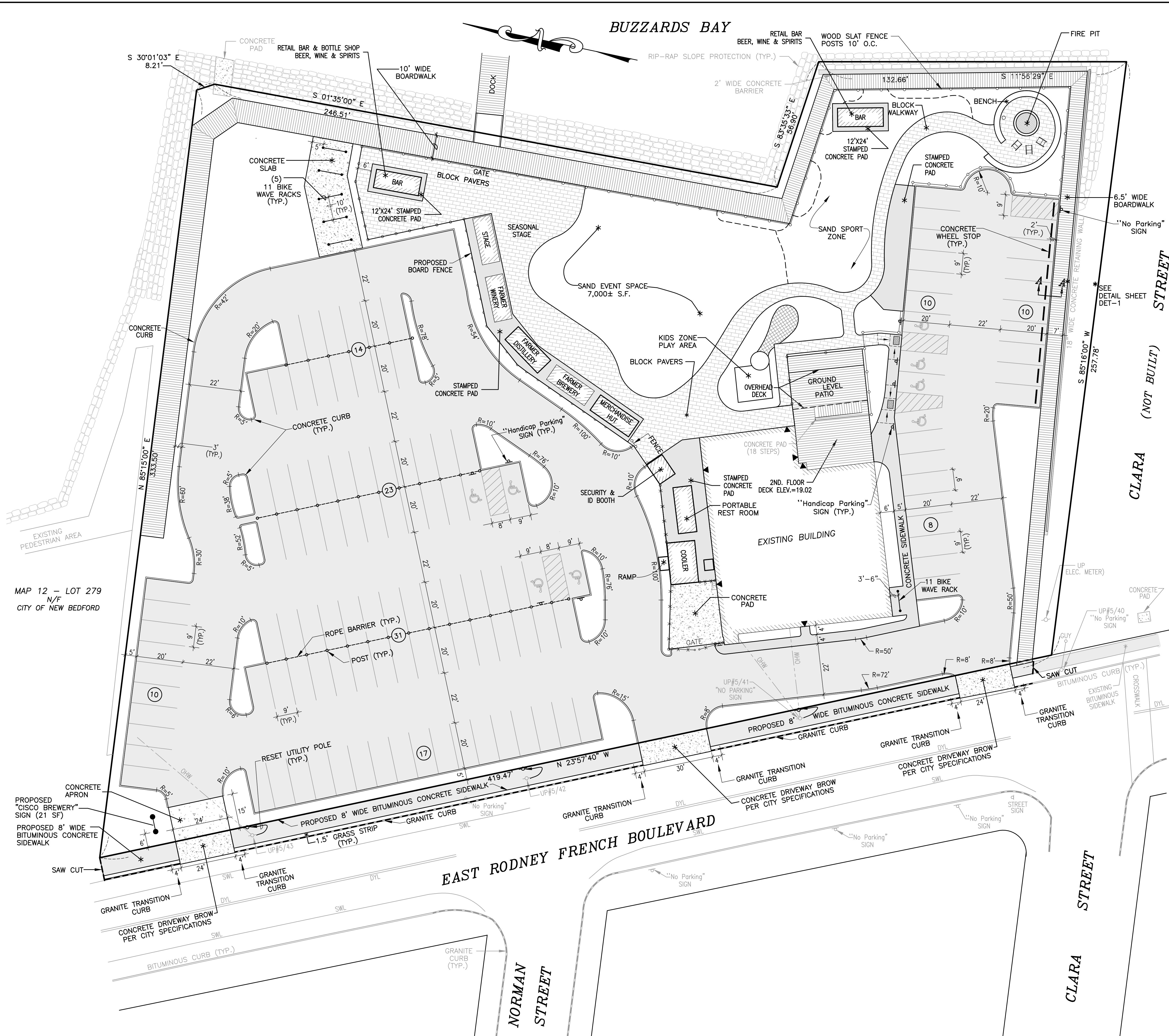

**LOCUS MAP**  
SCALE: 1"=1,000'±

## LEGEND

- PROPERTY LINE
- EXISTING BUILDING ENTRANCE
- EXISTING DOUBLE YELLOW LINE
- EXISTING SOLID WHITE LINE
- EXISTING CHAIN LINK FENCE
- PROPOSED NUMBER OF PARKING SPACES
- PROPOSED BUILDING ENTRANCE
- PROPOSED CHAIN LINK FENCE
- PROPOSED WOOD SLAT FENCE

## NOTES:

- I HEREBY CERTIFY THAT THE PROJECT AS DESIGNED MEETS THE APPLICABLE PROVISIONS OF THE AMERICANS WITH DISABILITIES ACT (ADA) AND THE MASSACHUSETTS ARCHITECTURAL ACCESS BOARD.
- DRIVEWAY PERMIT SUBJECT TO TRAFFIC COMMISSION APPROVAL.
- PERMITS FOR SIDEWALK, DRIVEWAYS, WATER & SEWER MUST BE OBTAINED FROM THE DEPARTMENT OF PUBLIC INFRASTRUCTURE ENGINEERING DIVISION.
- ANY MINOR MODIFICATIONS (AS DETERMINED BY THE CITY PLANNER AND CITY ENGINEER) TO THE INFORMATION SHOWN ON THE APPROVED SITE PLANS SHALL BE SUBMITTED TO THE CITY PLANNER AND CITY ENGINEER AS A MINOR PLAN REVISION FOR APPROVAL PRIOR TO THE WORK BEING PERFORMED.
- ANY WORK AND MATERIAL WITHIN THE CITY RIGHT-OF-WAY SHALL CONFORM TO THE CITY OF NEW BEDFORD REQUIREMENTS.
- ALL EROSION CONTROL MEASURES SHALL BE IN PLACE PRIOR TO CONSTRUCTION.
- ALL PAVEMENT MARKINGS AND SIGNS SHALL CONFORM TO MUTCD REQUIREMENTS.
- BICYCLE RACKS SHALL BE 9 BIKE CAPACITY WAVE RACKS WITH IN-GROUND MOUNTING.

MAP 12 - LOT 279  
N/F  
CITY OF NEW BEDFORD

Chkd. By	Revision Description	Date	No.
SDG	ADD. Pylon Sign	MAY 17, 2021	8
SDG	REVISE WATER SERVICE	MARCH 12, 2021	7
SDG	REVISE LAYOUT/UTILITIES	DEC. 22, 2020	6
SDG	REVISE BUILDING LAYOUT	NOV. 23, 2020	5
SDG	CONSERVATION COMMISSION REVISIONS	FEB. 24, 2020	4
SDG	CONSERVATION COMMISSION REVISIONS	FEB. 11, 2020	3
SDG	REVISE PARKING	SEPT. 3, 2019	2
SDG	MISCELLANEOUS PLANNING REVISIONS	JULY 5, 2019	1

Scale: 1"=20'	Date: MARCH 15, 2019	Drawn: NAD	Checked: SDG	Sheet of 11
Project: CISCO NEW BEDFORD 1480 EAST RODNEY FRENCH BLVD. NEW BEDFORD, MA 02744	Client: SERVEDWELL NEW BEDFORD, LLC	Drawing Title: SITE LAYOUT		

**SITEC**  
Civil and Environmental Engineering  
Land Use Planning

449 Fournice Corner Road  
New Bedford, MA 02744  
(508) 998-2125  
FAX (508) 998-7554  
WWW.SITEC-ENGINEERING.COM

Acad. No. NB 19-7146 SLDWG  
File No. 19-7146