

 MUB MIXED-USE BUSINESS DISTRICT
  I-B INDUSTRIAL DISTRICT

 I-A INDUSTRIAL DISTRICT
  INTERSTATE 195

**FOR**

MAP 93, LOTS 275, 168, & 169

0 & 8 MITCHELL STREET & 157 COGGESHALL STREET  
CITY OF NEW BEDFORD, BRISTOL COUNTY, MASSACHUSETTS

**ALRIG USA DEVELOPMENT, LLC**  
**30200 TELEGRAPH ROAD, SUITE 205**  
**BINGHAM FARMS, MI 48025**

**ASSESSORS MAP 93, LOTS 275, 168, & 169**

**ZONING DISTRICTS: MIXED USE BUSINESS (MUB)  
& INDUSTRIAL BUSINESS (IB)  
PROPOSED USE: RESTAURANT WITH  
DRIVE-THRU & OUTDOOR PATIO**

**DEED REFERENCE:** BOOK 10890, PAGE 215  
BOOK 4320, PAGE 247  
BOOK 8163, PAGE 289

[illegible]

**NOT APPROVED FOR CONSTRUCTION**



Rutherford, NJ • New York, NY • Boston, MA  
Princeton, NJ • Tampa, FL • Detroit, MI  
[www.stonefielddeng.com](http://www.stonefielddeng.com)

---

1 Beacon Street, 15 Floor: Boston, MA 02108  
Phone 617.203.2076



BOOK 10890, PG. 215 / BOOK 4320, PG. 247 / BOOK 8163, PG. 289  
MAP 93, LOTS 275, 168, & 169  
0 & 8 MITCHELL STREET & 157 COGGESHALL STREET  
CITY OF NEW BEDFORD  
BRISTOL COUNTY, MASSACHUSETTS

**SITE PLAN SET**

**ALRIG USA DEVELOPMENT, LLC**

## PROPOSED STARBUCKS WITH DRIVE-THRU FACILITIES

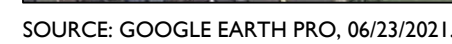

SCALE: 1" = 80'±

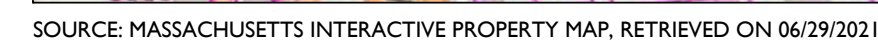

SCALE: 1" = 400'±

**BLOCK 93, LOTS 168, 169, & 275**

## BUSINESS (MUB) & INDUSTRIAL BUSIN

HICKS-LOGAN-SAWYER (HLS IPOD) OVERLAY DISTRICT	
PROPOSED USE	

PROPOSED USE		SPECIAL PERMIT *	
RESTAURANT WITH DRIVE-THRU OUTDOOR PATIO		PERMITTED USE	
ZONING REQUIREMENT	REQUIRED **	EXISTING	PROPOSED
MINIMUM LOT AREA	N/A	35,212.2 SF (0.81 AC)	35,212.2 SF (0.81 AC)
MINIMUM LOT FRONTAGE	0.0 FT	90.7 FT	90.7 FT
MINIMUM GREEN SPACE	0.0% (0.0 SF)	55.0% (19,371.0 SF)	20.9% (7,370 SF)
MAXIMUM BUILDING COVERAGE	0.0% (0.0 SF)	13.9% (4,894.3 SF)	6.5% (2,280.0 SF)
MAXIMUM BUILDING HEIGHT	100 FT / 7 STORIES	<100 FT / 1 STORY	21.5 FT / 1 STORY
MINIMUM GREENBELT SETBACK	5.0 FT	0.0 FT (EN)	5.0 FT
MINIMUM FRONT YARD SETBACK	0.0 FT	58.3 FT	65.2 FT
MINIMUM SIDE YARD SETBACK	0.0 FT	0.0 FT	43.5 FT
MINIMUM REAR YARD SETBACK	10.0 FT	102.1 FT	44.5 FT

(*)	A USE AUTHORIZED UNDER SPECIAL PERMIT FOR MIXED USE BUSINESS (MUB) DISTRICT
(**)	
(N/A)	REQUIREMENTS CONSIDER ZONING FOR MIXED USE BUSINESS (MUB) DISTRICT ONLY
(EN)	NON-APPLICABLE EXISTING NON-CONFORMITY



Know what's **below**  
**Call** before you dig.

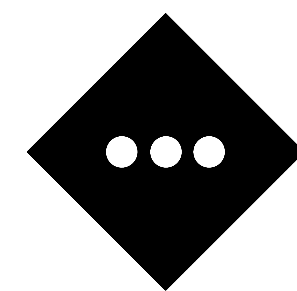

**STONEFIELD**  
engineering & design

Rutherford, NJ • New York, NY • Boston, MA  
Princeton, NJ • Tampa, FL • Detroit, MI  
[www.stonefieldeng.com](http://www.stonefieldeng.com)

1 Beacon Street, 15 Floor, Boston, MA 02108  
Phone 617.203.2076

**PLAN REFERENCE MATERIALS:**

1. THIS PLAN SET REFERENCES THE FOLLOWING DOCUMENTS INCLUDING, BUT NOT LIMITED TO:
  - ALTA/NSPS LAND TITLE SURVEY PREPARED BY CONTROL POINT ASSOCIATES, INC. DATED 05/04/2021.
  - ARCHITECTURAL PLANS PREPARED BY CORTLAND MORGAN ARCHITECT AND DETROIT ARCHITECTURAL GROUP, DATED 06/25/2021.
  - GEOTECHNICAL ENGINEERING REPORT PREPARED BY TERRACON, DATED 05/27/2021.
  - AERIAL MAP RETRIEVED FROM GOOGLE EARTH PRO, 06/23/2021.
  - LOCATION MAP OBTAINED FROM THE UNITED STATES GEOLOGICAL SURVEY, 7.5 MINUTE SERIES, NEW BEDFORD NORTH QUADRANGLE - MASSACHUSETTS, DATED 2018.
  - TAX MAP OBTAINED FROM THE CITY OF NEW BEDFORD ONLINE PARCEL MAP, RETRIEVED 06/23/2021.
  - ZONING MAP OBTAINED FROM THE CITY OF NEW BEDFORD, DATED 2020.
2. ALL REFERENCE MATERIAL LISTED ABOVE SHALL BE CONSIDERED A PART OF THIS PLAN SET AND ALL INFORMATION CONTAINED WITHIN THESE MATERIALS SHALL BE UTILIZED IN CONJUNCTION WITH THIS PLAN SET. THE CONTRACTOR IS RESPONSIBLE TO OBTAIN A COPY OF EACH REFERENCE AND REVIEW IT THOROUGHLY PRIOR TO THE START OF CONSTRUCTION.

<b>DRAWING TITLE</b>	<b>SHEET #</b>
COVER SHEET	C-1
EXISTING CONDITIONS PLAN	C-2
DEMOLITION PLAN	C-3
SITE PLAN	C-4
GRADING & DRAINAGE PLAN	C-5
UTILITY PLAN	C-6
LIGHTING PLAN	C-7
LANDSCAPING PLAN	C-8
SOIL EROSION & SEDIMENT CONTROL PLAN	C-9 - C-10
CONSTRUCTION DETAILS	C-11 - C-14
TRUCK TURN PLAN	C-15 - C-16

**JAKE MODESTOW, P.E.**  
MASSACHUSETTS LICENSE No. 6201065336  
LICENSED PROFESSIONAL ENGINEER



SCALE:	AS SHOWN	PROJECT ID: BOS-200026
--------	----------	------------------------

TITLE:	
--------	--

COVER SHEET

**DRAWING:**

## C-1



1. THE SURVEY LISTED WITHIN THE PLAN REFERENCES ON THE COVER SHEET SHALL BE CONSIDERED A PART OF THIS PLAN SET AND ALL INFORMATION CONTAINED WITHIN THE SURVEY AND ASSOCIATED DOCUMENTS SHALL BE UTILIZED IN CONJUNCTION WITH THIS PLAN SET. THE CONTRACTOR RESPONSIBLE TO OBTAIN A COPY OF THE SURVEY AND REVIEW IT THOROUGHLY PRIOR TO THE START OF CONSTRUCTION.
2. THE EXISTING CONDITIONS SHALL ONLY BE USED AS A REFERENCE. CONTRACTOR IS RESPONSIBLE TO REFER BACK TO THE SURVEY FOR EXISTING CONDITIONS.
3. ALTA/INSPS LAND TITLE SURVEY PREPARED BY CONTROL POINT ASSOCIATES INC. DATED 05/04/2021.



**NOT APPROVED FOR CONSTRUCTION**

Rutherford, NJ • New York, NY • Boston, MA  
Princeton, NJ • Tampa, FL • Detroit, MI  
[www.stonefieldeng.com](http://www.stonefieldeng.com)

1 Beacon Street, 15 Floor, Boston, MA 02108  
Phone 617.203.2076

BOOK 10890, PG. 215 / BOOK 4320, PG. 247 / BOOK 8163, PG. 289  
MAP 93, LOTS 275, 168, & 169  
0 & 8 MITCHELL STREET & 157 COGGESHALL STREET  
CITY OF NEW BEDFORD

**C-2**

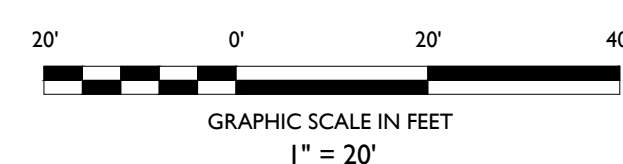

Z:\BOSTON\BOS\2020\BOS-200026-ALRIG-NEC COGGESHALL STREET & MITCHELL STREET, NEW BEDFORD, MA\CADD\%OTILD\02-EXSTDWG





Know what's below  
Call before you dig.

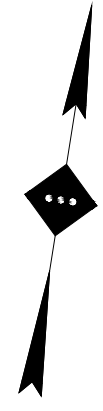

### SAWYER STREET

(PUBLIC - 50' WIDE - PER REF #6)  
(CITY LAYOUT OF 1889)  
TWO WAY  
TRAFFIC  
(ASPHALT ROADWAY)

### SYMBOL

--- FEATURE TO BE REMOVED / DEMOLISHED  
--- LOD --- LIMIT OF DISTURBANCE

### DESCRIPTION

ALL SITE FEATURES WITHIN THE LIMIT OF DISTURBANCE INDICATED ON THIS PLAN ARE TO BE REMOVED / DEMOLISHED UNLESS OTHERWISE NOTED. THE CONTRACTOR SHALL NOTIFY STONEFIELD ENGINEERING & DESIGN, LLC. IF SIGNIFICANT DISCREPANCIES ARE DISCERNED BETWEEN THIS PLAN AND FIELD CONDITIONS

### DUST CONTROL NOTES

- MULCHES - SEE STANDARD OF STABILIZATION WITH MULCHES ONLY, PG. 5-1
- VEGETATIVE COVER - SEE STANDARD FOR TEMPORARY VEGETATIVE COVER, PG. 7-1, PERMANENT VEGETATIVE COVER FOR SOIL STABILIZATION PG. 4-1 AND PERMANENT STABILIZATION WITH SOD, PG. 6-1
- SPRAY-ON ADHESIVES - ON MINERAL SOILS (NOT EFFECTIVE ON MUCK SOILS). KEEP TRAFFIC OFF THESE AREAS.
- TILLAGE - TO ROUGHEN SURFACE AND BRING CLODS TO THE SURFACE. THIS IS A TEMPORARY EMERGENCY MEASURE WHICH SHOULD BE USED BEFORE SOIL BLOWING STARTS. BEGIN PLOWING ON WINDWARD SIDE OF SITE. CHISEL-TYPE PLOWS SPACED ABOUT 12 INCHES APART AND SPRING-TOOTHED HARROWS ARE EXAMPLES OF EQUIPMENT WHICH MAY PRODUCE THE DESIRED EFFECT.
- SPRINKLING - SITE IS SPRINKLED UNTIL THE SURFACE IS WET.
- BARRIERS - SOLID BOARD FENCES, SNOW FENCES, BURLAP FENCES, CRATE WALLS, BALES OF HAY AND SIMILAR MATERIAL CAN BE USED TO CONTROL AIR CURRENTS AND SOIL BLOWING.
- CALCIUM CHLORIDE - SHALL BE IN THE FORM OF LOOSE, DRY GRANULES OR FLAKES FINE ENOUGH TO FEED THROUGH COMMONLY USED SPREADERS AT A RATE THAT WILL KEEP SURFACE MOIST BUT NOT CAUSE POLLUTION OR PLANT DAMAGE. IF USED ON STEEPER SLOPES, THEN USE OTHER PRACTICES TO PREVENT WASHING INTO STREAMS OR ACCUMULATION AROUND PLANTS.
- STONE - COVER SURFACE WITH CRUSHED STONE OR COARSE GRAVEL.

### DEMOLITION NOTES

- THE WORK REFLECTED ON THE DEMOLITION PLAN IS TO PROVIDE GENERAL INFORMATION TOWARDS THE EXISTING ITEMS TO BE DEMOLISHED AND/OR REMOVED. THE CONTRACTOR IS RESPONSIBLE TO REVIEW THE ENTIRE PLAN SET AND ASSOCIATED REPORTS/REFERENCE DOCUMENTS INCLUDING ALL DEMOLITION ACTIVITIES AND INCIDENTAL TASKS NECESSARY TO COMPLETE THE SITE IMPROVEMENTS.
- THE CONTRACTOR IS RESPONSIBLE TO DETERMINE THE MEANS AND METHODS OF DEMOLITION ACTIVITIES.
- EXPLOSIVES SHALL NOT BE USED UNLESS WRITTEN CONSENT FROM BOTH THE OWNER AND ANY APPLICABLE GOVERNING AGENCY IS OBTAINED. BEFORE THE START OF ANY EXPLOSIVE PROGRAM, THE CONTRACTOR IS RESPONSIBLE TO OBTAIN ALL LOCAL, STATE, AND FEDERAL PERMITS. ADDITIONALLY, THE CONTRACTOR WILL BE RESPONSIBLE FOR ALL SEISMIC TESTING AS REQUIRED AND ANY DAMAGES AS THE RESULT OF SAID DEMOLITION PRACTICES.
- ALL DEMOLITION ACTIVITIES SHALL BE PERFORMED IN ACCORDANCE WITH LOCAL, STATE, AND FEDERAL CODES. THE CONTRACTOR IS RESPONSIBLE FOR ENSURING ALL UTILITIES ARE DISCONNECTED IN ACCORDANCE WITH THE UTILITY AUTHORITIES' REQUIREMENTS PRIOR TO STARTING THE DEMOLITION OF ANY STRUCTURE. ALL EXCAVATIONS ASSOCIATED WITH DEMOLISHED STRUCTURES OR REMOVED TANKS SHALL BE BACKFILLED WITH SUITABLE MATERIAL AND COMPACTED TO SUPPORT SITE AND BUILDING IMPROVEMENTS. A GEOTECHNICAL ENGINEER SHOULD BE PRESENT DURING BACKFILLING ACTIVITIES TO OBSERVE AND CERTIFY THAT BACKFILL MATERIAL WAS COMPACTED TO A SUITABLE CONDITION.
- DEMOLISHED DEBRIS SHALL NOT BE BURIED ON SITE. ALL WASTE/DEBRIS GENERATED FROM DEMOLITION ACTIVITIES SHALL BE DISPOSED OF IN ACCORDANCE WITH ALL LOCAL, STATE AND FEDERAL REQUIREMENTS. THE CONTRACTOR IS RESPONSIBLE TO MAINTAIN ALL RECORDS OF THE DISPOSAL TO DEMONSTRATE COMPLIANCE WITH THE ABOVE REGULATIONS.

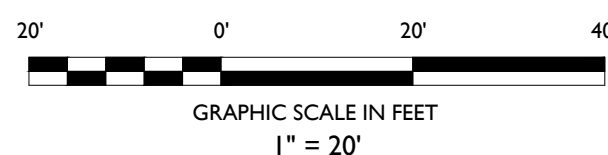

NOT APPROVED FOR CONSTRUCTION

**STONEFIELD**  
engineering & design

Rutherford, NJ • New York, NY • Boston, MA  
Princeton, NJ • Tampa, FL • Detroit, MI  
www.stonefielddesign.com

1 Beacon Street, 15 Floor, Boston, MA 02108  
Phone 617.203.2076

**ALRIG USA DEVELOPMENT, LLC**

**PROPOSED STARBUCKS WITH  
DRIVE-THRU FACILITIES**



BOOK 10890, PG. 215 / BOOK 4320, PG. 247 / BOOK 8163, PG. 289  
MAP 93, LOT 275, 168 & 169  
0 & 8 MITCHELL STREET  
CITY OF NEW BEDFORD  
BRISTOL COUNTY, MASSACHUSETTS

JAKE MODESTOW, P.E.  
MASSACHUSETTS LICENSE No. 6201065336  
LICENSED PROFESSIONAL ENGINEER

**STONEFIELD**  
engineering & design

SCALE: 1" = 20' PROJECT ID: BOS-200026

TITLE:

**DEMOLITION PLAN**

DRAWING:

**C-3**

Z:\810701\BOS-200026\BOS-200026-ALRIG-NEC-COGGESHALL STREET & MITCHELL STREET-NEW BEDFORD-MA\CAD\DWG\10890-215.DWG



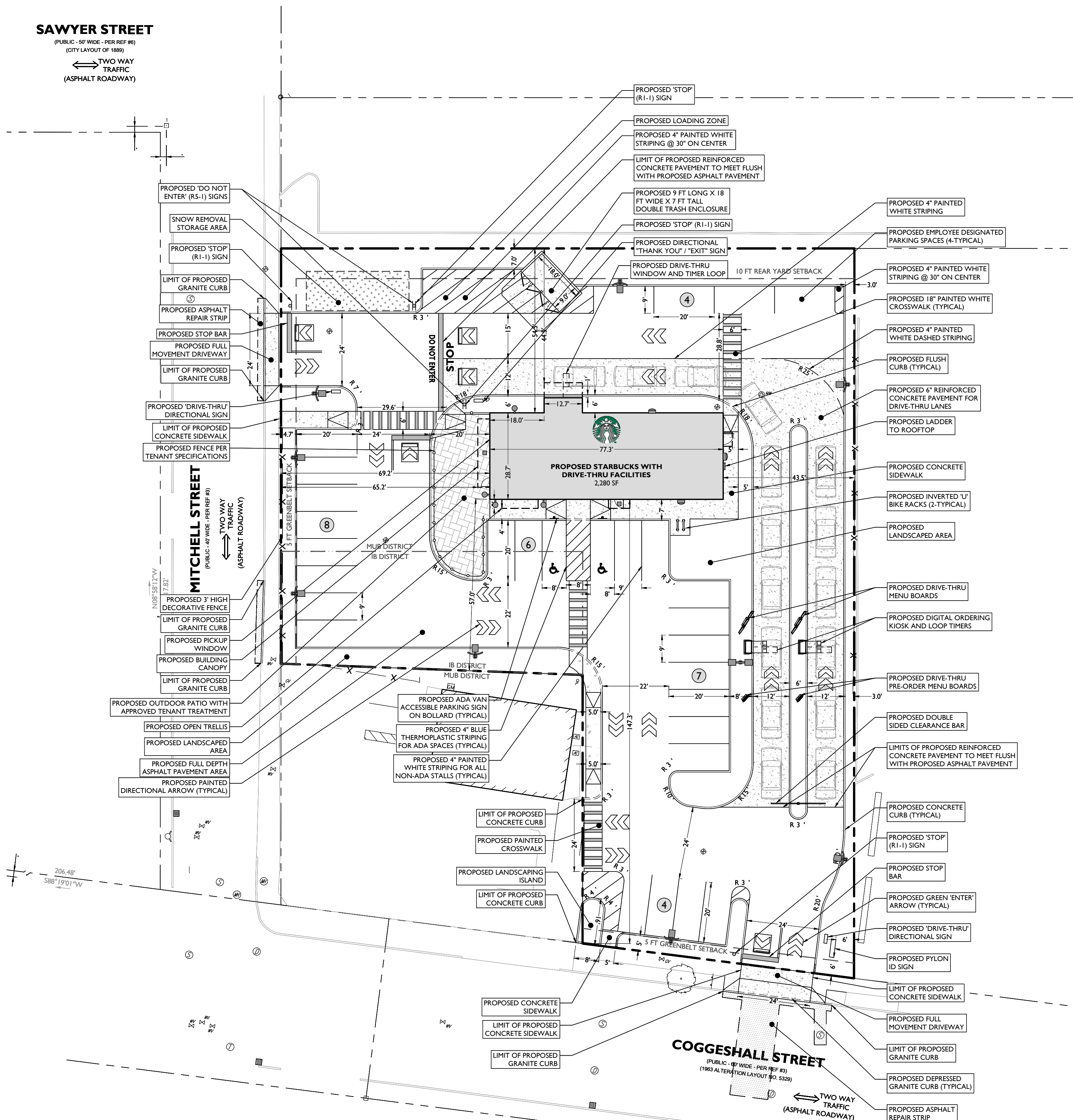

2. DRIVEWAY PERMIT SUBJECT TO TRAFFIC COMMISSION APPROVAL.
3. PERMITS FOR SIDEWALK, DRIVEWAYS, WATER & SEWER MUST BE OBTAINED FROM THE DEPARTMENT OF PUBLIC INFRASTRUCTURE ENGINEERING DIVISION.
4. ANY MINOR MODIFICATIONS TO THE INFORMATION SHOWN ON THE APPROVED SITE PLANS SHALL BE SUBMITTED TO THE CITY ENGINEER AS A MINOR PLAN REVISION FOR APPROVAL PRIOR TO THE WORK BEING PERFORMED.
5. ANY WORK AND MATERIAL WITHIN THE CITY RIGHT-OF-WAY SHALL CONFORM TO THE CITY OF NEW BEDFORD ORDINANCES.
6. ALL HANDICAP PARKING, RAMPS, AND ACCESS SHALL CONFORM TO AAB & MAAB REQUIREMENTS.
7. ALL EROSION CONTROL MEASURES SHALL BE IN PLACE PRIOR TO CONSTRUCTION. EROSION SHALL CONFORM TO THE CITY OF NEW BEDFORD CONSERVATION COMMISSION REQUIREMENTS AS STATED IN THE CITY OF NEW BEDFORD ORDINANCES (REFER TO EROSION CONTROL PLAN).
8. ALL PAVEMENT MARKINGS AND SIGNS SHALL CONFORM TO MUTCD REQUIREMENTS.

THE CONTRACTOR SHALL VERIFY AND FAMILIARIZE THEMSELVES WITH THE EXISTING SITE CONDITIONS AND THE PROPOSED SCOPE OF WORK (INCLUDING DIMENSIONS, LAYOUT, ETC.) PRIOR TO THE START OF CONSTRUCTION. COPIES OF ALL REQUIRED PERMITS AND APPROVALS SHALL BE KEPT ON SITE AT ALL TIMES DURING CONSTRUCTION.

THE CONTRACTOR SHALL OBTAIN ALL NECESSARY PERMITS AND APPROVALS PRIOR TO THE START OF CONSTRUCTION. COPIES OF ALL REQUIRED PERMITS AND APPROVALS SHALL BE KEPT ON SITE AT ALL TIMES DURING CONSTRUCTION.

THE CONTRACTOR SHALL BE RESPONSIBLE TO THE FULLEST EXTENT PERMITTED BY LAW, INDEMNIFY AND HOLD HARMLESS STONEFIELD ENGINEERING & DESIGN, LLC, AND ITS SUB-CONSULTANTS FROM AND AGAINST ANY DAMAGES AND LIABILITIES OF ANY KIND, INCLUDING BUT NOT LIMITED TO CLAIMS BY EMPLOYEES OF THE CONTRACTOR IN ADDITION TO CLAIMS CONNECTED TO THE PROJECT AS A RESULT OF NOT COMPLYING WITH THE REQUIREMENTS OF ANY APPLICABLE LAW, LIABILITY INSURANCE, AND LIMITS OF COMMERCIAL GENERAL LIABILITY INSURANCE.

THE CONTRACTOR SHALL NOT DEVIATE FROM THE PROPOSED IMPROVEMENTS IDENTIFIED WITHIN THIS PLAN SET UNLESS APPROVAL IS PROVIDED IN WRITING BY STONEFIELD ENGINEERING & DESIGN, LLC.

THE CONTRACTOR IS RESPONSIBLE TO DETERMINE THE MEANS AND METHODS OF CONSTRUCTION.

THE CONTRACTOR SHALL NOT PERFORM ANY WORK OR CAUSE DAMAGE TO OR AFFECT THE PROJECT OR ANY OF THE RESPONSIBILITIES OF ANY PERSON OR ENTITY WHO HAS AUTHORIZED THE WORK WITHOUT PRIOR WRITTEN CONSENT FROM THE OWNER OF THE PRIVATE PROPERTY.

THE CONTRACTOR IS RESPONSIBLE TO RESTORE ANY DAMAGED OR UNDERMINED STRUCTURE OR SITE FEATURE THAT IS IDENTIFIED TO REMAIN ON THE PLAN SET. ALL REPAIRS SHALL BE NEW MATERIALS IDENTICAL TO THE FEATURE TO ITS EXISTING CONDITION AT THE CONTRACTORS EXPENSE.

THE CONTRACTOR IS RESPONSIBLE TO PROVIDE THE APPROPRIATE SHOP DRAWINGS, PROFILES, AND ELEVATIONS FOR REVIEW AND FOR THE REVIEW. STONEFIELD ENGINEERING & DESIGN, LLC WILL REVIEW THE SUBMITTALS IN ACCORDANCE WITH THE DESIGN INTENT AS REFLECTED WITHIN THE PLAN SET.

THE CONTRACTOR IS RESPONSIBLE FOR TRAFFIC CONTROL IN ACCORDANCE WITH MANUAL ON UNIFORM TRAFFIC CONTROL.

THE CONTRACTOR IS REQUIRED TO PERFORM ALL WORK IN THE PUBLIC RIGHT-OF-WAY IN ACCORDANCE WITH THE APPROPRIATE GOVERNING AUTHORITY AND SHALL BE RESPONSIBLE FOR THE PROTECTION OF STRUCTURES OR FEATURES OF THE PUBLIC RIGHT-OF-WAY.

THE CONTRACTOR IS REQUIRED TO RETAIN AN OSHA CERTIFIED SAFETY INSPECTOR TO BE PRESENT ON SITE AT ALL TIMES DURING CONSTRUCTION.

THE CONTRACTOR SHALL BE RESPONSIBLE TO OBTAIN ALL PERMITS AND REQUIREMENTS LISTED IN THE NOTES WITHIN THIS PLAN SET.

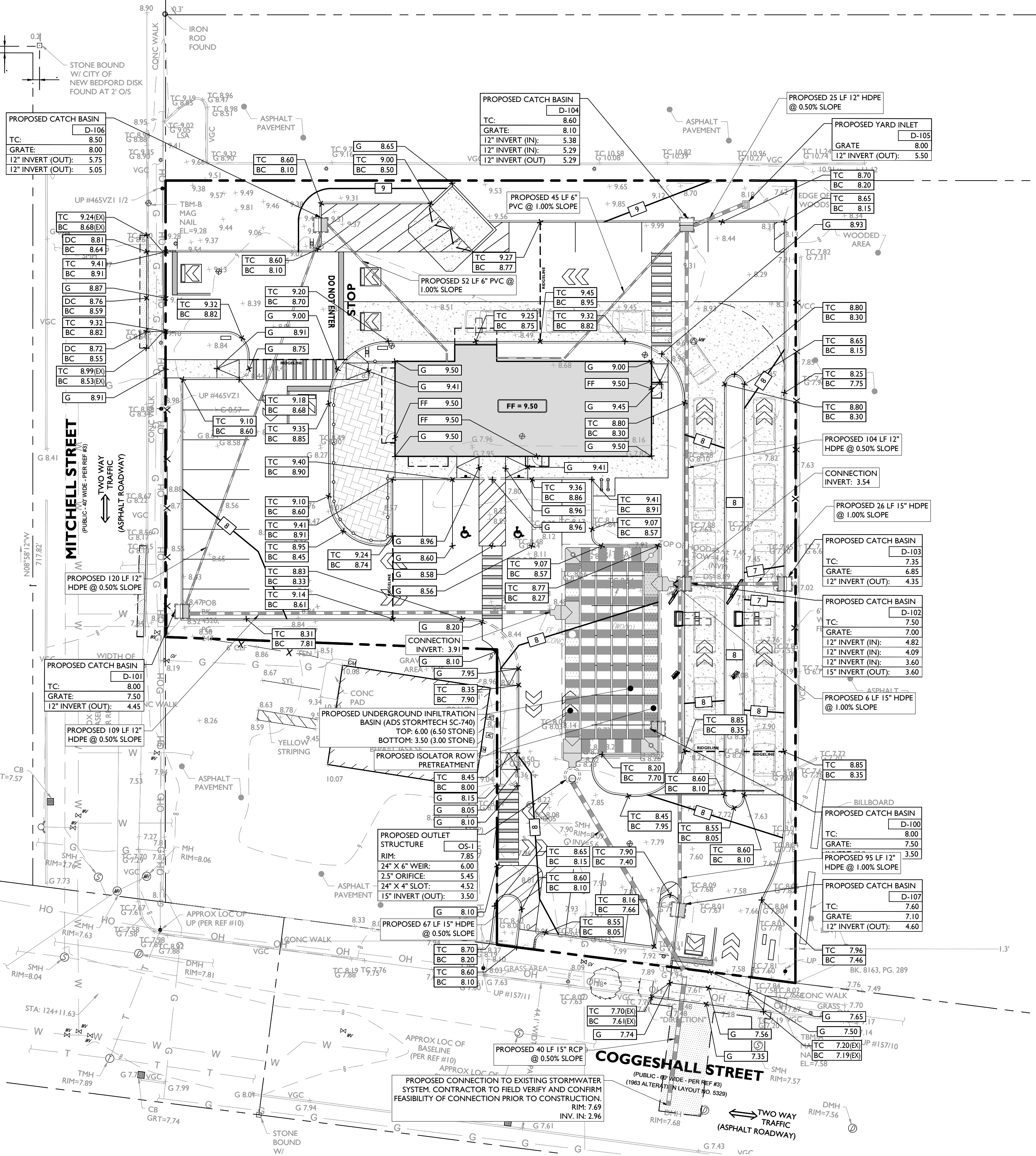

## SAWYER STREET

(PUBLIC - 50' WIDE - PER REF #8)  
(CITY LAYOUT OF 1899)TWO WAY  
TRAFFIC  
(ASPHALT ROADWAY)

## SYMBOL

## DESCRIPTION

	PROPERTY LINE
	PROPOSED GRADING CONTOUR
	PROPOSED GRADING RIDGELINE
	PROPOSED DIRECTION OF DRAINAGE FLOW
	PROPOSED GRADE SPOT SHOT
	PROPOSED TOP OF CURB / BOTTOM OF CURB SPOT SHOT
	PROPOSED FLUSH CURB SPOT SHOT
	PROPOSED DEPRESSED CURB / BOTTOM OF CURB SPOT SHOT
	PROPOSED TOP OF WALL / BOTTOM OF WALL SPOT SHOT

## GRADING NOTES

- ALL SOIL AND MATERIAL REMOVED FROM THE SITE SHALL BE DISPOSED OF IN ACCORDANCE WITH LOCAL, STATE, AND FEDERAL REQUIREMENTS. ANY GROUNDWATER DE-WATERING PRACTICES SHALL BE PERFORMED UNDER THE SUPERVISION OF A QUALIFIED PROFESSIONAL. THE CONTRACTOR IS REQUIRED TO OBTAIN ALL NECESSARY PERMITS FOR THE DISCHARGE OF DE-WATERED GROUNDWATER. ALL SOIL IMPORTED TO THE SITE SHALL BE CERTIFIED CLEAN FILL. CONTRACTOR SHALL MAINTAIN RECORDS OF ALL FILL MATERIALS BROUGHT TO THE SITE.
- THE CONTRACTOR IS REQUIRED TO PROVIDE TEMPORARY AND/OR PERMANENT SHORING WHERE REQUIRED DURING EXCAVATION ACTIVITIES INCLUDING BUT NOT LIMITED TO UTILITY TRENCHES. TO ENSURE THE STRUCTURAL INTEGRITY OF NEARBY STRUCTURES AND STABILITY OF THE SURROUNDING SOILS.
- PROPOSED TOP OF CURB ELEVATIONS ARE GENERALLY 4 INCHES TO 7 INCHES ABOVE EXISTING GRADES UNLESS OTHERWISE NOTED. THE CONTRACTOR WILL SUPPLY ALL STAKEOUT CURB GRADE SHEETS TO STONEFIELD ENGINEERING & DESIGN, LLC. FOR REVIEW AND APPROVAL PRIOR TO POURING CURBS.
- THE CONTRACTOR IS RESPONSIBLE TO SET ALL PROPOSED UTILITY COVERS AND RESET ALL EXISTING UTILITY COVERS WITHIN THE PROJECT LIMITS TO PROPOSED GRADE IN ACCORDANCE WITH ANY APPLICABLE MUNICIPAL, COUNTY, STATE AND/OR UTILITY AUTHORITY REGULATIONS.
- MINIMUM SLOPE REQUIREMENTS TO PREVENT PONDING SHALL BE AS FOLLOWS:
  - CURB GUTTER: 0.50%
  - CONCRETE SURFACES: 1.00%
  - ASPHALT SURFACES: 1.00%
- A MINIMUM SLOPE OF 1.00% SHALL BE PROVIDED AWAY FROM ALL BUILDINGS. THE CONTRACTOR SHALL ENSURE POSITIVE DRAINAGE FROM THE BUILDING IS ACHIEVED AND SHALL NOTIFY STONEFIELD ENGINEERING & DESIGN, LLC IF THIS CONDITION CANNOT BE MET.
- FOR PROJECTS WHERE BASEMENTS ARE PROPOSED, THE DEVELOPER IS RESPONSIBLE TO DETERMINE THE DEPTH TO GROUNDWATER AT THE LOCATION OF THE PROPOSED STRUCTURE. IF GROUNDWATER IS ENCOUNTERED WITHIN THE BASEMENT AREA, SPECIAL CONSTRUCTION METHODS SHALL BE UTILIZED AND REVIEWED/APPROVED BY THE CONSTRUCTION CODE OFFICIAL. IF SUMP PUMPS ARE UTILIZED, ALL DISCHARGES SHALL BE CONNECTED DIRECTLY TO THE PUBLIC STORM SEWER SYSTEM WITH APPROVAL FROM THE GOVERNING STORM SEWER SYSTEM AUTHORITY.

## ADA NOTES

- THE CONTRACTOR SHALL MAINTAIN A MAXIMUM 2.00% SLOPE IN ANY DIRECTION WITHIN THE ADA PARKING SPACES AND ACCESS AISLES.
- THE CONTRACTOR SHALL PROVIDE COMPLIANT SIGNAGE AT ALL ADA PARKING AREAS IN ACCORDANCE WITH STATE GUIDELINES.
- THE CONTRACTOR SHALL MAINTAIN A MAXIMUM 5.00% RUNNING SLOPE AND A MAXIMUM OF 2.00% CROSS SLOPE ALONG WALKWAYS WITHIN THE ACCESSIBLE PATH OF TRAVEL (SEE THE SITE PLAN FOR THE LOCATION OF THE ACCESSIBLE PATH). THE CONTRACTOR IS RESPONSIBLE TO ENSURE THE ACCESSIBLE PATH OF TRAVEL IS 36 INCHES WIDE OR GREATER UNLESS INDICATED OTHERWISE WITHIN THE PLAN SET.
- THE CONTRACTOR SHALL MAINTAIN A MAXIMUM 2.00% SLOPE IN ANY DIRECTION AT ALL LANDINGS. LANDINGS INCLUDE, BUT ARE NOT LIMITED TO, THE TOP AND BOTTOM OF AN ACCESSIBLE RAMP. AT ACCESSIBLE BUILDING ENTRANCES AT AN AREA IN FRONT OF A WALK-UP ATM, AND AT TURNING SPACES ALONG THE ACCESSIBLE PATH OF TRAVEL, THE LANDING AREA SHALL HAVE A MINIMUM CLEAR AREA OF 60 INCHES BY 60 INCHES UNLESS INDICATED OTHERWISE WITHIN THE PLAN SET.
- THE CONTRACTOR SHALL MAINTAIN A MAXIMUM 8.33% RUNNING SLOPE AND A MAXIMUM 2.00% CROSS SLOPE ON ANY CURB RAMPS ALONG THE ACCESSIBLE PATH OF TRAVEL. WHERE PROVIDED, CURB RAMP FLARES SHALL NOT HAVE A SLOPE GREATER THAN 10.00%. IF A LANDING AREA IS PROVIDED AT THE TOP OF THE RAMP, FOR ALTERATIONS, A CURB RAMP FLARE SHALL NOT HAVE A SLOPE GREATER THAN 8.33% IF A LANDING AREA IS NOT PROVIDED AT THE TOP OF THE RAMP. CURB RAMPS SHALL NOT RISE MORE THAN 6 INCHES IN ELEVATION WITHOUT A HANDRAIL. THE CLEAR WIDTH OF A CURB RAMP SHALL BE NO LESS THAN 36 INCHES WIDE.
- ACCESSIBLE RAMPS WITH A RISE GREATER THAN 6 INCHES SHALL CONTAIN COMPLIANT HANDRAILS ON BOTH SIDES OF THE RAMP AND SHALL NOT RISE MORE THAN 30" IN ELEVATION WITHOUT A LANDING AREA IN BETWEEN RAMP RUNS. LANDING AREAS SHALL ALSO BE PROVIDED AT THE TOP AND BOTTOM OF THE RAMP.
- A SLIP RESISTANT SURFACE SHALL BE CONSTRUCTED ALONG THE ACCESSIBLE PATH AND WITHIN ADA PARKING AREAS.
- THE CONTRACTOR SHALL ENSURE A MAXIMUM OF 1/4 INCHES VERTICAL CHANGE IN LEVEL ALONG THE ACCESSIBLE PATH. WHERE A CHANGE IN LEVEL BETWEEN 1/4 INCHES AND 1/2 INCHES EXISTS, CONTRACTOR SHALL ENSURE THAT THE TOP 1/4 INCH CHANGE IN LEVEL IS BEVELED WITH A SLOPE NOT STEEPER THAN 1 UNIT VERTICAL AND 2 UNITS HORIZONTAL (2:1 SLOPE).
- THE CONTRACTOR SHALL ENSURE THAT ANY OPENINGS (GAPS OR HORIZONTAL SEPARATIONS) ALONG THE ACCESSIBLE PATH SHALL NOT ALLOW PASSAGE OF A SPHERE GREATER THAN 1/4 INCH.

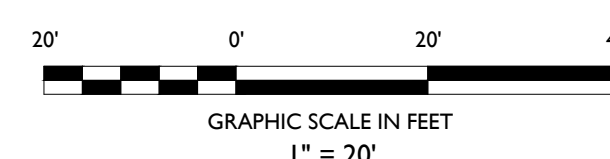

NOT APPROVED FOR CONSTRUCTION

STONEFIELD  
engineering & designRutherford, NJ • New York, NY • Boston, MA  
Princeton, NJ • Tampa, FL • Detroit, MI

www.stonefielddesign.com

1 Beacon Street, 15 Floor, Boston, MA 02108

Phone 617.203.2076

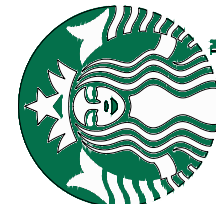
SITE PLAN SET  
ALRIG USA DEVELOPMENT, LLCPROPOSED STARBUCKS WITH  
DRIVE-THRU FACILITIESBOOK 10890, PG. 21 E, BOOK 4320, PG. 247 / BOOK 8163, PG. 289  
MAP 91, LOTS 275, 168, & 149  
0 & 8 MITCHELL STREET  
CITY OF NEW BEDFORD  
BRISTOL COUNTY, MASSACHUSETTSSTONEFIELD  
engineering & design

SCALE: 1" = 20' PROJECT ID: BOS-200026

TITLE:

GRADING PLAN

DRAWING:

C-5











Z:\0707\080320\080320002\ALRIG USA DEVELOPMENT, LLC\COGGESHALL STREET & MITCHELL STREET\NEW BEDFORD\MA\CAD\DWG\01.DWG\LANDSCAPING

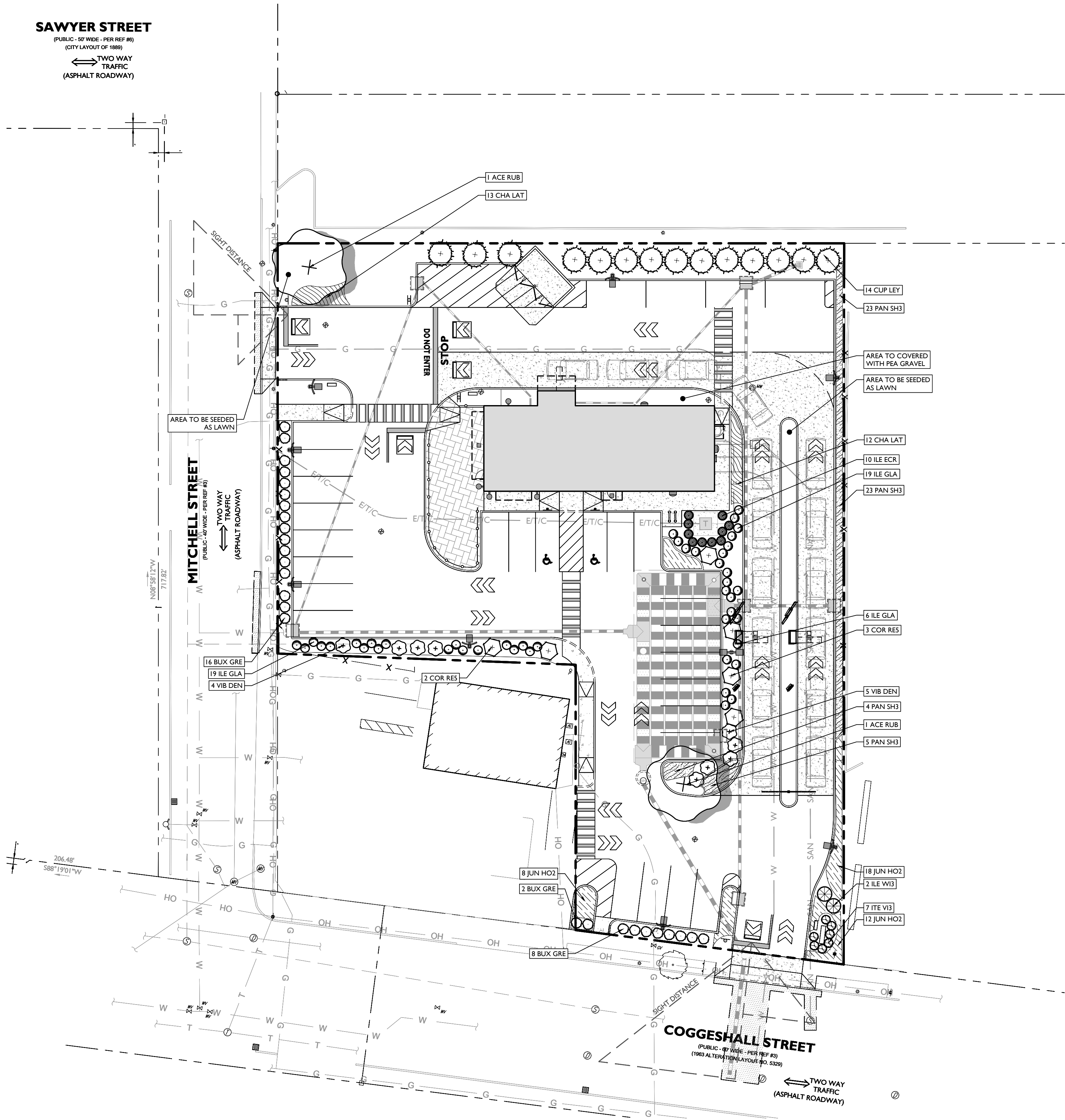

LANDSCAPING AND BUFFER REQUIREMENTS		
CODE SECTION	REQUIRED	PROPOSED
§ 3312- SCREENING AND LANDSCAPING	TO SEPARATE DIFFERENT AND OTHERWISE INCOMPATIBLE LAND USES FROM EACH OTHER IN ORDER TO PARTIALLY OR COMPLETELY REDUCE OR OBSCURE POTENTIAL NUISANCES SUCH AS DIRT, DUST, LITTER, NOISE, GLARE FROM MOTOR VEHICLE HEADLIGHTS, INTRUSION FROM ARTIFICIAL LIGHT (INCLUDING AMBIENT GLARE), OR VIEW OF SIGNS, UNSIGHTLY BUILDINGS OR PARKING LOTS.	COMPLIES
§ 3313- SCREENING AND LANDSCAPING	TO PROVIDE VISUAL RELIEF TO PARKING LOTS AND PROTECTION FROM WIND IN OPEN AREAS.	COMPLIES
§ 3314- SCREENING AND LANDSCAPING	TO PRESERVE OR IMPROVE THE VISUAL AND ENVIRONMENTAL CHARACTER OF NEW BEDFORD, AS GENERALLY VIEWED FROM RESIDENTIAL OR PUBLICLY ACCESSIBLE LOCATIONS; AND	COMPLIES
§ 3331- SCREENING AND LANDSCAPING	A SCREEN MAY CONSIST OF PLANT MATERIALS, AT LEAST THREE (3) FEET IN HEIGHT AT THE TIME OF PLANTING WHICH WILL PROVIDE A COMPACT DENSE FORM YEAR-ROUND AND WILL REACH A HEIGHT AT MATURITY OF AT LEAST SIX (6) FEET OR A MASONRY WALL OR WOODEN FENCE DESIGNED IN AN ATTRACTIVE MANNER TO VISUALLY OBSCURE.	COMPLIES
§ 3332- SCREENING AND LANDSCAPING	A SCREEN SHALL OCCUPY A STRIP OF LAND AT LEAST FIVE (5) FEET IN WIDTH ALONG A PROPERTY LINE OR ALONG THE PERIMETER OF A STORAGE AREA, WHERE A SCREEN CONSISTS OF A MASONRY WALL, WOODEN FENCE OR A VINYL FENCE PRODUCED TO RESEMBLE A CLASSICAL WOODEN FENCE. THE REMAINDER OF THE REQUIRED FIVE-FOOT STRIP SHALL BE LANDSCAPED WITH TREES AND SHRUBS.	COMPLIES

PLANT SCHEDULE							
TREES	CODE	QTY	BOTANICAL NAME	COMMON NAME	SIZE	CONTAINER	REMARKS
	CUP LEY	14	X CUPRESSOCYPARIS LEYLANDII	LEYLANDI CYPRESS	6' HT	B&B	NATIVE
	ACE RUB	2	ACER RUBRUM	RED MAPLE	2.5" - 3" CAL	B&B	NATIVE
SHRUBS	CODE	QTY	BOTANICAL NAME	COMMON NAME	SIZE	CONTAINER	REMARKS
	COR RES	5	CORNUS SERICEA	RED TWIG DOGWOOD	36"HT	POT	NATIVE
	ILE W3	2	ILEX VERTICILLATA	WINTERBERRY	36"HT	POT	NATIVE
	ITE V3	7	ITEA VIRGINICA 'VIRGINIA'	VIRGINIA SWEETSPIRE	36"HT	POT	NATIVE
	VIB DEN	9	VIBURNUM DENTATUM 'ARROWWOOD'	ARROWWOOD VIBURNUM	36"HT	POT	NATIVE
EVERGREEN SHRUBS	CODE	QTY	BOTANICAL NAME	COMMON NAME	SIZE	CONTAINER	REMARKS
	ILE ECR	10	ILEX CRENATA 'FASTIGIATA'	COLUMNAR JAPANESE HOLLY	48" HT	POT	----
	ILE GLA	44	ILEX GLABRA	INKBERRY HOLLY	36"HT	POT	NATIVE
	BUX GRE	26	BUXUS X 'GREEN VELVET'	GREEN VELVET BOXWOOD	18"-24"	B&B	----
SHRUB AREAS	CODE	QTY	BOTANICAL NAME	COMMON NAME	SIZE	SPACING	REMARKS
	CHA LAT	25	CHASMANTHIUM LATIFOLIUM	NORTHERN SEA OATS	1 GAL	36" o.c.	NATIVE
	JUN HO2	38	JUNIPERUS HORIZONTALIS	CREEPING JUNIPER	1 GAL	36" o.c.	NATIVE
	PAN SH3	55	PANICUM VIRGATUM 'SHENANDOAH'	SWITCH GRASS	7 GAL	48" o.c.	NATIVE

NOTE: IF ANY DISCREPANCIES OCCUR BETWEEN AMOUNTS SHOWN ON THE LANDSCAPE PLAN AND WITHIN THE PLANT LIST, THE PLAN SHALL DICTATE.

- LANDSCAPING NOTES**
- THE CONTRACTOR SHALL RESTORE ALL DISTURBED GRASS AND LANDSCAPED AREAS TO MATCH EXISTING CONDITIONS UNLESS INDICATED OTHERWISE WITHIN THE PLAN SET.
  - THE CONTRACTOR SHALL RESTORE ALL DISTURBED LAWN AREAS WITH A MINIMUM 4 INCH LAYER OF TOPSOIL AND SEED.
  - THE CONTRACTOR SHALL RESTORE MULCH AREAS WITH A MINIMUM 3 INCH LAYER OF MULCH.
  - THE MAXIMUM SLOPE ALLOWABLE IN LANDSCAPE RESTORATION AREAS SHALL BE 3 FEET HORIZONTAL TO 1 FOOT VERTICAL (3:1 SLOPE) UNLESS INDICATED OTHERWISE WITHIN THE PLAN SET.
  - THE CONTRACTOR IS REQUIRED TO LOCATE ALL SPRINKLER HEADS IN AREA OF LANDSCAPING DISTURBANCE PRIOR TO CONSTRUCTION. THE CONTRACTOR SHALL RELOCATE SPRINKLER HEADS AND LINES IN ACCORDANCE WITH OWNER'S DIRECTION WITHIN AREAS OF DISTURBANCE.
  - THE CONTRACTOR SHALL ENSURE THAT ALL DISTURBED LANDSCAPED AREAS ARE GRADED TO MEET FLUSH AT THE ELEVATION OF WALKWAYS AND TOP OF CURB ELEVATIONS EXCEPT UNLESS INDICATED OTHERWISE WITHIN THE PLAN SET. NO ABRUPT CHANGES IN GRADE ARE PERMITTED IN DISTURBED LANDSCAPING AREAS.

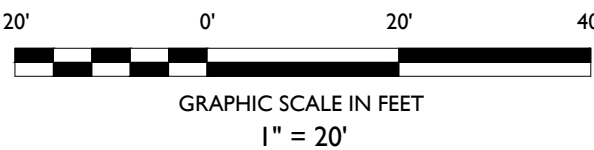

REVISED PER BOARD COMMENTS		ISSUED FOR REVIEW		ISSUED FOR REVIEW		DESCRIPTION
DATE	BY	DATE	BY	DATE	BY	
09/28/2021	JT	09/03/2021	CHG	07/01/2021	CHG	ISSUE
03	02	01				

NOT APPROVED FOR CONSTRUCTION



Rutherford, NJ • New York, NY • Boston, MA  
Princeton, NJ • Tampa, FL • Detroit, MI  
www.stonefielddeng.com  
1 Beacon Street, 15 Floor, Boston, MA 02108  
Phone 617.203.2076

**ALRIG USA DEVELOPMENT, LLC**

**PROPOSED STARBUCKS WITH DRIVE-THRU FACILITIES**

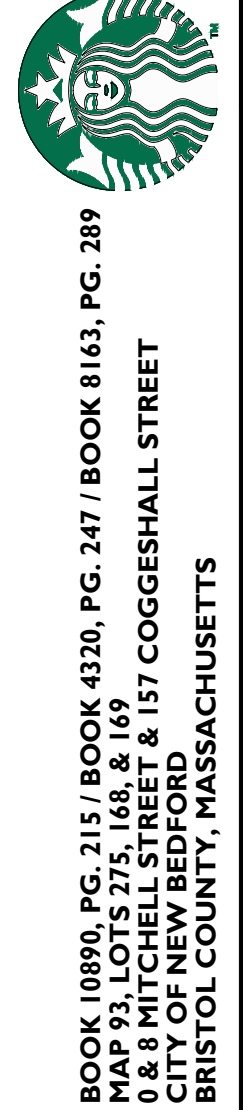

BOOK 10890, PG. 215 / BOOK 4320, PG. 247 / BOOK 8163, PG. 289  
MAP 93, LOTS 275, 168, & 149  
0 & 8 MITCHELL STREET & 157 COGGESHALL STREET  
CITY OF NEW BEDFORD  
BRISTOL COUNTY, MASSACHUSETTS

JAKE MODESTOW, P.E.  
MASSACHUSETTS LICENSE NO. 6201065336  
LICENSED PROFESSIONAL ENGINEER



SCALE: 1" = 20' PROJECT ID: BOS-200026

TITLE:

LANDSCAPING PLAN

DRAWING:

C-8



NOTES:

- FOR CONTAINER-GROWN TREES, USE FINGERS OR SMALL HAND TOOLS TO PULL THE ROOTS OUT OF THE OUTER LAYER OF POTTING SOIL; THEN CUT OR PULL APART ANY ROOTS CIRCULING THE PERIMETER OF THE CONTAINER.
- THOROUGHLY SOAK THE TREE ROOT BALL AND ADJACENT PREPARED SOIL SEVERAL TIMES DURING THE FIRST MONTH AFTER PLANTING AND REGULARLY THROUGHOUT THE FOLLOWING TWO SUMMERS.
- SOIL AMENDMENTS:
  - MODIFY HEAVY CLAY OR SILT SOILS (MORE THAN 40% CLAY OR SILT) BY ADDING COMPOSTED PINE BARK (UP TO 30% BY VOLUME) OR GYPSUM.
  - MODIFY EXTREMELY SANDY SOILS (MORE THAN 85% SAND) BY ADDING ORGANIC MATTER AND/OR DRY, SHREDDED CLAY LOAM UP TO 30% OF THE TOTAL MIX.

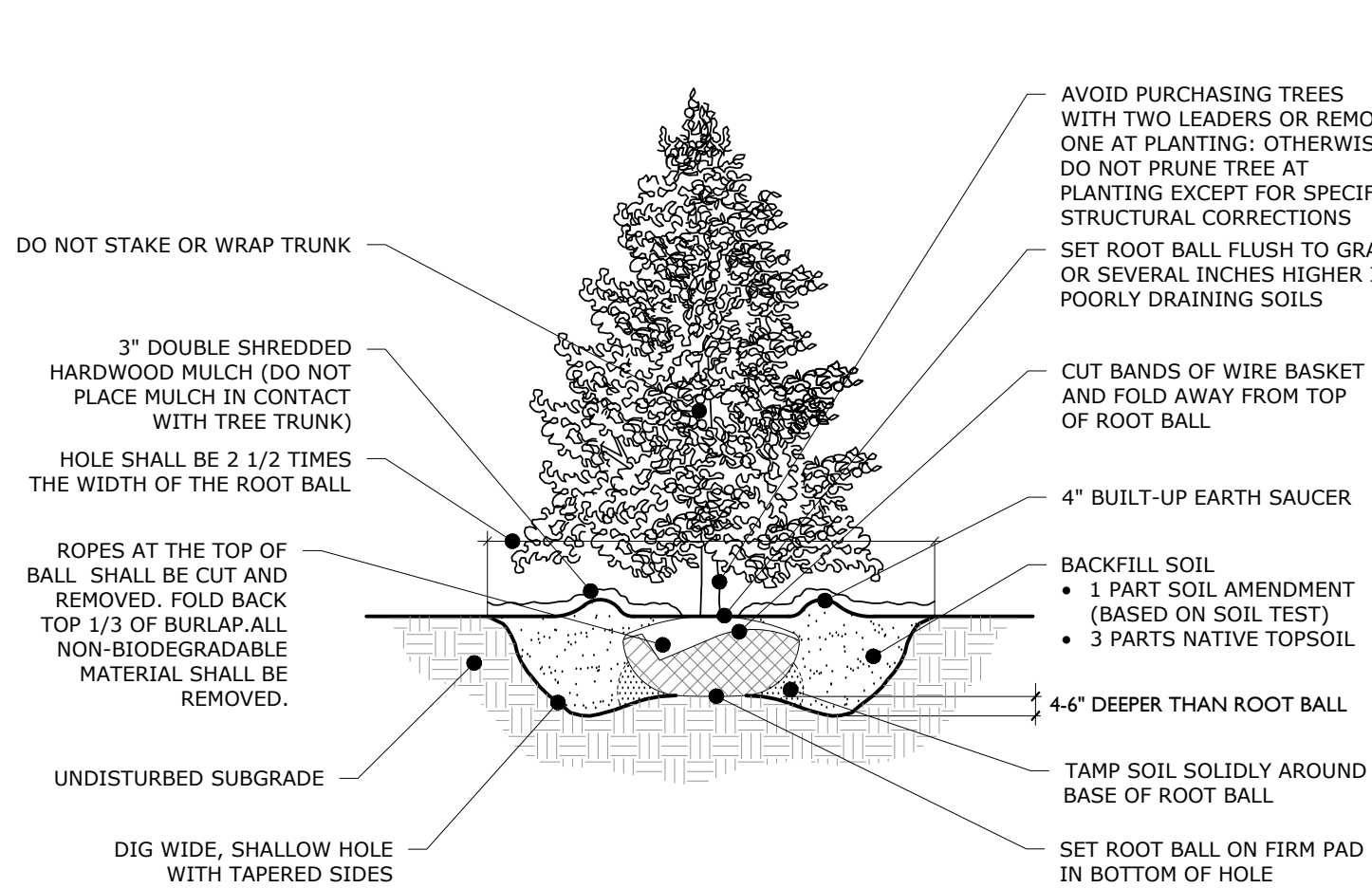

EVERGREEN TREE PLANTING DETAIL

NOT TO SCALE

NOTES:

- FOR THE CONTAINER-GROWN SHRUBS, USE FINGERS OR SMALL HAND TOOL TO PULL THE ROOTS OUT OF THE OUTER LAYER OF POTTING SOIL; THEN CUT OR PULL APART ANY ROOTS CIRCULING THE PERIMETER OF THE CONTAINER.
- THOROUGHLY SOAK THE SHRUB ROOT BALL AND ADJACENT PREPARED SOIL SEVERAL TIMES DURING THE FIRST MONTH AFTER PLANTING AND REGULARLY THROUGHOUT THE FOLLOWING TWO SUMMERS.
  - MODIFY HEAVY CLAY OR SILT SOILS (MORE THAN 40% CLAY OR SILT) BY ADDING COMPOSTED PINE BARK (UP TO 30% BY VOLUME) OR GYPSUM.
  - MODIFY EXTREMELY SANDY SOILS (MORE THAN 85% SAND) BY ADDING ORGANIC MATTER AND/OR DRY, SHREDDED CLAY LOAM UP TO 30% OF THE TOTAL.

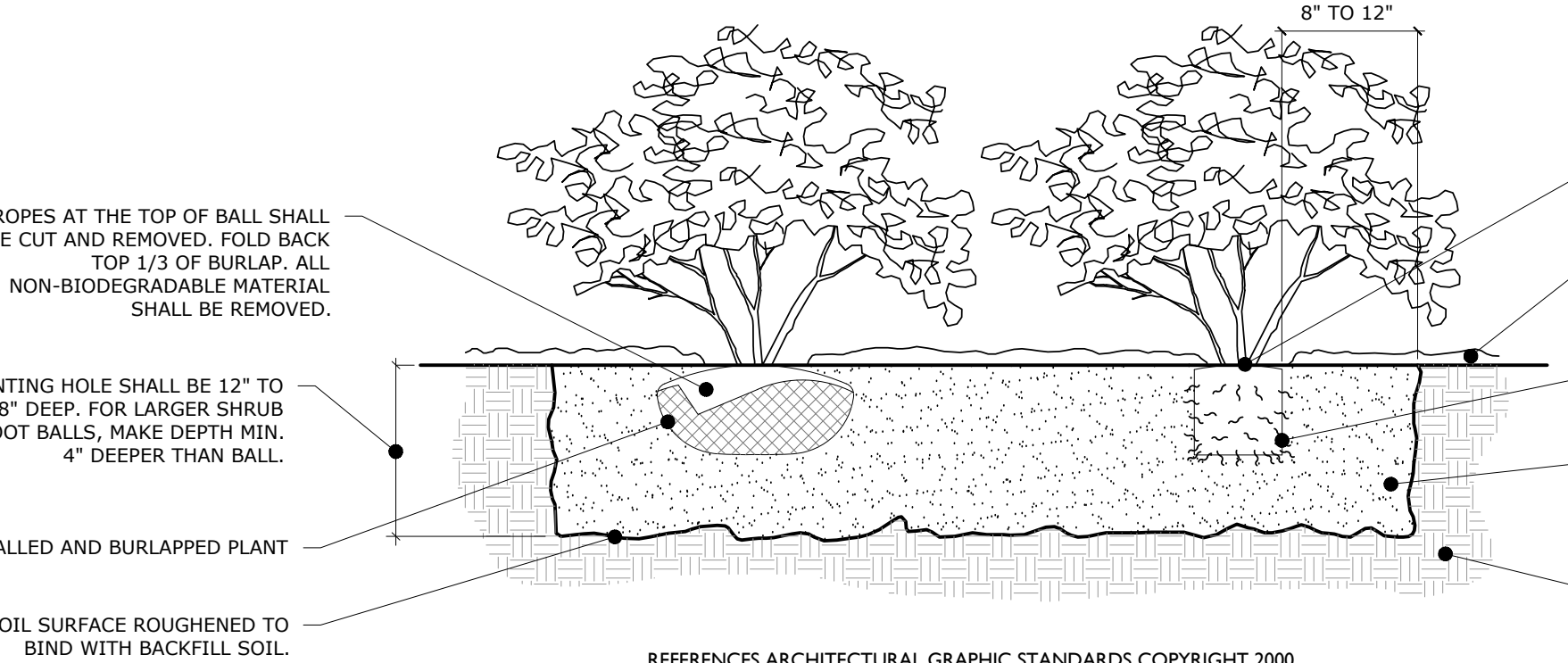

DECIDUOUS AND EVERGREEN SHRUB PLANTING DETAIL

NOT TO SCALE

NOTES:

- THOROUGHLY SOAK THE GROUND COVER ROOT BALL AND ADJACENT PREPARED SOIL SEVERAL TIMES DURING THE FIRST MONTH AFTER PLANTING AND REGULARLY THROUGHOUT THE FOLLOWING TWO SUMMERS.
- SOIL AMENDMENTS:
  - MODIFY HEAVY CLAY OR SILT SOILS (MORE THAN 40% CLAY OR SILT) BY ADDING COMPOSTED PINE BARK (UP TO 30% BY VOLUME) OR GYPSUM.
  - MODIFY EXTREMELY SANDY SOILS (MORE THAN 85% SAND) BY ADDING ORGANIC MATTER AND/OR DRY, SHREDDED CLAY LOAM UP TO 30% OF THE TOTAL MIX.
- ALL GROUND COVER AREAS SHALL BE TREATED WITH A PRE-EMERGENT PER MANUFACTURER'S SPECIFICATIONS.

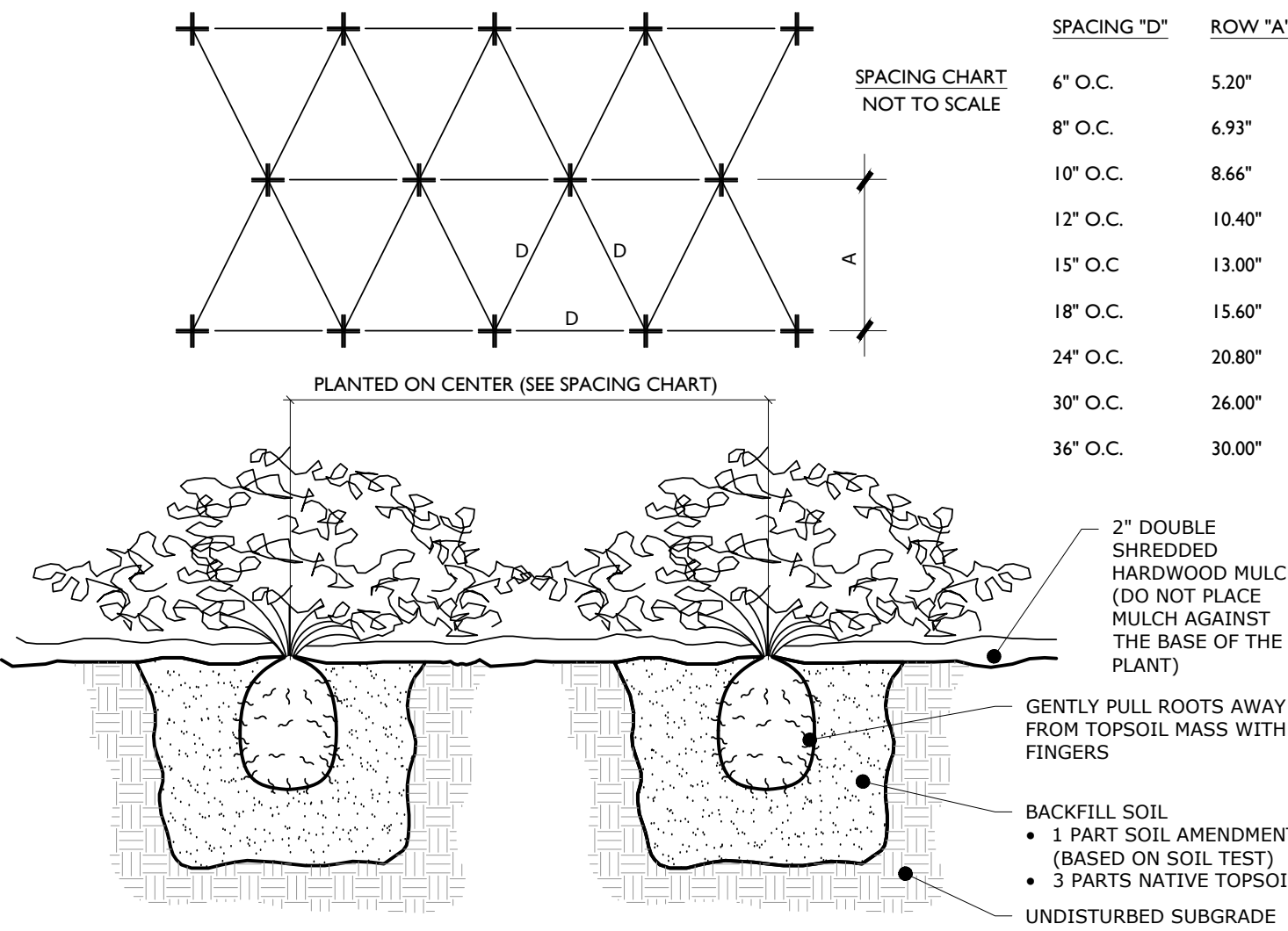

GROUND COVER/PERENNIAL/ANNUAL PLANTING DETAIL

NOT TO SCALE

NOTES:

- FOR CONTAINER-GROWN TREES, USE FINGERS OR SMALL HAND TOOLS TO PULL THE ROOTS OUT OF THE OUTER LAYER OF POTTING SOIL; THEN CUT OR PULL APART ANY ROOTS CIRCULING THE PERIMETER OF THE CONTAINER.
- THOROUGHLY SOAK THE TREE ROOT BALL AND ADJACENT PREPARED SOIL SEVERAL TIMES DURING THE FIRST MONTH AFTER PLANTING AND REGULARLY THROUGHOUT THE FOLLOWING TWO SUMMERS.
- SOIL AMENDMENTS:
  - MODIFY HEAVY CLAY OR SILT SOILS (MORE THAN 40% CLAY OR SILT) BY ADDING COMPOSTED PINE BARK (UP TO 30% BY VOLUME) OR GYPSUM.
  - MODIFY EXTREMELY SANDY SOILS (MORE THAN 85% SAND) BY ADDING ORGANIC MATTER AND/OR DRY, SHREDDED CLAY LOAM UP TO 30% OF THE TOTAL MIX.

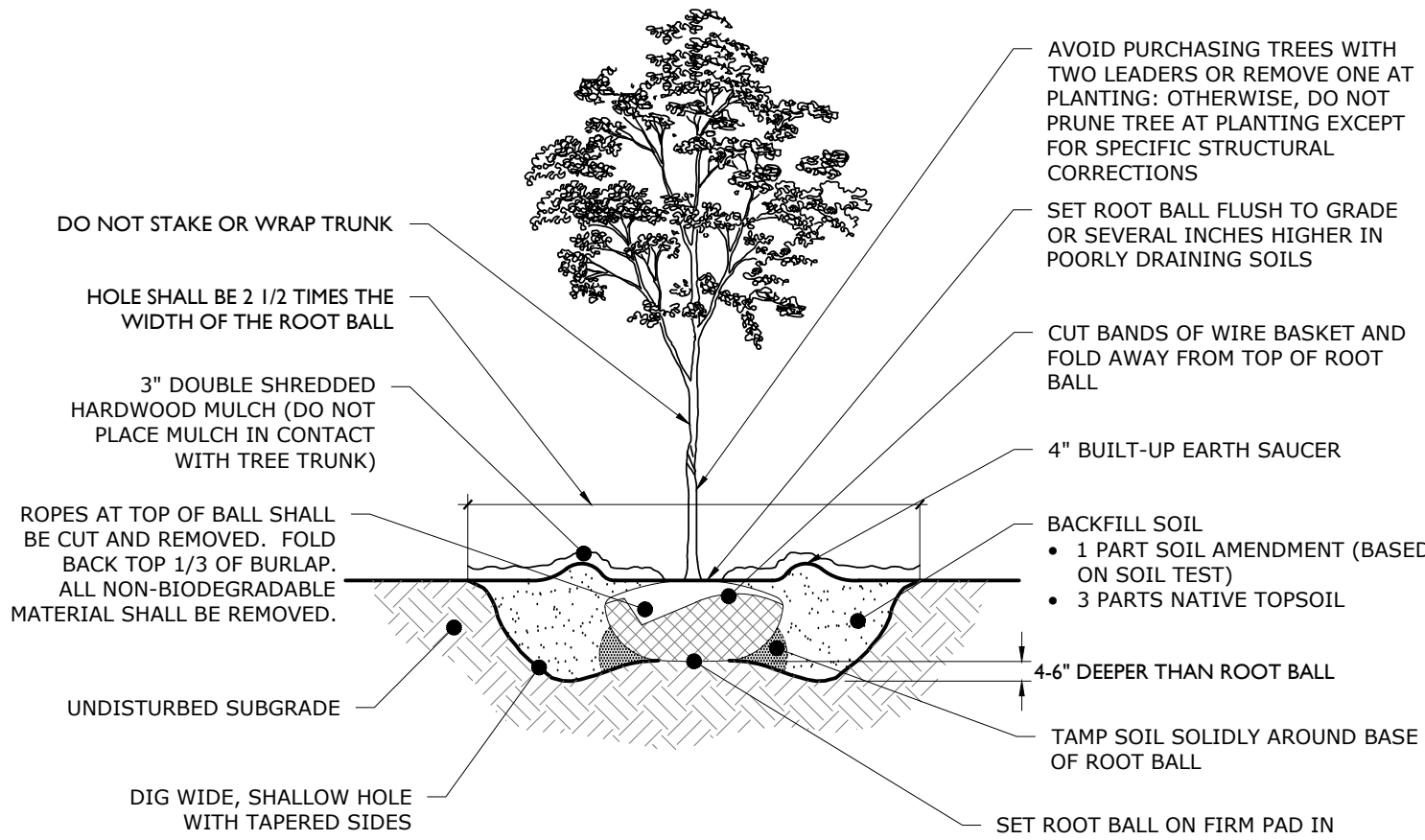

DECIDUOUS TREE PLANTING DETAIL

NOT TO SCALE

GENERAL LANDSCAPING NOTES:

- THE LANDSCAPE CONTRACTOR SHALL FURNISH ALL MATERIALS AND PERFORM ALL WORK IN ACCORDANCE WITH THESE SPECIFICATIONS, APPROVED OR FINAL DRAWINGS, AND INSTRUCTIONS PROVIDED BY THE PROJECT LANDSCAPE DESIGNER, MUNICIPAL OFFICIALS, OR OWNER/OWNER'S REPRESENTATIVE. ALL WORK COMPLETED AND MATERIALS FURNISHED AND INSTALLED SHALL BE IN STRICT ACCORDANCE WITH THE INTENTION OF THE SPECIFICATIONS, DRAWINGS, AND INSTRUCTIONS AND EXECUTED WITH THE STANDARD LEVEL OF CARE FOR THE LANDSCAPE INDUSTRY.
- WORK MUST BE CARRIED OUT ONLY DURING WEATHER CONDITIONS FAVORABLE TO LANDSCAPE CONSTRUCTION AND TO THE HEALTH AND WELFARE OF PLANTS. THE SUITABILITY OF SUCH WEATHER CONDITIONS SHALL BE DETERMINED BY THE PROJECT LANDSCAPE DESIGNER OR GOVERNING MUNICIPAL OFFICIAL.
- IT IS THE RESPONSIBILITY OF THE LANDSCAPE CONTRACTOR, BEFORE ORDERING OR PURCHASING MATERIALS, TO PROVIDE SAMPLES OF THOSE MATERIALS TO THE PROJECT LANDSCAPE DESIGNER OR GOVERNING MUNICIPAL OFFICIAL FOR APPROVAL, IF REQUESTED.
- IF SAMPLES ARE REQUESTED, THE LANDSCAPE CONTRACTOR IS TO SUBMIT CERTIFICATION TAGS FROM TREES, SHRUBS AND SEED VERIFYING TYPE AND PURITY.
- UNLESS OTHERWISE AUTHORIZED BY THE PROJECT LANDSCAPE DESIGNER OR GOVERNING MUNICIPAL OFFICIAL, THE LANDSCAPE CONTRACTOR SHALL PROVIDE NOTICE AT LEAST FORTY-EIGHT HOURS (48 HRS) IN ADVANCE OF THE ANTICIPATED DELIVERY DATE OF ANY PLANT MATERIALS TO THE PROJECT SITE. A LEGIBLE COPY OF THE INVOICE, SHOWING VARIETIES AND SIZES OF MATERIALS INCLUDED FOR EACH SHIPMENT SHALL BE FURNISHED TO THE PROJECT LANDSCAPE DESIGNER, OR GOVERNING MUNICIPAL OFFICIAL.
- THE PROJECT LANDSCAPE DESIGNER OR GOVERNING MUNICIPAL OFFICIAL RESERVES THE RIGHT TO INSPECT AND REJECT PLANTS AT ANY TIME AND AT ANY PLACE.

PROTECTION OF EXISTING VEGETATION NOTES:

- BEFORE COMMENCING WORK, ALL EXISTING VEGETATION WHICH COULD BE IMPACTED AS A RESULT OF THE PROPOSED CONSTRUCTION ACTIVITIES MUST BE PROTECTED FROM DAMAGE BY THE INSTALLATION OF TREE PROTECTION FENCING. FENCING SHALL BE LOCATED AT THE DRIPLINE OR LIMIT OF DISTURBANCE AS DEPICTED WITHIN THE APPROVED OR FINAL PLAN. SET, ESTABLISHING THE TREE PROTECTION ZONE. FENCE INSTALLATION SHALL BE IN ACCORDANCE WITH THE PROVIDED "TREE PROTECTION FENCE DETAIL." NO WORK MAY BEGIN UNTIL THIS REQUIREMENT IS FULFILLED. THE FENCING SHALL BE INSPECTED REGULARLY BY THE LANDSCAPE CONTRACTOR AND MAINTAINED UNTIL ALL CONSTRUCTION ACTIVITIES HAVE BEEN COMPLETED.
- IN ORDER TO PREVENT DAMAGE TO ROOTS, BARK OR LOWER BRANCHES, NO VEHICLE, EQUIPMENT, DEBRIS, OR OTHER MATERIALS SHALL BE DRIVEN, PARKED OR PLACED WITHIN THE TREE PROTECTION ZONE. ALL ON-SITE CONTRACTORS SHALL USE ANY AND ALL PRECAUTIONARY MEASURES WHEN PERFORMING WORK AROUND TREES, WALKS, PAVEMENTS, UTILITIES, AND ANY OTHER FEATURES EITHER EXISTING OR PREVIOUSLY INSTALLED UNDER THIS CONTRACT.
- IN RARE INSTANCES WHERE EXCAVATION, FILL, OR GRADING IS REQUIRED WITHIN THE DRIPLINE OF TREES TO REMAIN, THE WORK SHALL BE PERFORMED AS FOLLOWS:
  - TRENCHING: WHEN TRENCHING OCCURS AROUND TREES TO REMAIN, THE TREE ROOTS SHALL NOT BE CUT, BUT THE TRENCH SHALL BE TUNNELED UNDER OR AROUND THE ROOTS BY CAREFUL HAND DIGGING AND WITHOUT INJURY TO THE ROOTS. NO ROOTS, LIMBS, OR WOODS ARE TO HAVE ANY PAINT OR MATERIAL APPLIED TO ANY SURFACE.
  - RAISING GRADES: WHEN THE GRADE AT AN EXISTING TREE IS BELOW THE NEW FINISHED GRADE, AND FILL NOT EXCEEDING 6 INCHES (6") IS REQUIRED, CLEAN, WASHED GRAVEL FROM ONE TO TWO INCHES (1" - 2") IN SIZE SHALL BE PLACED DIRECTLY AROUND THE TREE TRUNK. THE GRAVEL SHALL EXTEND OUT FROM THE TRUNK ON ALL SIDES A MINIMUM OF 18 INCHES (18") ABOVE FINISHED GRADE AT THE TRUNK. THE GRAVEL SHALL BE PLACED IN A MINIMUM OF 6 INCHES (6") OF TOPSOIL. NO ROOTS, LIMBS, OR WOODS ARE TO HAVE ANY PAINT OR MATERIAL APPLIED TO ANY SURFACE.
  - LOWERING GRADES: EXISTING TREES LOCATED IN AREAS WHERE THE NEW FINISHED GRADE IS TO BE LOWERED, SHALL HAVE RE-GRADING WORK DONE BY HAND TO THE INDICATED ELEVATION, NO GREATER THAN SIX INCHES (6"). ROOTS SHALL BE CUT CLEANLY THREE INCHES (3") BELOW FINISHED GRADE UNDER THE DIRECTION OF A LICENSED ARBORIST. WHERE CUT EXCEEDING 6 INCHES (6") IS REQUIRED, A DRY LAID RETAINING WALL SHALL BE CONSTRUCTED. IF APPLICABLE, THE RETAINING WALL INSTALLATION SHALL BE IN ACCORDANCE WITH THE PROVIDED "TREE RETAINING WALL DETAIL."

SOIL PREPARATION AND MULCH NOTES:

- LANDSCAPE CONTRACTOR SHALL OBTAIN A SOIL TEST OF THE IN-SITU TOPSOIL BY A CERTIFIED SOIL LABORATORY PRIOR TO PLANTING. LANDSCAPE CONTRACTOR SHALL ALLOW FOR A TWO WEEK TURNAROUND TIME FROM SUBMITTAL OF SAMPLE TO NOTIFICATION OF RESULTS.
- BASED ON SOIL TEST RESULTS, ADJUST THE RATES OF LIME AND FERTILIZER THAT SHALL BE MIXED INTO THE TOP SIX INCHES (6") OF TOPSOIL. THE LIME AND FERTILIZER RATES PROVIDED WITHIN THE "SEED SPECIFICATION" OR "SOD SPECIFICATION" IS APPROXIMATE AND FOR BIDDING PURPOSES ONLY. IF ADDITIONAL AMENDMENTS ARE NECESSARY, ADJUST THE TOPSOIL AS FOLLOWS:
  - MODIFY HEAVY CLAY OR SILT SOILS (MORE THAN 40% CLAY OR SILT) BY ADDING COMPOSTED PINE BARK (UP TO 30% BY VOLUME) OR GYPSUM.
  - MODIFY EXTREMELY SANDY SOILS (MORE THAN 85%) BY ADDING ORGANIC MATTER AND/OR DRY, SHREDDED CLAY LOAM UP TO 30% OF THE TOTAL MIX.
- TOPSOIL SHALL BE FERTILE, FRIABLE, NATURAL TOPSOIL OF LOAMING CHARACTER, WITHOUT ADMIXTURE OF SUBSOIL MATERIAL, OBTAINED FROM A WELL-DRAINED ARABLE SITE, FREE FROM ALL CLAY, LUMPS, COARSE SANDS, STONES, PLANTS, ROOTS, STICKS, AND OTHER FOREIGN MATERIAL GREATER THAN ONE INCH (1").
- TOPSOIL SHALL HAVE A PH RANGE OF 5.0-7.0 AND SHALL NOT CONTAIN LESS THAN 6% ORGANIC MATTER BY WEIGHT.
- OBTAIN TOPSOIL ONLY FROM LOCAL SOURCES OR FROM AREAS HAVING SIMILAR SOIL CHARACTERISTICS TO THAT FOUND AT THE PROJECT SITE.
- CONTRACTOR SHALL PROVIDE A SIX INCH (6") DEEP LAYER OF TOPSOIL IN ALL PLANTING AREAS. TOPSOIL SHALL BE SPREAD OVER A PREPARED SURFACE IN A UNIFORM LAYER TO ACHIEVE THE DESIRED COMPACTED THICKNESS. THE SPREADING OF TOPSOIL SHALL NOT BE CONDUCTED UNDER MUDDY OR FROZEN SOIL CONDITIONS.
- UNLESS OTHERWISE NOTED IN THE CONTRACT, THE LANDSCAPE CONTRACTOR SHALL BE RESPONSIBLE FOR THE INSTALLATION OF TOPSOIL AND THE ESTABLISHMENT OF FINE GRADING WITHIN THE DISTURBED AREA OF THE SITE.
- LANDSCAPE CONTRACTOR SHALL VERIFY THAT THE SUB-GRADE ELEVATION MEETS THE FINISHED GRADE ELEVATION (LESS THE REQUIRED TOPSOIL), IN ACCORDANCE WITH THE APPROVED OR FINAL GRADING PLAN.
- ALL LAWN AND PLANTING AREAS SHALL BE GRADED TO A SMOOTH, EVEN AND UNIFORM PLANE WITH NO ABRUPT CHANGE OF SURFACE AS DEPICTED WITHIN THE APPROVED OR FINAL CONSTRUCTION SET UNLESS OTHERWISE DIRECTED BY THE PROJECT LANDSCAPE DESIGNER OR MUNICIPAL OFFICIAL.
- THE CONTRACTOR SHALL BE RESPONSIBLE FOR PROPER SURFACE AND SUBSURFACE PLANT BED DRAINAGE PRIOR TO THE INSTALLATION OF PLANTINGS. IF POOR DRAINAGE CONDITIONS EXIST, CORRECTIVE ACTION SHALL BE TAKEN PRIOR TO INSTALLATION. ALL PLANTING AND LAWN AREAS SHALL BE GRADED AND MAINTAINED TO ALLOW A FREE FLOW OF SURFACE WATER.
- DOUBLE SHREDDED HARDWOOD MULCH OR APPROVED EQUAL SHALL BE USED AS A THREE INCH (3") TOP DRESSING IN ALL SHRUB PLANTING BEDS AND AROUND ALL TREES PLANTED BY LANDSCAPE CONTRACTOR, GROUND COVER, PERENNIAL, AND ANNUAL PLANTING BEDS SHALL BE MULCHED WITH A TWO INCH (2") TOP DRESSING. SINGLE TREES OR SHRUBS SHALL BE MULCHED TO AVOID CONTACT WITH TRUNK OR PLANT STEM. MULCH SHALL BE OF SUFFICIENT CHARACTER AS NOT TO BE EASILY DISPLACED BY WIND OR WATER RUNOFF.
- WHENEVER POSSIBLE, THE SOIL PREPARATION AREA SHALL BE CONNECTED FROM PLANTING TO PLANTING.
- SOIL SHALL BE LOOSENEED WITH A BACKHOE OR OTHER LARGE COARSE-TILING EQUIPMENT UNLESS THE SOIL IS FROZEN OR EXCESSIVELY WET. TILING THAT PRODUCES LARGE, COARSE CHUNKS OF SOIL IS PREFERABLE TO TILING THAT RESULTS IN FINE GRAINS UNIFORM IN TEXTURE. AFTER THE AREA IS LOOSENEED IT SHALL NOT BE DRIVEN OVER BY ANY VEHICLE.
- APPLY PRE-EMERGENT WEED CONTROL TO ALL PLANT BEDS PRIOR TO MULCHING. ENSURE COMPATIBILITY BETWEEN PRODUCT AND PLANT MATERIAL.
- ALL PLANTING SOIL SHALL BE AMENDED WITH THE FOLLOWING:

**MYCORB® TREE SAVER** - A DRY GRANULAR MYCORRHIZAL FUNGI INOCULANT THAT IS MIXED IN THE BACKFILL WHEN PLANTING TREES AND SHRUBS. IT CONTAINS SPORES OF BOTH ECTOMYCORRHIZAL AND VA MYCORRHIZAL FUNGI (VAM), BENEFICIAL RHIZOSPHERE BACTERIA, TERRA-SORB SUPERABSORBENT HYDROGEL TO REDUCE WATER LEACHING, AND SELECTED ORGANIC MICROBIAL NUTRIENTS.

- DIRECTIONS FOR USE: USE 3-OZ PER EACH FOOT DIAMETER OF THE ROOT BALL, OR 3-OZ PER INCH CALIPER, MIX INTO THE BACKFILL WHEN TRANSPLANTING TREES AND SHRUBS. MIX PRODUCT IN A RING-SHAPED VOLUME OF SOIL AROUND THE UPPER PORTION OF THE ROOT BALL, EXTENDING FROM THE SOIL SURFACE TO A DEPTH OF ABOUT 8 INCHES, AND EXTENDING OUT FROM THE ROOT BALL ABOUT 8 INCHES INTO THE BACKFILL. APPLY WATER TO SOIL SATURATION.
- MYCORB® TREE SAVER IS EFFECTIVE FOR ALL TREE AND SHRUB SPECIES EXCEPT RHODODENDRONS, AZALEAS, AND MOUNTAIN LAUREL, WHICH REQUIRE ERICOID MYCORRHIZAE.
- SOIL PH: THE FUNGI IN THIS PRODUCT WERE CHOSEN BASED ON THEIR ABILITY TO SURVIVE AND COLONIZE PLANT ROOTS IN A PH RANGE OF 5 TO 9.
- FUNGICIDES: THE USE OF CERTAIN FUNGICIDES CAN HAVE A DETRIMENTAL EFFECT ON THE INOCULATION PROGRAM. SOIL APPLICATION OF ANY FUNGICIDE IS NOT RECOMMENDED FOR TWO WEEKS AFTER APPLICATION.
- OTHER PESTICIDES: HERBICIDES AND INSECTICIDES DO NOT NORMALLY INTERFERE WITH MYCORRHIZAL FUNGAL DEVELOPMENT, BUT MAY INHIBIT THE GROWTH OF SOME TREE AND SHRUB SPECIES IF NOT USED PROPERLY.

HEALTHY START MACRO TABS 12-8-8

- FERTILIZER TABLETS ARE PLACED IN THE UPPER 4 INCHES OF BACKFILL SOIL WHEN PLANTING TREES AND SHRUBS.
- TABLETS ARE FORMULATED FOR LONG-TERM RELEASE BY LANDSCAPE CONTRACTOR AND LAST UP TO 2 YEARS AFTER PLANTING. TABLETS CONTAIN 12-8-8 NPK FERTILIZER, AS WELL AS A MINIMUM OF SEVEN PERCENT (7%) HUMIC ACID BY WEIGHT, MICROBIAL NUTRIENTS DERIVED FROM SEA KELP, PROTEIN BYPRODUCTS, AND YUCCA SCHIDIGERA, AND A COMPLEMENT OF BENEFICIAL RHIZOSPHERE BACTERIA. THE STANDARD 21 GRAM TABLET IS SPECIFIED HERE. DIRECTIONS FOR USE: FOR PLANTING BALLED & BURLAPPED (B&B) TREES AND SHRUBS, MEASURE THE THICKNESS OF THE TRUNK, AND USE ABOUT 1 TABLET (21-G) PER HALF-INCH. PLACE THE TABLETS DIRECTLY NEXT TO THE ROOT BALL, EVENLY DISTRIBUTED AROUND ITS PERIMETER, AT A DEPTH OF ABOUT 4 INCHES.

PLANT QUALITY AND HANDLING NOTES:

- ALL PLANT MATERIAL SHALL CONFORM TO THE AMERICAN STANDARD FOR NURSERY STOCK (ANSI Z601-2004) OR LATEST REVISION AS PUBLISHED BY THE AMERICAN NURSERY AND LANDSCAPE ASSOCIATION.
- IN ALL CASES, BOTANICAL NAMES LISTED WITHIN THE APPROVED OR FINAL PLANT LIST SHALL TAKE PRECEDENCE OVER COMMON NAMES.
- ALL PLANTS SHALL BE OF SELECTED SPECIMEN QUALITY, EXCEPTIONALLY HEAVY, TIGHTLY KNIT, SO TRAINED OR FAVORED IN THEIR DEVELOPMENT AND APPEARANCE AS TO BE SUPERIOR IN FORM, NUMBER OF BRANCHES, COMPACTNESS AND SYMMETRY. ALL PLANTS SHALL HAVE A NORMAL HABIT OR SOUND, HEALTHY, VIGOROUS PLANTS WITH WELL DEVELOPED ROOT SYSTEM. PLANTS SHALL BE FREE OF DISEASE, INSECT PESTS, EGGS OR LARVAE.
- PLANTS SHALL NOT BE PRUNED BEFORE DELIVERY. TREES WITH ABRASION OF THE BARK, SUNSCALDS, DISFIGURING KNOTS OR FRESH CUTS OF LIMBS OVER ONE AND ONE-FOURTH INCHES (1-1/4") WHICH HAVE NOT COMPLETELY CALLOUSED SHALL BE REJECTED.
- ALL PLANTS SHALL BE TYPICAL OF THEIR SPECIES OR VARIETY AND SHALL HAVE A NORMAL HABIT OF GROWTH AND BE LEGIBLY TAGGED WITH THE PROPER NAME AND SIZE.
- THE ROOT SYSTEM OF EACH PLANT SHALL BE WELL PROVIDED WITH FIBROUS ROOTS. ALL PARTS SHALL BE SOUND, HEALTHY, VIGOROUS, WELL-BRANCHED AND DENSELY FOLIATED WHEN IN LEAF.
- ALL PLANTS DELIVERED Balled and Burlapped (B&B) MUST BE MOVED WITH THE ROOT SYSTEM AS SOLID UNITS WITH BALLS OF FIRM FIRMLY WRAPPED WITH BURLAP. THE DIAMETER AND DEPTH OF THE BALLS OF EARTH MUST BE SUFFICIENT TO ENCOMPASS THE FIBROUS ROOT FEEDING SYSTEMS NECESSARY FOR THE HEALTHY DEVELOPMENT OF THE PLANT. NO PLANT SHALL BE ACCEPTED WHEN THE BALL OF EARTH SURROUNDING ITS ROOTS HAS BEEN BADLY CRACKED OR BROKEN PREPARATORY TO OR DURING THE PROCESS OF PLANTING. THE BALLS SHALL REMAIN INTACT DURING ALL OPERATIONS. ALL PLANTS THAT CANNOT BE PLANTED AT ONCE MUST BE HEeled-IN BY SETTING IN THE GROUND AND COVERING THE BALLS WITH SOIL OR MULCH AND THEN WATERING. HEMP BURLAP AND TWINE IS PREFERABLE TO TREATED. IF TREATED BURLAP IS USED, ALL TWINE IS TO BE CUT FROM AROUND THE TRUNK AND ALL BURLAP IS TO BE REMOVED.
- PLANTS TRANSPORTED TO THE PROJECT IN OPEN VEHICLES SHALL BE COVERED WITH TARP OR OTHER SUITABLE COVERS SECURELY FASTENED TO THE BODY OF THE VEHICLE TO PREVENT INJURY TO THE PLANTS. CLOSED VEHICLES SHALL BE ADEQUATELY VENTILATED TO PREVENT OVERHEATING OF THE PLANTS. EVIDENCE OF INADEQUATE PROTECTION FOLLOWING DIGGING, CARELESSNESS WHILE IN TRANSIT, OR IMPROPER HANDLING OR STORAGE SHALL BE CAUSE FOR REJECTION OF PLANT MATERIAL. ALL PLANTS SHALL BE KEPT MOIST, FRESH, AND PROTECTED. SUCH PROTECTION SHALL ENCOMPASS THE ENTIRE PERIOD DURING WHICH THE PLANTS ARE IN TRANSIT, BEING HANDLED, OR ARE IN TEMPORARY STORAGE.
- ALL PLANT MATERIAL SHALL BE INSTALLED IN ACCORDANCE WITH THE CORRESPONDING LANDSCAPE PLAN AND PLANTING SPECIFICATIONS.
- LANDSCAPE CONTRACTOR SHALL MAKE BEST EFFORT TO INSTALL PLANTINGS ON THE SAME DAY AS DELIVERY. IF PLANTS ARE NOT PLANTED IMMEDIATELY ON SITE, PROPER CARE SHALL BE TAKEN TO PLACE THE PLANTINGS IN PARTIAL SHADE WHEN POSSIBLE. THE ROOT BALL SHALL BE KEPT MOIST AT ALL TIME AND COVERED WITH MOISTENED MULCH OR AGED WOODCHIPS. PROPER IRRIGATION SHALL BE SUPPLIED SO AS TO NOT ALLOW THE ROOT BALL TO DRY OUT. PLANTINGS SHALL BE UNITED AND PROPER SPACING SHALL BE ALLOTTED FOR AIR CIRCULATION AND TO PREVENT DISEASE, WILTING, AND LEAF LOSS. PLANTS THAT REMAIN UNPLANTED FOR A PERIOD OF TIME GREATER THAN THREE (3) DAYS SHALL BE HEaled IN WITH TOPSOIL OR MULCH AND WATERED AS REQUIRED TO PRESERVE ROOT MOISTURE.
- NO PLANT MATERIAL SHALL BE PLANTED IN MUDDY OR FROZEN SOIL.
- PLANTS WITH INJURED ROOTS OR BRANCHES SHALL BE PRUNED PRIOR TO PLANTING UTILIZING CLEAN, SHARP TOOLS. ONLY DISEASED OR INJURED PLANTS SHALL BE REMOVED.
- IF ROCK OR OTHER UNDERGROUND OBSTRUCTION IS ENCOUNTERED, THE LANDSCAPE DESIGNER RESERVES THE RIGHT TO RELOCATE OR ENLARGE PLANTING OR DELETE PLANT FROM THE CONTRACT.
- IF PLANTS ARE PROPOSED WITHIN SIGHT TRIANGLES, TREES SHALL BE LIMBED AND MAINTAINED TO A HEIGHT OF EIGHT FEET (8') ABOVE GRADE, AND SHRUBS, GROUND COVER, PERENNIALS, AND ANNUALS SHALL BE MAINTAINED TO A HEIGHT NOT TO EXCEED TWO FEET (2') ABOVE GRADE UNLESS OTHERWISE NOTED OR SPECIFIED BY THE GOVERNING MUNICIPALITY OR AGENCY.
- INSTALLATION SHALL OCCUR DURING THE FOLLOWING SEASONS:
  - PLANTS (MARCH 15 - DECEMBER 15)
  - LAWNS (MARCH 15 - JUNE 15 OR SEPTEMBER 1 - DECEMBER 1)
- THE FOLLOWING TREES ARE SUSCEPTIBLE TO TRANSPORT SHOCK AND SHALL NOT BE PLANTED DURING THE FALL SEASON (STARTING SEPTEMBER 15):
  - ABIES CONCOLOR
  - ACER BUEKERIANUM
  - ACER FRAXINUS
  - ACER RUBRUM
  - ACER SACCHARINUM
  - BETULA VARIETIES
  - CARPINUS VARIETIES
  - CEDRUS DEODARA
  - CELTIS VARIETIES
  - CERIDOPHYLLUM VARIETIES
  - LIQUIDAMBAR VARIETIES
  - LIRODENDRON VARIETIES
  - MALUS IN LEAF
  - CRATAEGUS VARIETIES
  - NYSSA SYLVATICA
- IF A PROPOSED PLANT IS UNAVAILABLE OR ON THE FALL DIGGING HAZARD LIST, AN EQUIVALENT SPECIES OF THE SAME SIZE MAY BE REQUESTED FOR SUBSTITUTION OF THE ORIGINAL PLANT. ALL SUBSTITUTIONS SHALL BE APPROVED BY THE PROJECT LANDSCAPE DESIGNER OR MUNICIPAL OFFICIAL PRIOR TO ORDERING AND INSTALLATION.
- DURING THE COURSE OF CONSTRUCTION/PLANT INSTALLATION, EXCESS AND WASTE MATERIALS SHALL BE CONTINUOUSLY AND PROMPTLY REMOVED AT THE END OF EACH WORK DAY. ALL DEBRIS, MATERIALS, AND TOOLS SHALL BE PROPERLY STORED, STOCKPILED OR DISPOSED OF AND ALL PAVED AREAS SHALL BE CLEANED.
- THE LANDSCAPE CONTRACTOR SHALL DISPOSE OF ALL RUBBISH AND EXCESS SOIL AT HIS EXPENSE TO AN OFF-SITE LOCATION AS APPROVED BY THE LOCAL MUNICIPALITY.
- 90-DAY MAINTENANCE PERIOD SHALL BEGIN IMMEDIATELY AFTER ALL PLANTS HAVE BEEN SATISFACTORILY INSTALLED.
- MAINTENANCE SHALL INCLUDE, BUT NOT BE LIMITED TO, REPLACING MULCH THAT HAS BEEN DISPLACED BY EROSION OR OTHER MEANS, REPAIRING AND RESHAPING WATER RINGS OR SAUCERS, MAINTAINING STAKES AND GUYS IF ORIGINALLY REQUIRED, WATERING WHEN NEEDED OR DIRECTED, WEEDING, PRUNING, SPRAYING, MOWING THE LAWN, AND PERFORMING ANY OTHER WORK REQUIRED TO KEEP THE PLANTS IN A HEALTHY CONDITION.
- MOW ALL GRASS AREAS AT REGULAR INTERVALS TO KEEP THE GRASS HEIGHT FROM EXCEEDING THREE INCHES (3"). MOWING SHALL BE PERFORMED ONLY WHEN GRASS IS DRY. MOWER BLADE SHALL BE SET TO REMOVE NO MORE THAN ONE THIRD (1/3) OF THE GRASS LENGTH. WHEN THE AMOUNT OF GRASS IS HEAVY, IT SHALL BE REMOVED TO PREVENT DESTRUCTION OF THE UNDERLYING TURF. MOW GRASS AREAS IN SUCH A MANNER AS TO PREVENT CLIPPINGS FROM BLOWING ON PAVED AREAS, AND SIDEWALKS. CLEANUP AFTER MOWING SHALL INCLUDE SWEEPING OR BLOWING OF PAVED AREAS AND SIDEWALKS TO CLEAR THEM FROM MOWING DEBRIS.
- GRASSED AREAS DAMAGED DURING THE PROCESS OF THE WORK SHALL BE THE RESPONSIBILITY OF THE CONTRACTOR, WHO SHALL RESTORE THE DISTURBED AREAS TO A CONDITION SATISFACTORY TO THE PROJECT LANDSCAPE DESIGNER, MUNICIPAL OFFICIAL, OR OWNER/OWNER'S REPRESENTATIVE. THIS MAY INCLUDE FILLING TO GRADE, FERTILIZING, SEEDING, AND MULCHING.
- SHOULD THE OWNER REQUIRE MAINTENANCE BEYOND THE STANDARD 90-DAY MAINTENANCE PERIOD, A SEPARATE CONTRACT SHALL BE ESTABLISHED.
- LANDSCAPE CONTRACTOR SHALL WATER NEW PLANTINGS FROM TIME OF INSTALL AND THROUGHOUT REQUIRED 90-DAY MAINTENANCE PERIOD UNTIL PLANTS ARE ESTABLISHED. IF ON-SITE WATER IS NOT AVAILABLE AT THE PROJECT LOCATION, THE LANDSCAPE CONTRACTOR SHALL FURNISH IT BY MEANS OR A WATERING TRUCK OR OTHER ACCEPTABLE MANNER.
- THE QUANTITY OF WATER APPLIED AT ONE TIME SHALL BE SUFFICIENT TO PENETRATE THE SOIL TO A MINIMUM OF EIGHT INCHES (8") IN SHRUB BEDS AND SIX INCHES (6") IN TURF AREAS AT A RATE WHICH WILL PREVENT SATURATION OF THE SOIL.
- IF AN AUTOMATIC IRRIGATION SYSTEM HAS BEEN INSTALLED, IT CAN BE USED FOR WATERING PLANT MATERIAL. HOWEVER, FAILURE OF THE SYSTEM DOES NOT ELIMINATE THE LANDSCAPE CONTRACTOR'S RESPONSIBILITY OF PLANT HEALTH AND ESTABLISHMENT.

ABIES CONCOLOR	CORNUS VARIETIES	OSTRYA VIRGINIANA
ACER BUEKERIANUM	CRATAEGUS VARIETIES	PINUS NIGRA
ACER FRAXINUS	CUPRESSUS VARIETIES	PLATANUS VARIETIES
ACER RUBRUM	FAGUS VARIETIES	PORULUS VARIETIES
ACER SACCHARINUM	HALESIA VARIETIES	PRUNUS VARIETIES
BETULA VARIETIES	ILEX X FOSTERII	PRUNUS VARIETIES
CARPINUS VARIETIES	ILEX NELLE STEVENS	QUERCUS VARIETIES (NOT Q. PALUSTRIS)
CEDRUS DEODARA	ILEX OPACA	SALIX WEEPING VARIETIES
CELTIS VARIETIES	JUNIPERUS VIRGINIANA	SORBUS VARIETIES
CERIDOPHYLLUM VARIETIES	KOELERUTERA PANICULATA	TAXODIUM VARIETIES
LIQUIDAMBAR VARIETIES	LIQUIDAMBAR VARIETIES	TAXUS VARIETIES
LIRODENDRON VARIETIES	MALUS IN LEAF	TILIA TOMENTOSA VARIETIES
MALUS IN LEAF	NYSSA SYLVATICA	ULMUS PARVIFOLIA VARIETIES
CRATAEGUS VARIETIES		ZELKOVA VARIETIES

- THE LANDSCAPE CONTRACTOR SHALL GUARANTEE ALL PLANT MATERIAL FOR A PERIOD OF ONE YEAR (1 YR) FROM APPROVAL OF LANDSCAPE INSTALLATION BY THE PROJECT LANDSCAPE DESIGNER, MUNICIPAL OFFICIAL, OR OWNER/OWNER'S REPRESENTATIVE.
- THE LANDSCAPE CONTRACTOR SHALL REMOVE AND REPLACE DYING, DEAD, OR DEFECTIVE PLANT MATERIAL AT HIS EXPENSE. THE LANDSCAPE CONTRACTOR SHALL ALSO BE RESPONSIBLE FOR ANY DAMAGES CAUSED BY HIS COMPANY'S OPERATIONS.
- ALL REPLACEMENT PLANTS SHALL BE OF THE SAME SPECIES AND SIZE AS SPECIFIED ON THE APPROVED OR FINAL PLANT LIST. REPLACEMENTS RESULTING FROM REMOVAL, LOSS, OR DAMAGE DUE TO OCCUPANCY OF THE PROJECT IN ANY PART: VANDALISM, PHYSICAL DAMAGE BY ANIMALS, VEHICLES, ETC., AND LOSSES DUE TO CURTALMENT OF WATER BY LOCAL AUTHORITIES SHALL BE APPROVED AND PAID FOR BY THE OWNER.
- THE CONTRACTOR SHALL INSTRUCT THE OWNER AS TO THE PROPER CARE AND MAINTENANCE OF ALL PLANTINGS.

PLANT MATERIAL GUARANTEE NOTES:

- THE LANDSCAPE CONTRACTOR SHALL GUARANTEE ALL PLANT MATERIAL FOR A PERIOD OF ONE YEAR (1 YR) FROM APPROVAL OF LANDSCAPE INSTALLATION BY THE PROJECT LANDSCAPE DESIGNER, MUNICIPAL OFFICIAL, OR OWNER/OWNER'S REPRESENTATIVE.
- THE LANDSCAPE CONTRACTOR SHALL REMOVE AND REPLACE DYING, DEAD, OR DEFECTIVE PLANT MATERIAL AT HIS EXPENSE. THE LANDSCAPE CONTRACTOR SHALL ALSO BE RESPONSIBLE FOR ANY DAMAGES CAUSED BY HIS COMPANY'S OPERATIONS.
- ALL REPLACEMENT PLANTS SHALL BE OF THE SAME SPECIES AND SIZE AS SPECIFIED ON THE APPROVED OR FINAL PLANT LIST. REPLACEMENTS RESULTING FROM REMOVAL, LOSS, OR DAMAGE DUE TO OCCUPANCY OF THE PROJECT IN ANY PART: VANDALISM, PHYSICAL DAMAGE BY ANIMALS, VEHICLES, ETC., AND LOSSES DUE TO CURTALMENT OF WATER BY LOCAL AUTHORITIES SHALL BE APPROVED AND PAID FOR BY THE OWNER.
- THE CONTRACTOR SHALL INSTRUCT THE OWNER AS TO THE PROPER CARE AND MAINTENANCE OF ALL PLANTINGS.

LAWN (SEED OR SOD) NOTES:

- SEED MIXTURE SHALL BE FRESH, CLEAN, NEW CROP SEED. SOD SHALL BE STRONGLY ROOTED, UNIFORM IN THICKNESS, AND FREE OF WEEDS, DISEASE, AND PESTS.
- SEED OR SOD SHALL BE PURCHASED FROM A RECOGNIZED DISTRIBUTOR AND SHALL BE COMPOSED OF THE MIX OR BLEND WITHIN THE SPECIFIED TOLERANCES OF THE "SEED SPECIFICATION" OR "SOD SPECIFICATION".
- REFERENCE LANDSCAPE PLAN FOR AREAS TO BE SEED OR LAID WITH SOD.
- SEEDING SHALL NOT BE PERFORMED IN WINDY WEATHER. IF THE SEASON OF THE PROJECT COMPLETION PROHIBITS PERMANENT STABILIZATION, TEMPORARY STABILIZATION SHALL BE PROVIDED IN ACCORDANCE WITH THE "TEMPORARY SEEDING SPECIFICATION".
- PROTECT NEW LAWN AREAS AGAINST TRESPASSING WHILE THE SEED IS GERMINATING. FURNISH AND INSTALL FENCES, SIGNS, BARRIERS OR ANY OTHER NECESSARY TEMPORARY PROTECTIVE DEVICES. DAMAGE RESULTING FROM TRESPASS, EROSION, WASHOUT, SETTLEMENT OR OTHER CAUSES SHALL BE REPAIRED BY THE LANDSCAPE CONTRACTOR AT HIS EXPENSE. REMOVE ALL FENCES, SIGNS, BARRIERS OR OTHER TEMPORARY PROTECTIVE DEVICES ONCE LAWN HAS BEEN ESTABLISHED.

REVISED PER BOARD COMMENTS	ISSUED FOR REVIEW	ISSUED FOR REVIEW	DATE	BY	DESCRIPTION
	JT	CHG	09/28/2021		
	CHG	CHG	09/03/2021		
			07/01/2021		
			01		
			ISSUE		

NOT APPROVED FOR CONSTRUCTION



Rutherford, NJ • New York, NY • Boston, MA  
Princeton, NJ • Tampa, FL • Detroit, MI

www.stonefielddesign.com

1 Beacon Street, 15 Floor, Boston, MA 02108

Phone 617.203.2076

ALRIG USA DEVELOPMENT, LLC

PROPOSED STARBUCKS WITH DRIVE-THRU FACILITIES



BOOK 10890, PG. 21 E / BOOK 4320, PG. 247 / BOOK 8163, PG. 289  
MAP 92, LOTS 275, 168, & 149  
0 & 8 MITCHELL STREET & 157 COGGESHALL STREET  
CITY OF NEW BEDFORD  
BRISTOL COUNTY, MASSACHUSETTS

SITE PLAN SET

JAKE MODESTOW, P.E.  
MASSACHUSETTS LICENSE No. 6201065336  
LICENSED PROFESSIONAL ENGINEER



SCALE: AS SHOWN PROJECT ID: BOS-200026

TITLE:

LANDSCAPING DETAILS

DRAWING:

C-9



SEQUENCE OF CONSTRUCTION

1. INSTALL CONSTRUCTION ENTRANCE AND SILT FENCE (2 DAYS).
2. DEMOLISH EXISTING STRUCTURES, PAVEMENT, AND GRAVEL (7 DAYS).
3. ROUGH GRADING AND TEMPORARY SEEDING (21 DAYS).
4. BUILDING CONSTRUCTION AND SITE IMPROVEMENTS (120 DAYS).
5. LANDSCAPING IMPROVEMENTS AND FINAL SEEDING (7 DAYS).
6. REMOVE SOIL EROSION MEASURES (1 DAY).

TOTAL ESTIMATED TIME = 8 MONTHS

NOTE: TIME DURATIONS ARE APPROXIMATE AND ARE INTENDED TO ACT AS A GENERAL GUIDE TO THE CONSTRUCTION TIMELINE. ALL DURATIONS ARE SUBJECT TO CHANGE BY CONTRACTOR. CONTRACTOR SHALL SUBMIT CONSTRUCTION SCHEDULE TO TOWNSHIP AND ENGINEER. CONTRACTOR SHALL PHASE CONSTRUCTION ACCORDINGLY.

STABILIZATION SPECIFICATIONS:

- I.A. TEMPORARY SEEDING AND MULCHING:  
GROUND LIMESTONE - APPLIED UNIFORMLY ACCORDING TO SOIL TEST RECOMMENDATIONS.  
FERTILIZER - APPLY 11 LBS/1,000 SF OF 10-20-10 OR EQUIVALENT WITH 50% WATER INSOLUBLE NITROGEN (UNLESS A SOIL TEST INDICATES OTHERWISE) WORKED INTO THE SOIL A MINIMUM OF 4".  
SEED - PERENNIAL RYEGRASS 100 LBS/ACRE (2.3 LBS/1,000 SF) OR OTHER APPROVED SEEDS; PLANT BETWEEN MARCH 1 AND MAY 15 OR BETWEEN AUGUST 15 AND OCTOBER 1.  
MULCH - UNROTTED STRAW OR HAY AT A RATE OF 70 TO 90 LBS/1,000 SF APPLIED TO ACHIEVE 95% SOIL SURFACE COVERAGE. MULCH SHALL BE ANCHORED BY APPROVED METHODS (I.E. PEG AND TWINE, MULCH NETTING, OR LIQUID MULCH BINDER).
- I.B. PERMANENT SEEDING AND MULCHING:  
TOPSOIL - UNIFORM APPLICATION TO A DEPTH OF 5" (UNSETTLED).  
GROUND LIMESTONE - APPLIED UNIFORMLY ACCORDING TO SOIL TEST RECOMMENDATIONS.  
FERTILIZER - APPLY 11 LBS/1,000 SF OF 10-10-10 OR EQUIVALENT WITH 50% WATER INSOLUBLE NITROGEN (UNLESS A SOIL TEST INDICATES OTHERWISE) WORKED INTO THE SOIL A MINIMUM OF 4".  
SEED - TURF TYPE TALL FESCUE (BLEND OF 3 CULTIVARS) 350 LBS/ACRE (8 LBS/1,000 SF) OR OTHER APPROVED SEEDS; PLANT BETWEEN MARCH 1 AND OCTOBER 1 (SUMMER SEEDINGS REQUIRE IRRIGATION).  
MULCH - UNROTTED STRAW OR HAY AT A RATE OF 70 TO 90 LBS/1,000 SF APPLIED TO ACHIEVE 95% SOIL SURFACE COVERAGE. MULCH SHALL BE ANCHORED BY APPROVED METHODS (I.E. PEG AND TWINE, MULCH NETTING, OR LIQUID MULCH BINDER).

DUST CONTROL NOTES

1. MULCHES - SEE STANDARD OF STABILIZATION WITH MULCHES ONLY, PG. 5-1
2. VEGETATIVE COVER - SEE STANDARD FOR: TEMPORARY VEGETATIVE COVER, PG. 7-1; PERMANENT VEGETATIVE COVER FOR SOIL STABILIZATION PG. 4-1 AND PERMANENT STABILIZATION WITH SOD, PG. 6-1
3. SPRAY-ON ADHESIVES - ON MINERAL SOILS (NOT EFFECTIVE ON MUCK SOILS). KEEP TRAFFIC OFF THESE AREAS.
4. TILLAGE - TO ROUGHEN SURFACE AND BRING CLODS TO THE SURFACE. THIS IS A TEMPORARY EMERGENCY MEASURE WHICH SHOULD BE USED BEFORE SOIL BLOWING STARTS. BEGIN PLOWING ON WINDWARD SIDE OF SITE. CHISEL-TYPE PLOWS SPACED ABOUT 12 INCHES APART AND SPRING-TOOTHED HARROWS ARE EXAMPLES OF EQUIPMENT WHICH MAY PRODUCE THE DESIRED EFFECT.
5. SPRINKLING - SITE IS SPRINKLED UNTIL THE SURFACE IS WET.
6. BARRIERS - SOLID BOARD FENCES, SNOW FENCES, BURLAP FENCES, CRATE WALLS, BALES OF HAY AND SIMILAR MATERIAL CAN BE USED TO CONTROL AIR CURRENTS AND SOIL BLOWING.
7. CALCIUM CHLORIDE - SHALL BE IN THE FORM OF LOOSE, DRY GRANULES OR FLAKES FINE ENOUGH TO FEED THROUGH COMMONLY USED SPREADERS AT A RATE THAT WILL KEEP SURFACE MOIST BUT NOT CAUSE POLLUTION OR PLANT DAMAGE. IF USED ON STEEPER SLOPES, THEN USE OTHER PRACTICES TO PREVENT WASHING INTO STREAMS OR ACCUMULATION AROUND PLANTS.
8. STONE - COVER SURFACE WITH CRUSHED STONE OR COARSE GRAVEL.

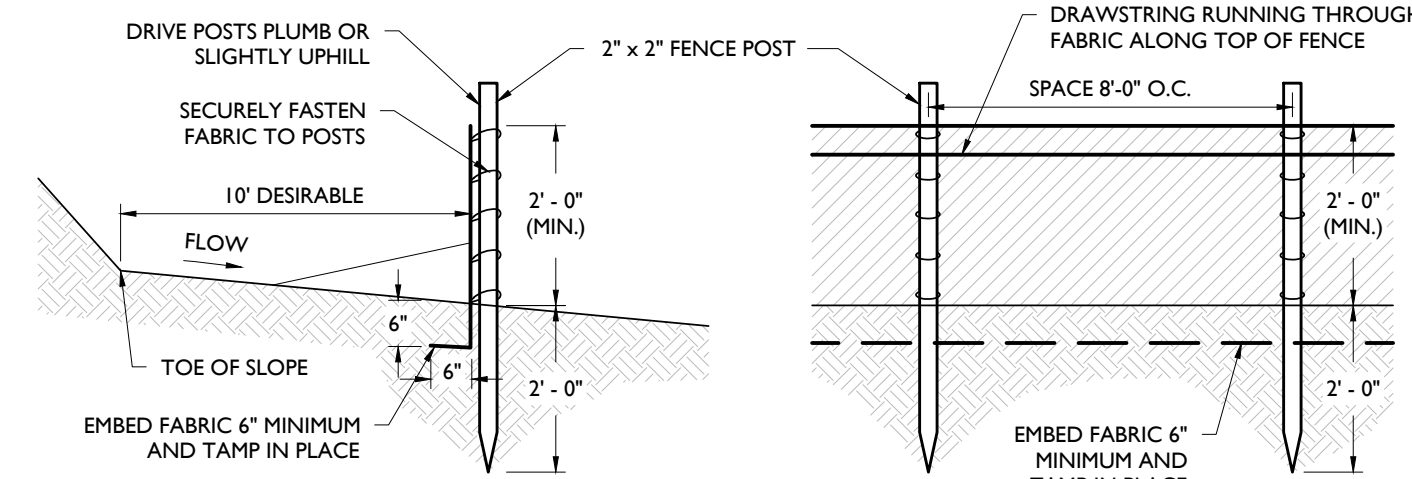

- NOTES:
1. SECURELY FASTEN GEOTEXTILE TO FENCE POST BY USE OF WIRE TIES, HOG RINGS, STAPLES OR POCKETS. FOUR TO SIX FASTENERS PER POST.
  2. GEOTEXTILE FABRIC TO BE EMBEDDED 6" (MIN) AND TAMP IN PLACE.
  3. SECURELY FASTEN ENDS OF INDIVIDUAL ROLLS OF GEOTEXTILE TO A POST BY WRAPPING EACH END OF THE GEOTEXTILE AROUND THE POST TWICE AND ATTACHING AS SPECIFIED IN NOTE 1 ABOVE. SPLICING OF INDIVIDUAL ROLLS SHALL NOT OCCUR AT LOW POINTS.
  4. SET SILT FENCE WITHIN PROJECT LIMITS. 10'-0" IS DESIRABLE.

SILT FENCE DETAIL

NOT TO SCALE

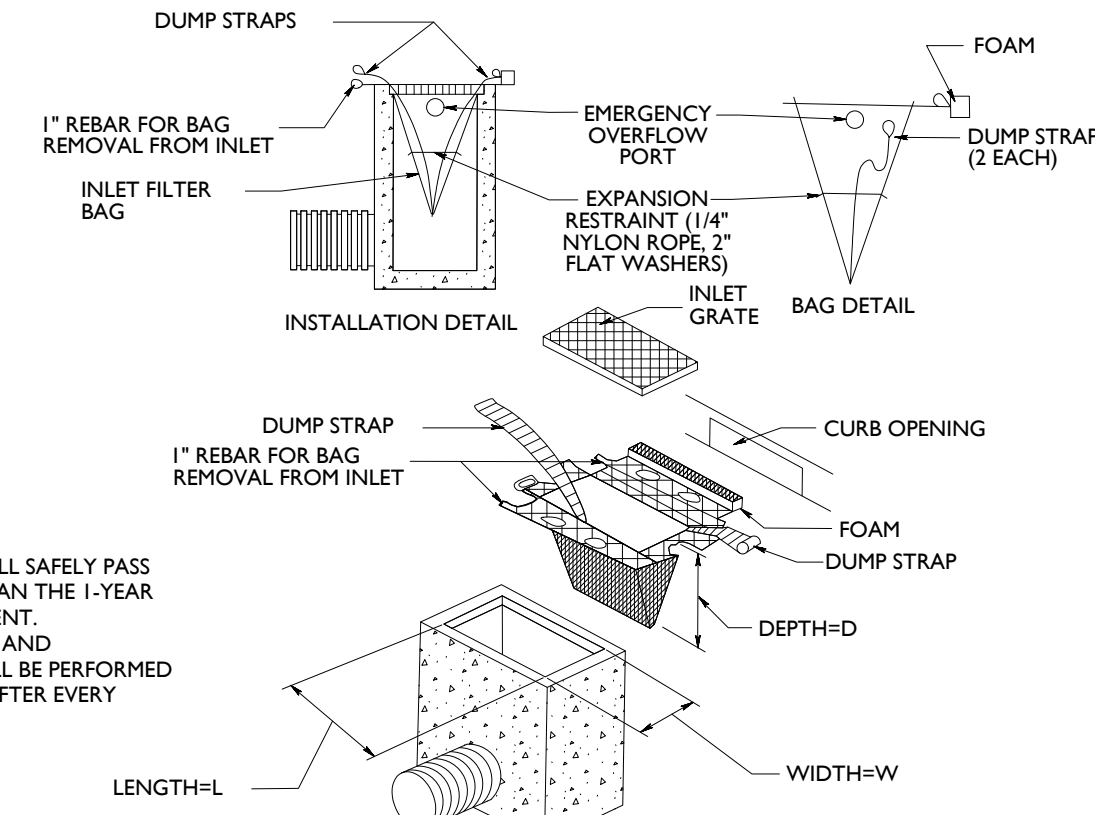

- NOTES:
1. THE FILTER BAG SHALL SAFELY PASS FLOWS GREATER THAN THE 1-YEAR 24-HOUR STORM EVENT.
  2. SEDIMENT REMOVAL AND MAINTENANCE SHALL BE PERFORMED FREQUENTLY AND AFTER EVERY STORM EVENT.

INLET FILTER BAG DETAIL

NOT TO SCALE

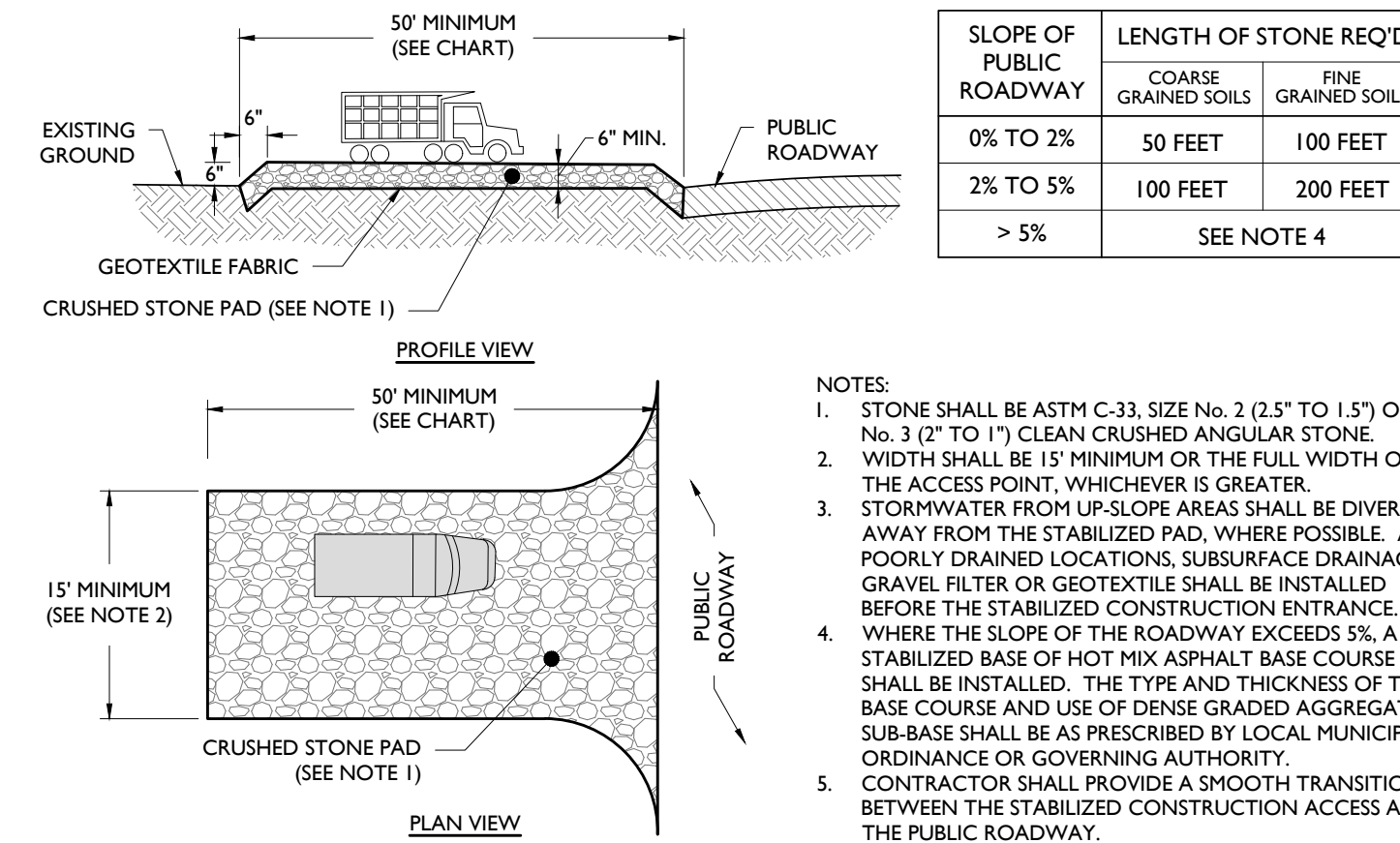

- NOTES:
1. STONE SHALL BE ASTM C-33, SIZE No. 2 (2.5" TO 1.5") OR No. 3 (2" TO 1") CLEAN CRUSHED ANGULAR STONE.
  2. WIDTH SHALL BE 15' MINIMUM OR THE FULL WIDTH OF THE ACCESS POINT, WHICHEVER IS GREATER.
  3. STORMWATER FROM UP-SLOPE AREAS SHALL BE DIVERTED AWAY FROM THE STABILIZED PAD, WHERE POSSIBLE. AT POORLY DRAINED LOCATIONS, SUBSURFACE DRAINAGE GRAVEL FILTER OR GEOTEXTILE SHALL BE INSTALLED BEFORE THE STABILIZED CONSTRUCTION ENTRANCE.
  4. WHERE THE SLOPE OF THE ROADWAY EXCEEDS 5%, A STABILIZED BASE OF HOT MIX ASPHALT BASE COURSE SHALL BE INSTALLED. THE TYPE AND THICKNESS OF THE BASE COURSE AND USE OF DENSE GRADED AGGREGATE SUB-BASE SHALL BE AS PRESCRIBED BY LOCAL MUNICIPAL ORDINANCE OR GOVERNING AUTHORITY.
  5. CONTRACTOR SHALL PROVIDE A SMOOTH TRANSITION BETWEEN THE STABILIZED CONSTRUCTION ACCESS AND THE PUBLIC ROADWAY.

STABILIZED CONSTRUCTION ACCESS DETAIL

NOT TO SCALE

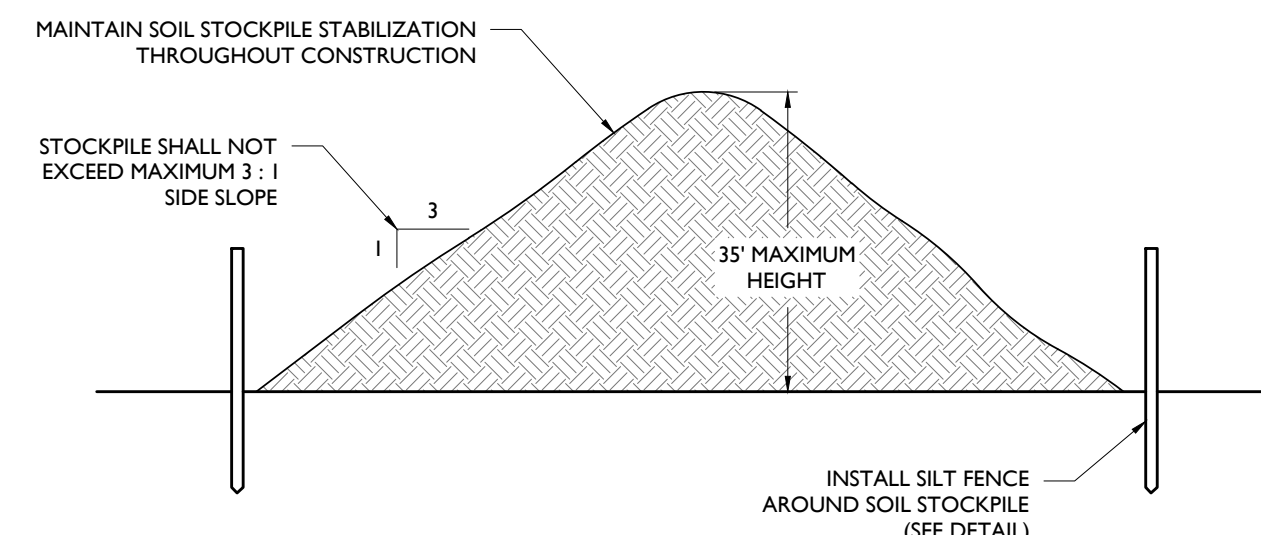

- NOTES:
1. SNOW FENCING IS TO BE 4'-0" HIGH AND SELF SUPPORTED.
  2. DO NOT STOCKPILE MATERIALS OR STORE EQUIPMENT WITHIN THE TREE PROTECTION FENCING.
  3. SNOW FENCE TO BE INSTALLED AT DRIP LINE OF EXISTING TREE OR TREE CLUSTER TO BE PROTECTED OR NO CLOSER THAN 6' FROM TREE TRUNK IF NECESSARY.
  4. IF THE PROJECT AREA ENCOMPASSES A PORTION OF THE DRIP LINE OF THE TREE, NO MORE THAN ONE THIRD OF THE TOTAL AREA OF WITHIN THE DRIP LINE SHOULD BE DISTURBED BY CONSTRUCTION OR REGRADING AND A 3" THICK LAYER OF MULCH SHALL BE INSTALLED OVER THE AREA OF THE DRIP LINE WHICH IS NOT PROTECTED BY FENCING TO PROVIDE A CUSHION.

TREE PROTECTION DETAIL

NOT TO SCALE

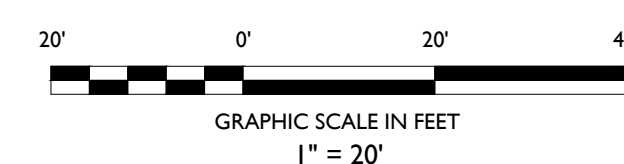

SOIL STOCKPILE DETAIL

NOT TO SCALE

- NOTES:
1. STOCKPILES SHALL BE SITUATED SO AS NOT TO OBSTRUCT NATURAL DRAINAGE OR CAUSE OFF-SITE ENVIRONMENTAL DAMAGE.
  2. STOCKPILES SHALL BE STABILIZED IN ACCORDANCE WITH THE STANDARDS FOR PERMANENT OR TEMPORARY VEGETATIVE COVER FOR SOIL STABILIZATION, AS APPROPRIATE (SEE SOIL EROSION NOTES).

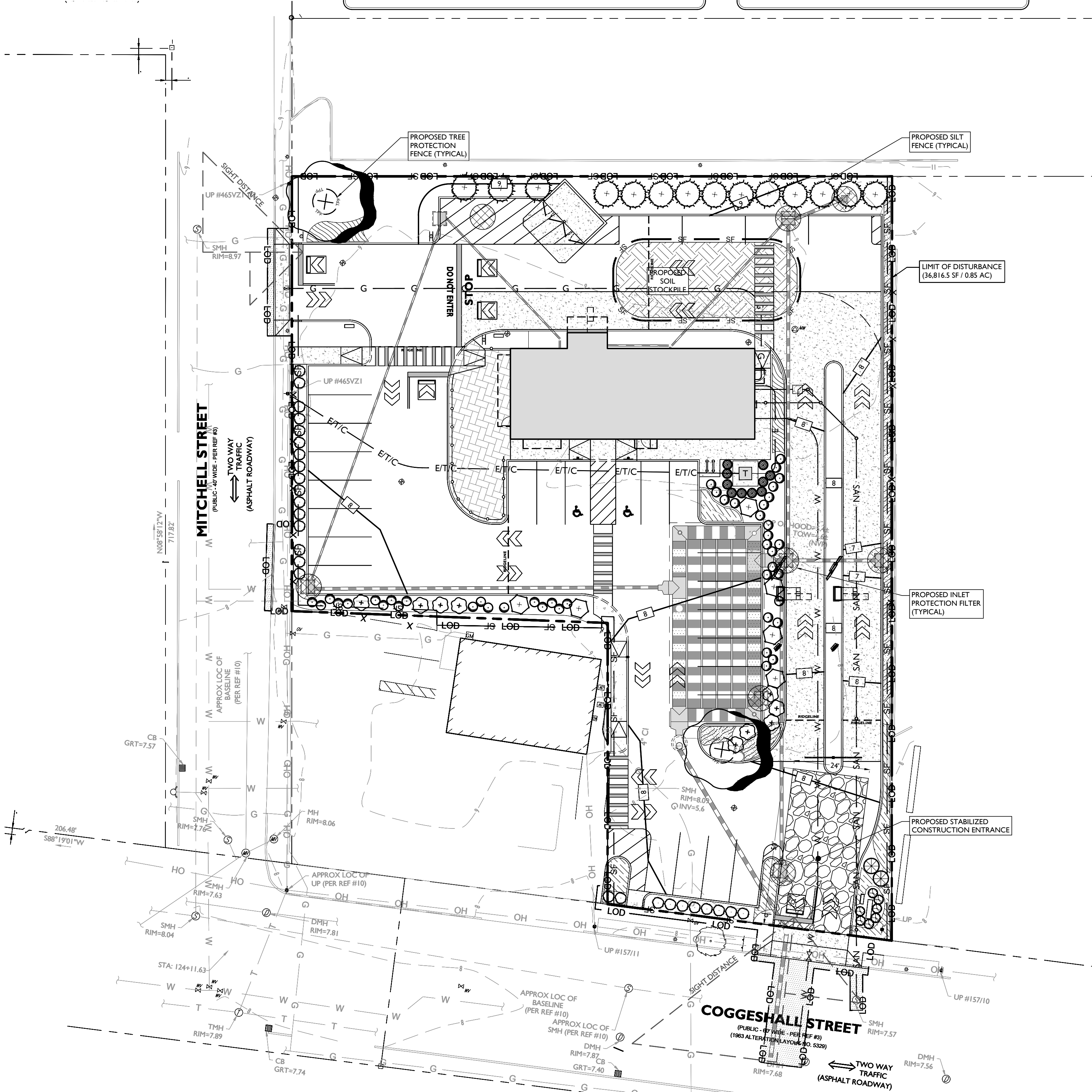

SYMBOL	DESCRIPTION
---	PROPERTY BOUNDARY
---	ADJACENT PROPERTY BOUNDARY
---	LOD
---	PROPOSED LIMIT OF DISTURBANCE
---	SF
---	PROPOSED SILT FENCE
---	TPF
---	PROPOSED TREE PROTECTION FENCE
---	PROPOSED STOCKPILE & EQUIPMENT STORAGE
---	PROPOSED STABILIZED CONSTRUCTION ENTRANCE
---	PROPOSED INLET PROTECTION FILTER

SOIL EROSION AND SEDIMENT CONTROL NOTES

1. THE CONTRACTOR IS RESPONSIBLE FOR SOIL EROSION AND SEDIMENT CONTROL IN ACCORDANCE WITH LOCAL, STATE, AND FEDERAL REQUIREMENTS.
2. THE CONTRACTOR IS RESPONSIBLE FOR DUST CONTROL IN COMPLIANCE WITH LOCAL, STATE, AND FEDERAL AIR QUALITY STANDARDS.
3. THE CONTRACTOR IS RESPONSIBLE TO INSPECT ALL SOIL EROSION AND SEDIMENT CONTROL MEASURES WEEKLY AND AFTER A PRECIPITATION EVENT GREATER THAN 1 INCH. THE CONTRACTOR SHALL MAINTAIN AN INSPECTION LOG ON SITE AND DOCUMENT CORRECTIVE ACTION TAKEN THROUGHOUT THE COURSE OF CONSTRUCTION AS REQUIRED.

SOIL CHARACTERISTICS CHART

TYPE OF SOIL	URBAN LAND (602)
PERCENT OF SITE COVERAGE	100%
HYDROLOGIC SOIL GROUP	N/A
DEPTH TO RESTRICTIVE LAYER	N/A
SOIL PERMEABILITY	N/A
DEPTH TO WATER TABLE	N/A

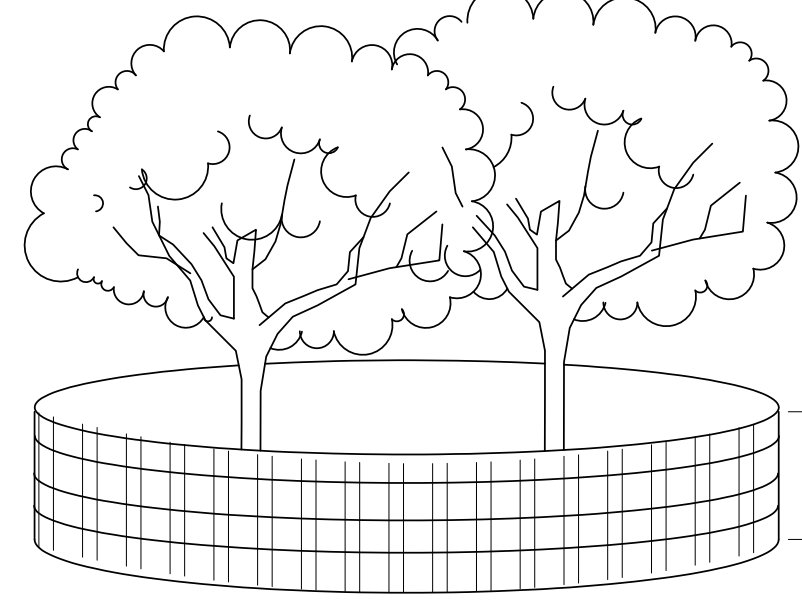

REVISED PER BOARD COMMENTS

ISSUED FOR REVIEW

ISSUED FOR REVIEW

DATE

BY

DATE

BY

03

02

01

09/28/2021

09/03/2021

07/01/2021

JT

CHG

CHG

NOT APPROVED FOR CONSTRUCTION

STONEFIELD

engineering & design

Rutherford, NJ · New York, NY · Boston, MA

Princeton, NJ · Tampa, FL · Detroit, MI

www.stonefieldeng.com

1 Beacon Street, 15 Floor, Boston, MA 02108

Phone 617.203.2076

SITE PLAN SET

ALRIG USA DEVELOPMENT, LLC

PROPOSED STARBUCKS WITH DRIVE-THRU FACILITIES

BOOK 10890, PG. 21 E / BOOK 4320, PG. 247 / BOOK 8163, PG. 289

MAP 92, LOTS 275, 168, & 149

0 & 8 MITCHELL STREET & 157 COGGESHALL STREET

CITY OF NEW BEDFORD

BRISTOL COUNTY, MASSACHUSETTS

JAKE MODESTOW, P.E.

MASSACHUSETTS LICENSE No. 6201065336

LICENSED PROFESSIONAL ENGINEER

STONEFIELD

engineering & design

SCALE: 1" = 20'

PROJECT ID: BOS-200026

TITLE:

SOIL EROSION & SEDIMENT CONTROL PLAN

DRAWING:

C-10





## C-11















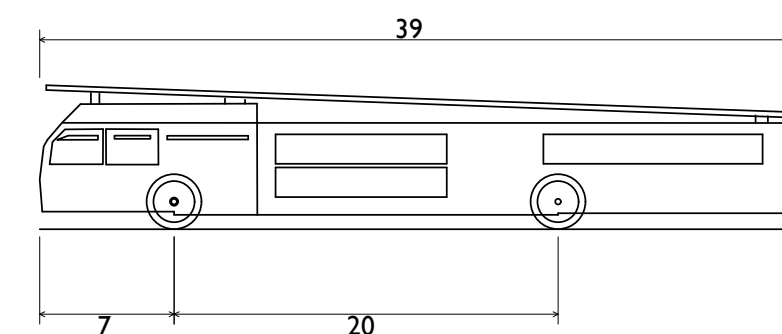
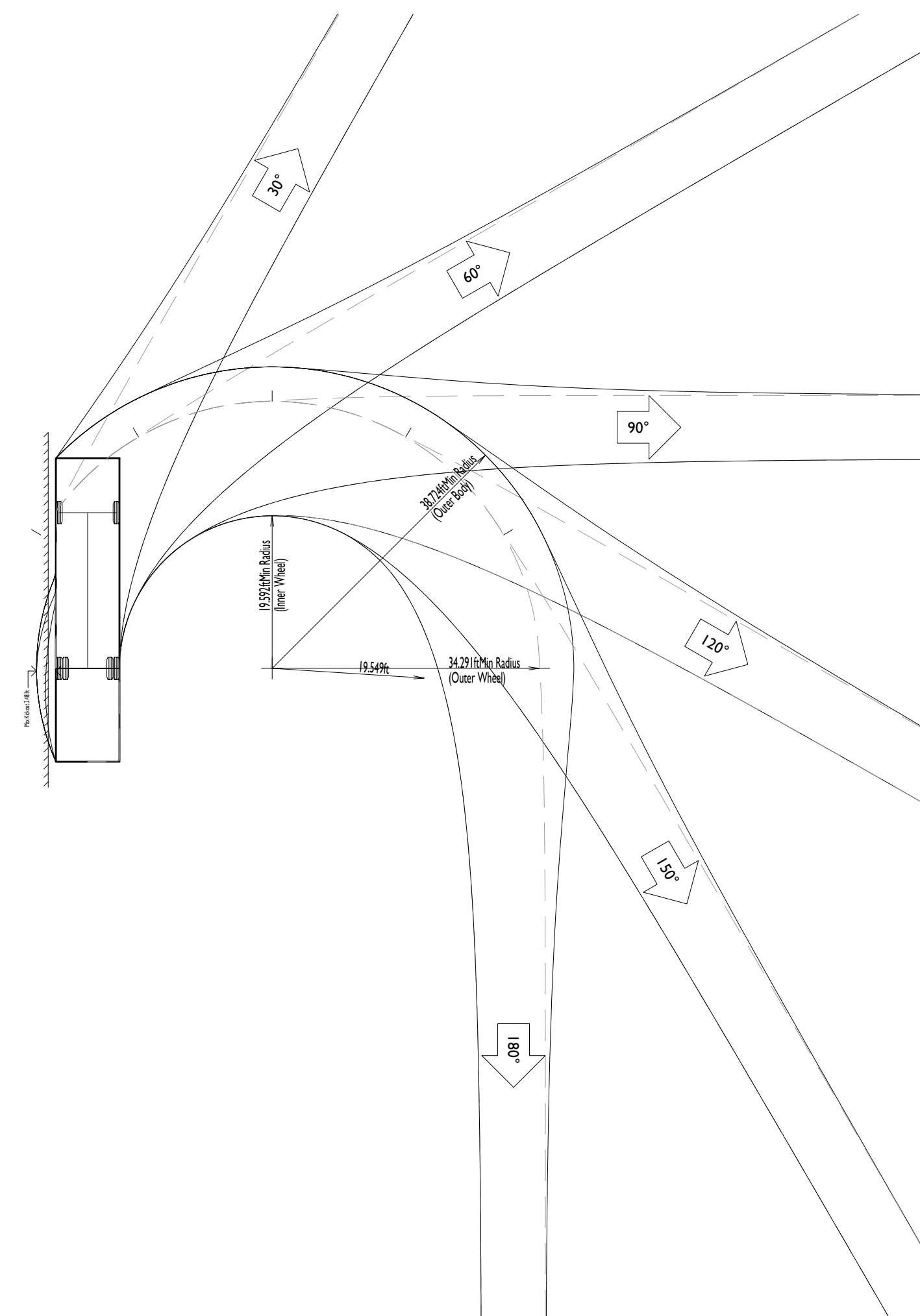

Aerial Fire Truck  
Overall Length  
Overall Width  
Overall Body Height  
Min Body Ground Clearance  
Track Width  
Lock-to-lock time  
Max Wheel Angle

39.000ft  
8.167ft  
7.500ft  
0.750ft  
8.167ft  
5.00s  
45.00°

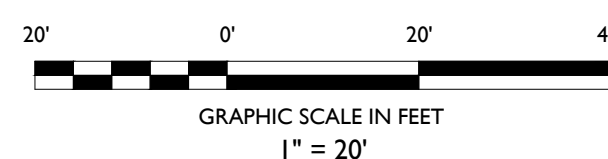
[illegible]

**NOT APPROVED FOR CONSTRUCTION**



Rutherford, NJ • New York, NY • Boston, MA  
Princeton, NJ • Tampa, FL • Detroit, MI

www.stonefieldeng.com

15 Beacon Street, 15 Floor, Boston, MA 02108

Phone 617.203.2076

## SITE PLAN SET

**ALRIG USA DEVELOPMENT, LLC**

## PROPOSED STARBUCKS WITH DRIVE-THRU FACILITIES



BOOK 10890, PG. 215 / BOOK 4320, PG. 247 / BOOK 8163, PG. 289  
MAP 93, LOTS 275, 168, & 169  
0 & 8 MITCHELL STREET & 157 COGGESHALL STREET  
CITY OF NEW BEDFORD  
BRISTOL COUNTY MASSACHUSETTS

**JAKE MODESTOW, P.E.**  
MASSACHUSETTS LICENSE No. 6201065336  
LICENSED PROFESSIONAL ENGINEER



SCALE:	1" = 20'	PROJECT ID: BOS-200024
--------	----------	------------------------

**TITLE:**

### TRUCK TURN PLAN

**DRAWING:**

## C-15



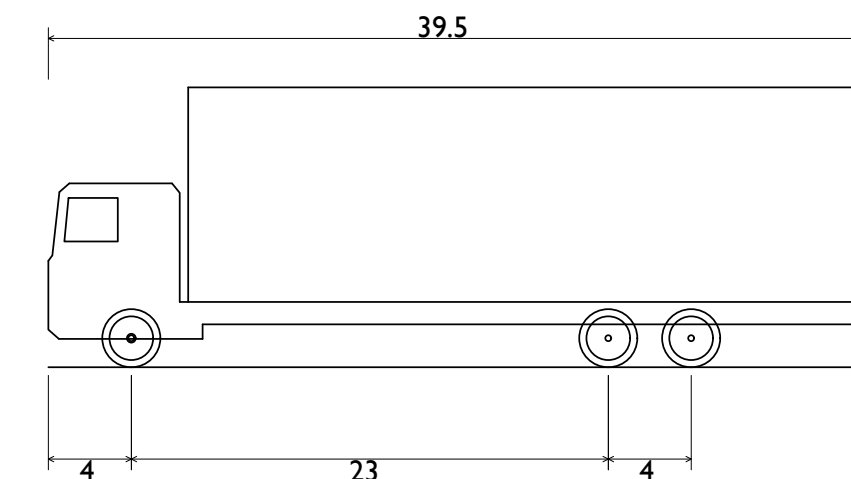
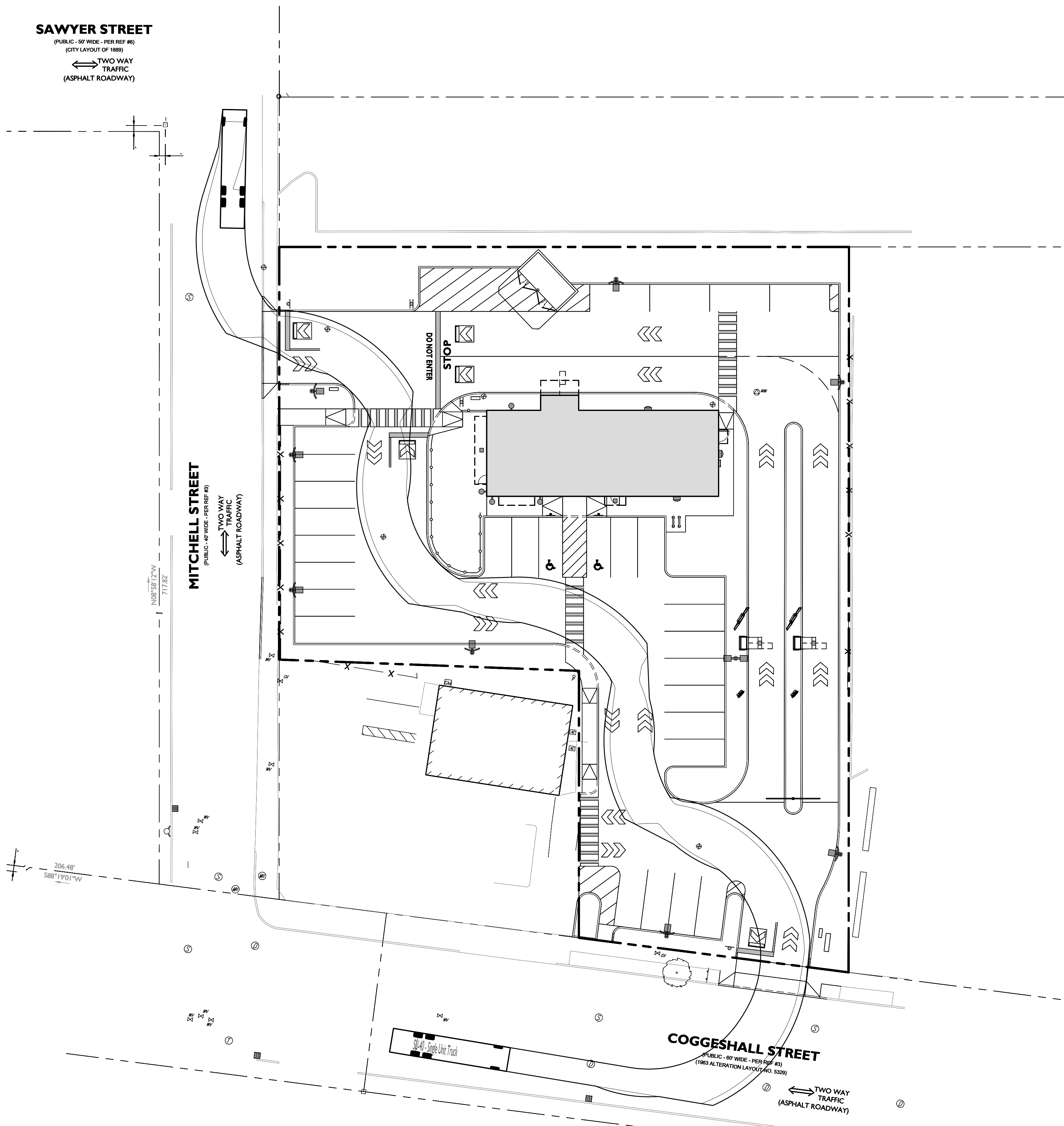

SU-40 - Single Unit Truck	
Overall Length	39.500ft
Overall Width	8.000ft
Overall Body Height	13.500ft
Min Body Ground Clearance	1.367ft
Track Width	8.000ft
Lock-to-lock time	5.00s
Max Steering Angle (Virtual)	31.80°

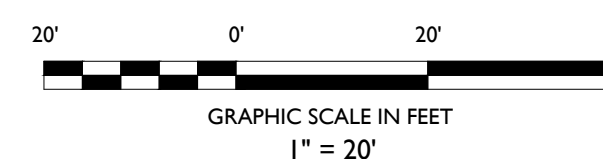
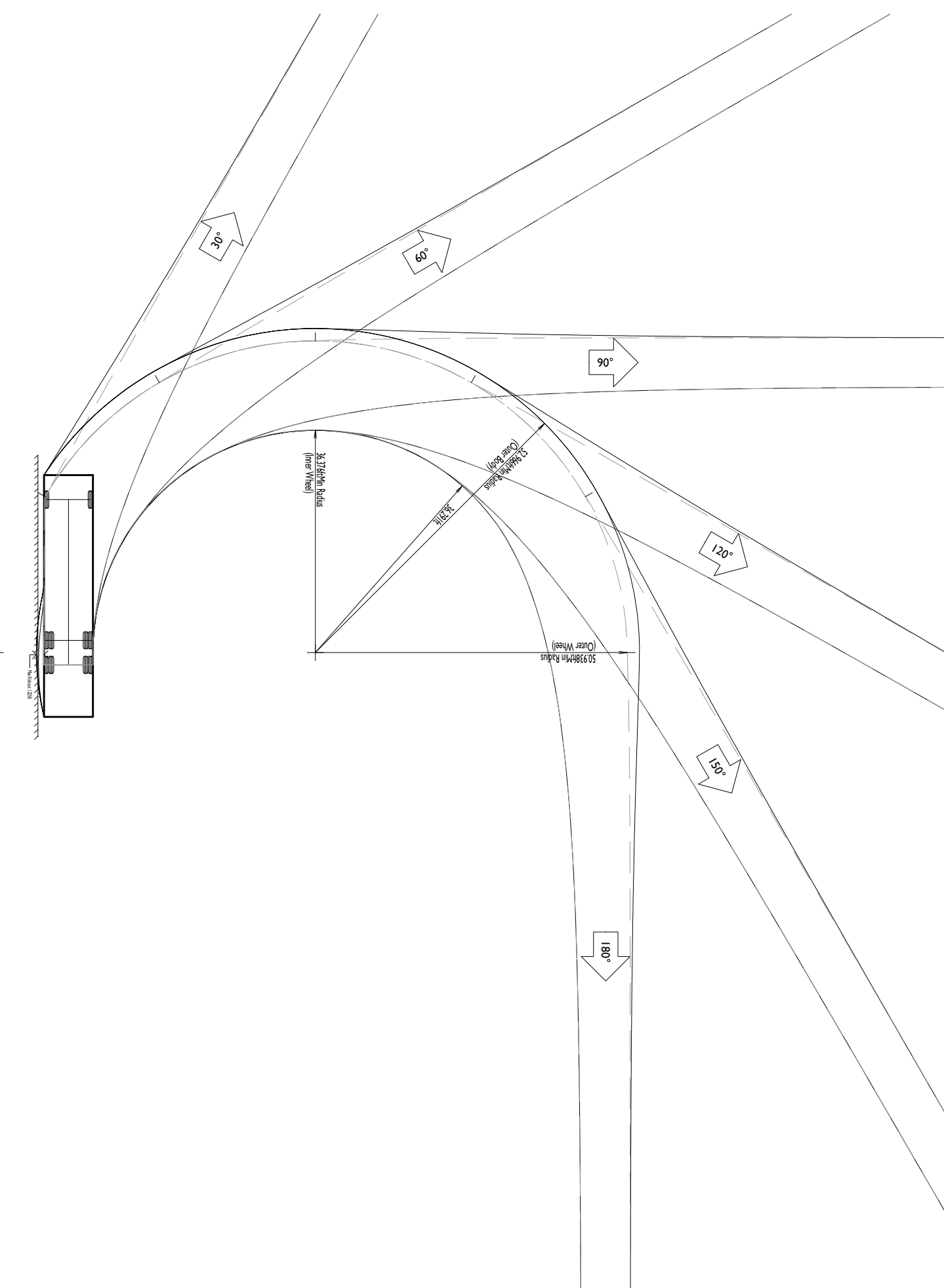
[illegible]

**NOT APPROVED FOR CONSTRUCTION**



Rutherford, NJ • New York, NY • Boston, MA  
Princeton, NJ • Tampa, FL • Detroit, MI  
[www.stonefieldeng.com](http://www.stonefieldeng.com)

**SITE PLAN SET**  
**ALRIG USA DEVELOPMENT, LLC**  
**PROPOSED STARBUCKS WITH**  
**DRIVE-THRU FACILITIES**



BOOK 10890, PG. 215 / BOOK 4320, PG. 247 / BOOK 8163, PG. 289  
MAP 93, LOTS 275, 168, & 169  
0 & 8 MITCHELL STREET & 157 COGGESHALL STREET  
CITY OF NEW BEDFORD  
BRISTOL COUNTY, MASSACHUSETTS

**JAKE MODESTOW, P.E.**  
MASSACHUSETTS LICENSE No. 6201065336  
LICENSED PROFESSIONAL ENGINEER



SCALE:	1" = 20'	PROJECT ID: BOS-200026
--------	----------	------------------------

**TITLE:**

## TRUCK TURN PLAN

**DRAWING:**

**C-16**